

LaBelle Valencia Grove



Acres: 66 +/- acres
(55 acres net grove)

Price: ~~\$825,000~~ **NEW PRICE \$725,000**

Location:

Sears Road and SR 29
LaBelle, Florida; Hendry County

Current Use: Grove on Swingle; 1 unit to 5 acres

Fruit Contract: Fruit contract included - multi-year

Paved Road Frontage: 1,774 +/- ft. on Grove Road 1

Soil Types: Pineda Fine Sand, Oldsmar Sand

Water & Drainage Provided by: Gerber Water Control District

Utilities: Florida Power and Light

Irrigation: Microjet; 8" pump

Directions:

- From City of LaBelle proceed south on SR 29 for 8 miles to Sears Road.
- Turn east on Sears Road and go approximately 3.7 miles to Gerber Water Control District entrance.
- Proceed east about 2 miles. Turn north on Grove Road. Go north to Grove Road One.
- Go west on Grove Road One. Parcel includes beds 2-6 on north side of road.

S.T.R.: 1-30-44

Parcel ID: 1-30-44-04-010-0003-001-0
1-30-44-04-010-0003-001-1



Attractively priced
Good producing grove



SAUNDERS
REAL ESTATE

5120 S. Lakeland Drive, Suite 3
Lakeland, FL 33813

Phone: 863-648-1528 • Toll Free: 1-877-518 LAND

www.saundersrealestate.com

LaBelle Valencia Grove

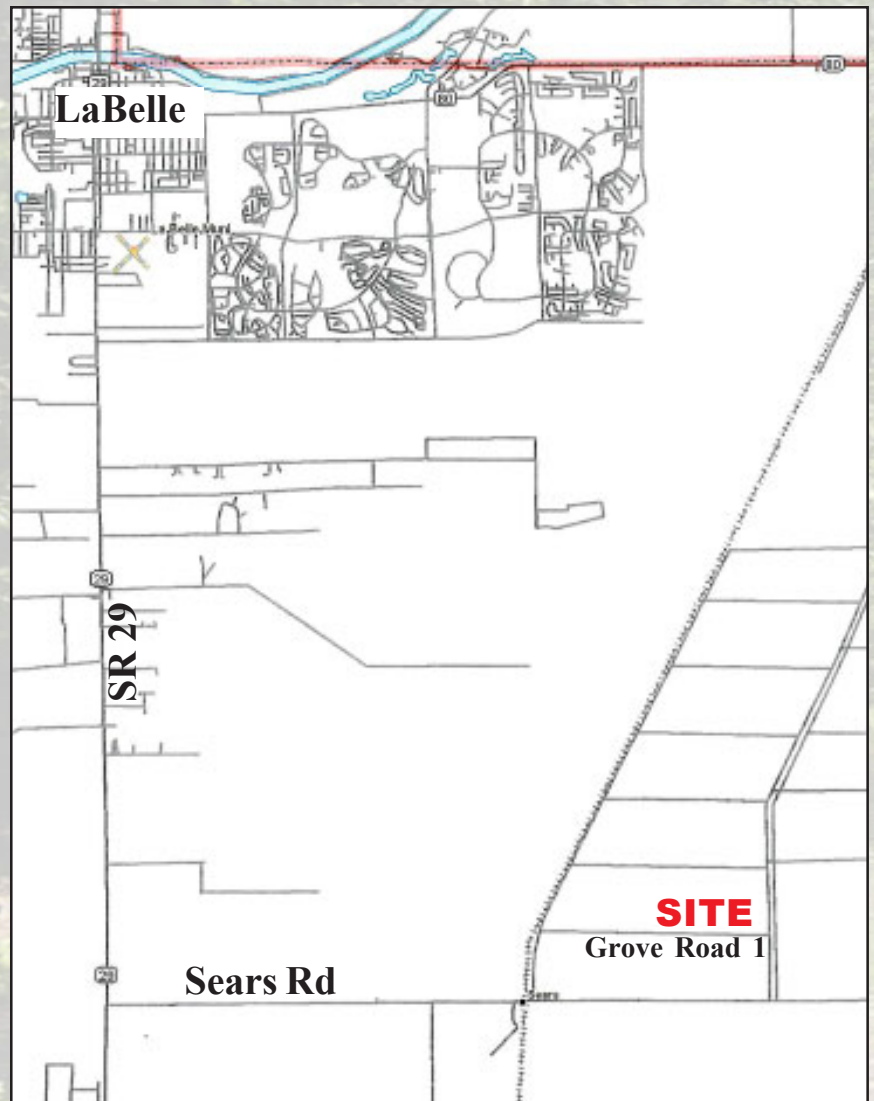

Directions:

- From City of LaBelle proceed south on SR 29 for 8 miles to Sears Road.
- Turn east on Sears Road and go approximately 3.7 miles to Gerber Water Control District entrance.
- Proceed east about 2 miles. Turn north on Grove Road. Go north to Grove Road One.
- Go west on Grove Road One. Parcel includes beds 2-6 on north side of road.

Coldwell Banker Commercial Saunders Real Estate • Ph: 863.648.1528 • www.saundersrealestate.com

While every attempt is made to provide as accurate information on this property offering as possible, COLDWELL BANKER COMMERCIAL SAUNDERS REAL ESTATE (CBCSRE) does not guarantee the accuracy thereof. Buyer shall rely entirely on their own information and inspection of property and records. © Copyright Coldwell Banker Commercial Saunders Real Estate, All Rights Reserved, Worldwide: All content inclusive of text, graphics, images, and logos is the property of CBCSRE. You may not copy this material by any means (including electronic copies), reproduce, duplicate, scan, modify, publish, transfer, use on your own web site, distribute, or create a derivative work without receiving written permission from CBCSRE.

082207A-DH