

Soils Map

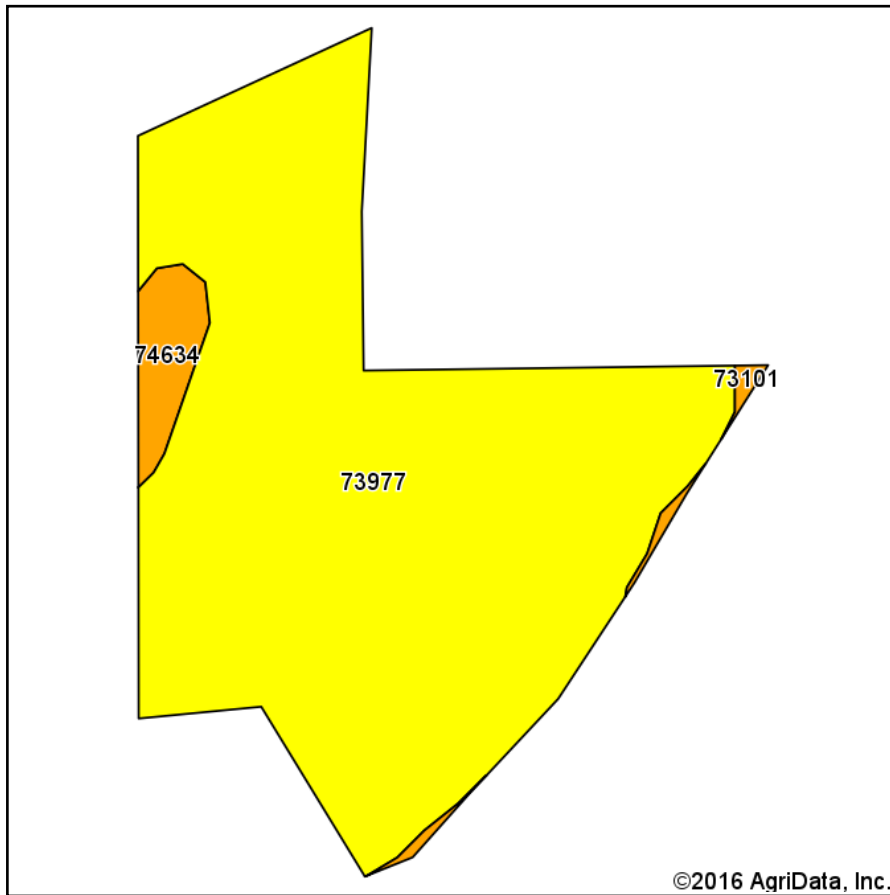

Soils data provided by USDA and NRCS.

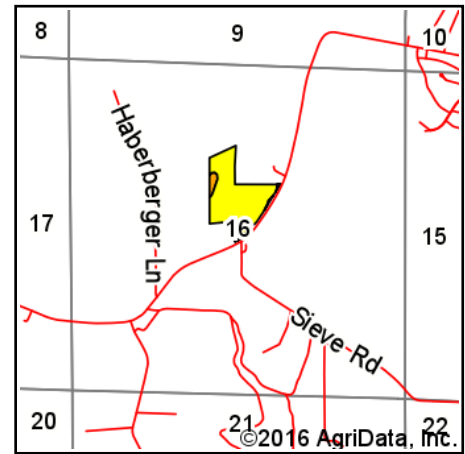

State: **Missouri**
 County: **Franklin**
 Location: **16-43N-1E**
 Township: **Union**
 Acres: **20**
 Date: **5/3/2016**

United
Country
Real Estate

Trophy Properties
and Auction

Maps Provided By:

surety
CUSTOMIZED ONLINE MAPPING

© AgriData, Inc. 2016

www.AgriDataInc.com



Area Symbol: MO071, Soil Area Version: 17

Code	Soil Description	Acres	Percent of field	Non-Irr Class Legend	Soil Drainage	Non-Irr Class *c	Corn	Soybeans	*n NCCPI Overall
73977	Wrengart silt loam, 8 to 15 percent slopes, eroded	19.04	95.2%		Moderately well drained	IVe			34
74634	Hartville silt loam, 3 to 8 percent slopes	0.77	3.8%		Somewhat poorly drained	IIle	9	3	68
73101	Wrengart silt loam, 5 to 9 percent slopes	0.19	1.0%		Moderately well drained	IIle			75
Weighted Average							0.3	0.1	*n 35.7

Area Symbol: MO071, Soil Area Version: 17

*n: NCCPI updated on 1-25-2016

*c: Using Capabilities Class Dominant Condition Aggregation Method

Soils data provided by USDA and NRCS.