

Soils Map

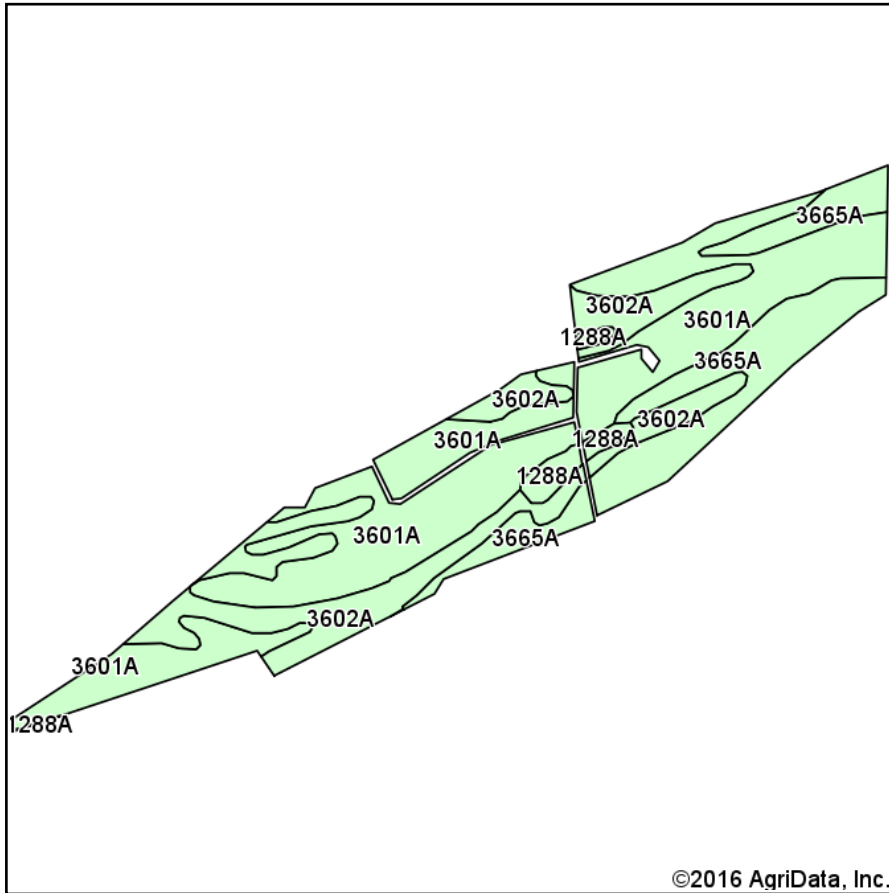

Soils data provided by USDA and NRCS.

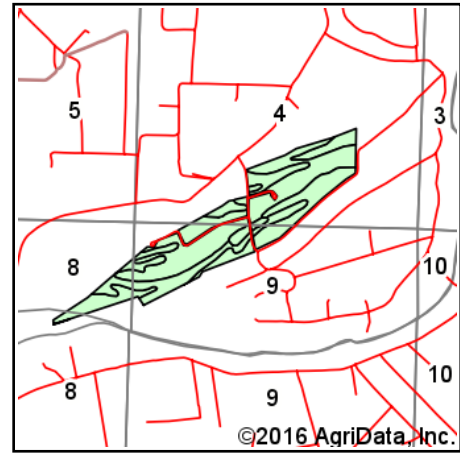

State: **Illinois**
 County: **White**
 Location: **9-5S-14W**
 Township: **Hawthorne**
 Acres: **120.65**
 Date: **7/6/2016**



iAuctionandRealty.com

Maps Provided By:



© AgriData, Inc. 2016

www.AgridataInc.com



Area Symbol: IL193, Soil Area Version: 10

Code	Soil Description	Acres	Percent of field	Il. State Productivity Index Legend	Subsoil rooting ^a	Corn Bu/A	Soybeans Bu/A	Wheat Bu/A	Oats Bu/A ^b	Sorghum ^c Bu/A	Alfalfa ^d hay, T/A	Grass-legume ^e hay, T/A	Crop productivity index for optimum management
3601A	Nolin silty clay loam, 0 to 2 percent slopes, frequently flooded	63.18	52.4%		FAV	159	51	60	0	120	3.89	0.00	116
3602A	Newark silt loam, 0 to 2 percent slopes, frequently flooded	28.55	23.7%		FAV	134	44	58	0	117	0.00	4.77	104
3665A	Stonelick loam, 0 to 2 percent slopes, frequently flooded	25.73	21.3%		FAV	143	44	54	64	0	3.64	0.00	103
1288A	Petrolia silty clay loam, undrained, 0 to 2 percent slopes, frequently flooded	3.19	2.6%		FAV	162	49	61	79	0	0.00	4.89	117
Weighted Average						149.8	47.8	58.3	15.7	90.5	2.81	1.26	110.4

Area Symbol: IL193, Soil Area Version: 10

Table: Optimum Crop Productivity Ratings for Illinois Soil by K.R. Olson and J.M. Lang, Office of Research, ACES, University of Illinois at Champaign-Urbana. Version: 1/2/2012 Amended Table S2 B811

Crop yields and productivity indices for optimum management (B811) are maintained at the following NRES web site:

<https://www.ideals.illinois.edu/handle/2142/1027/>

** Indexes adjusted for slope and erosion according to Bulletin 811 Table S3

a UNF = unfavorable; FAV = favorable

b Soils in the southern region were not rated for oats and are shown with a zero "0".

c Soils in the northern region or in both regions were not rated for grain sorghum and are shown with a zero "0".

d Soils in the poorly drained group were not rated for alfalfa and are shown with a zero "0".

e Soils in the well drained group were not rated for grass-legume and are shown with a zero "0".

Soils data provided by USDA and NRCS. Soils data provided by University of Illinois at Champaign-Urbana.

*c: Using Capabilities Class Dominant Condition Aggregation Method