

C4037



LOCATION: From Kanorado, KS take Hwy 24 West for 2.5 miles to CR 5. The subject property will be on the South side of the road. **Signs will be posted.**

LEGALS: Township 8S, Range 42W, Section 27: NE

FSA INFORMATION: 140.8 CRP Acres

Expiration: 9/30/2018	Acres Enrolled: 140.8
Rate/Acre: \$29.82	Ann. Payment: \$4,199.00

Note: Mid-Contract Management has been completed.

CRP PAYMENT: 2017 CRP payment will be prorated to the date of closing and all future payments convey to Buyer.

MINERALS: The Seller will retain 100% of the mineral rights on the subject property.

POSSESSION: At closing

TAXES: Seller will pay taxes for all of 2016 and prior years. Taxes for 2017 will be prorated to the date of closing.

PRICE: \$91,520.00
2016 Taxes: \$409.71



Colorado Land Investments I, LLC

**Cary Schlosser - Listing Broker - 719-346-8661 (Office)
or 719-349-0478 (Cell Phone)**

**Larry J. Hostetler - Managing Broker - 719-346-8661 (Office)
or 719-342-8661 (Cell Phone)**

www.cololand.com

Driven by Integrity, Guided by Experience

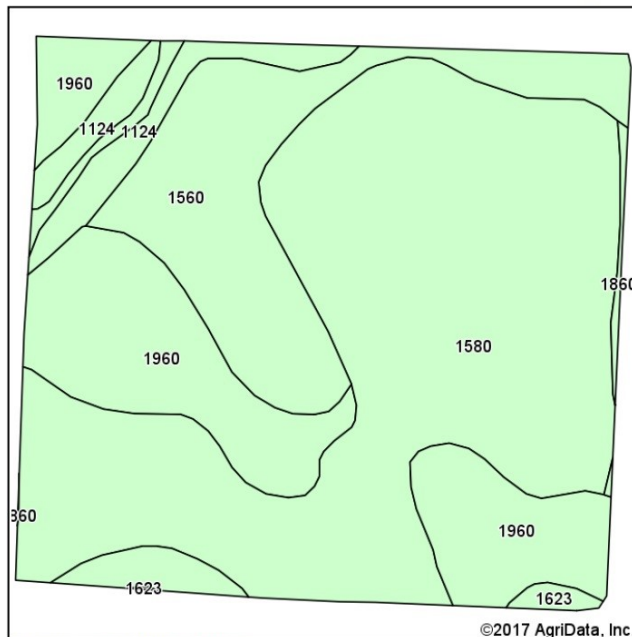

Soils data provided by USDA and NRCS.

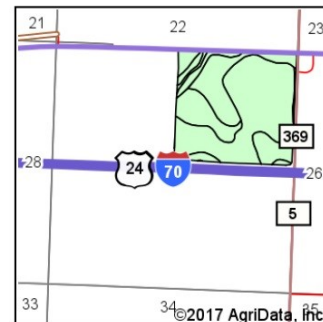

State: **Kansas**
 County: **Sherman**
 Location: **27-8S-42W**
 Township: **Stateline**
 Acres: **142.02**
 Date: **5/23/2017**

Maps Provided By
surety
 CUSTOMIZED ONLINE MAPPING
 © AgriData, Inc. 2017 www.AgriDataInc.com



Area Symbol: KS181, Soil Area Version: 12

Code	Soil Description	Acres	Percent of field	Non-Irr Class *c	Irr Class *c	Alfalfa hay	Corn	Grain sorghum	Smooth brome	Winter wheat
1580	Colby silt loam, 6 to 15 percent slopes	76.29	53.7%	Vle						
1960	Buffalo Park silt loam, 3 to 6 percent slopes	32.18	22.7%	IVe	IVe			6		5
1560	Bridgeport silt loam, 2 to 5 percent slopes	24.09	17.0%	IIle	IIle			47	4	30
1124	Bridgeport silt loam, channeled	7.94	5.6%	Vw		4	59	64		30
1623	Keith silt loam, 1 to 3 percent slopes, south	0.81	0.6%	Ile	Ile					
1860	Ulysses silt loam, 6 to 15 percent slopes	0.71	0.5%	Vle	Vlle			10		20
Weighted Average						0.2	3.3	13	0.7	8

Specializing in Farm and Ranch Sales Throughout CO, KS, MT, NE, OK

NOTICE TO PERSPECTIVE PURCHASERS: The owner has either given the information contained herein to us or obtained from sources we deem reliable. We have no reason to doubt its accuracy, however, we do not guarantee it. Colorado Land Investments I, LLC, and the seller assume no responsibility for the omissions, corrections, withdrawals, or prior sales. The prospective purchaser should verify all information contained herein. Colorado Land Investments I, LLC, and all other agents of the broker are or will be acting in the capacity of a Transaction Broker in the Sale of subject property.