

# Soils Map

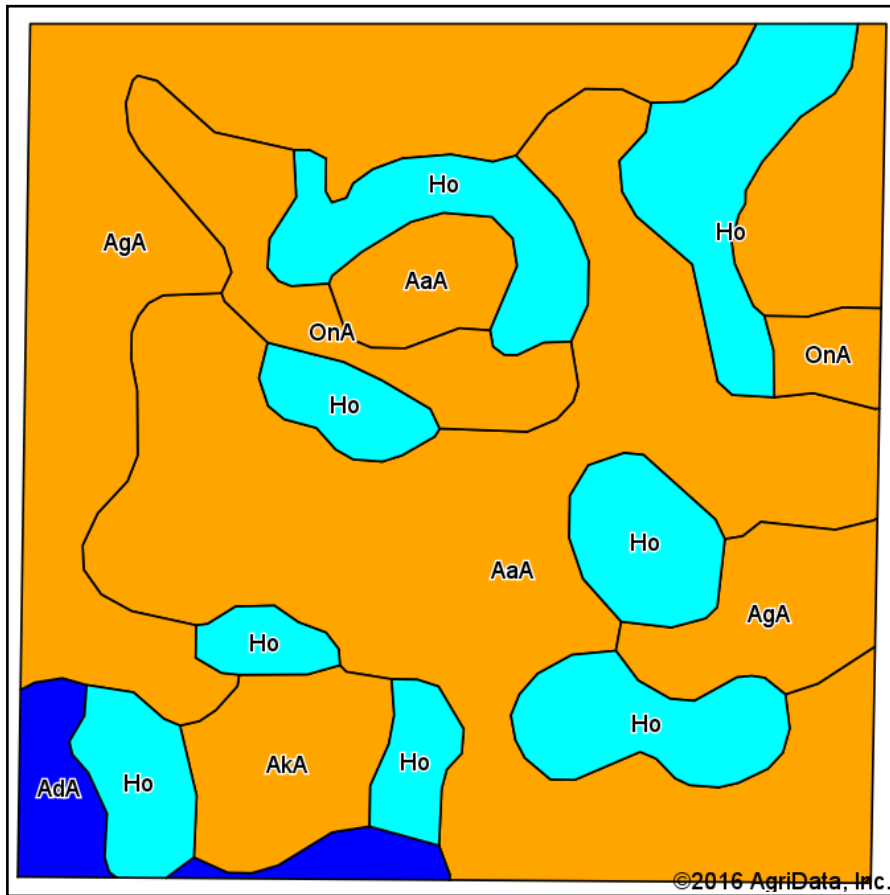

Soils data provided by USDA and NRCS.

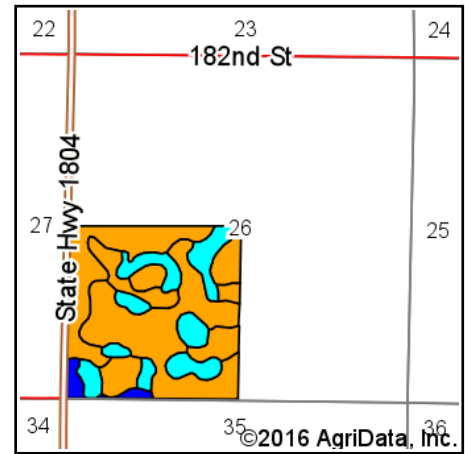

State: **South Dakota**  
 County: **Sully**  
 Location: **26-115N-79W**  
 Township: **West Sully**  
 Acres: **160**  
 Date: **1/3/2017**



Maps Provided By:



© AgriData, Inc. 2016

www.AgriDataInc.com



## Area Symbol: SD119, Soil Area Version: 19

Code	Soil Description	Acres	Percent of field	PI Legend	Non-Irr Class *c	Productivity Index	NCCPI Overall
AaA	Agar silt loam, 0 to 2 percent slopes	57.41	35.9%		IIc	92	39
AgA	Agar-Onita silt loams, 0 to 1 percent slopes	45.29	28.3%		IIc	94	40
Ho	Hoven silt loam, 0 to 1 percent slopes	34.68	21.7%		VIIs	15	2
OnA	Mobridge silt loam, 0 to 2 percent slopes	10.65	6.7%		IIc	94	43
AkA	Agar-Walke silt loams, 0 to 2 percent slopes	7.12	4.4%		IIc	85	35
AdA	Agar-DeGrey silt loams, 0 to 2 percent slopes	4.85	3.0%		IIc	71	33
Weighted Average						75.1	31.2

Area Symbol: SD119, Soil Area Version: 19

\*c: Using Capabilities Class Dominant Condition Aggregation Method

Soils data provided by USDA and NRCS.