

# Soils Map

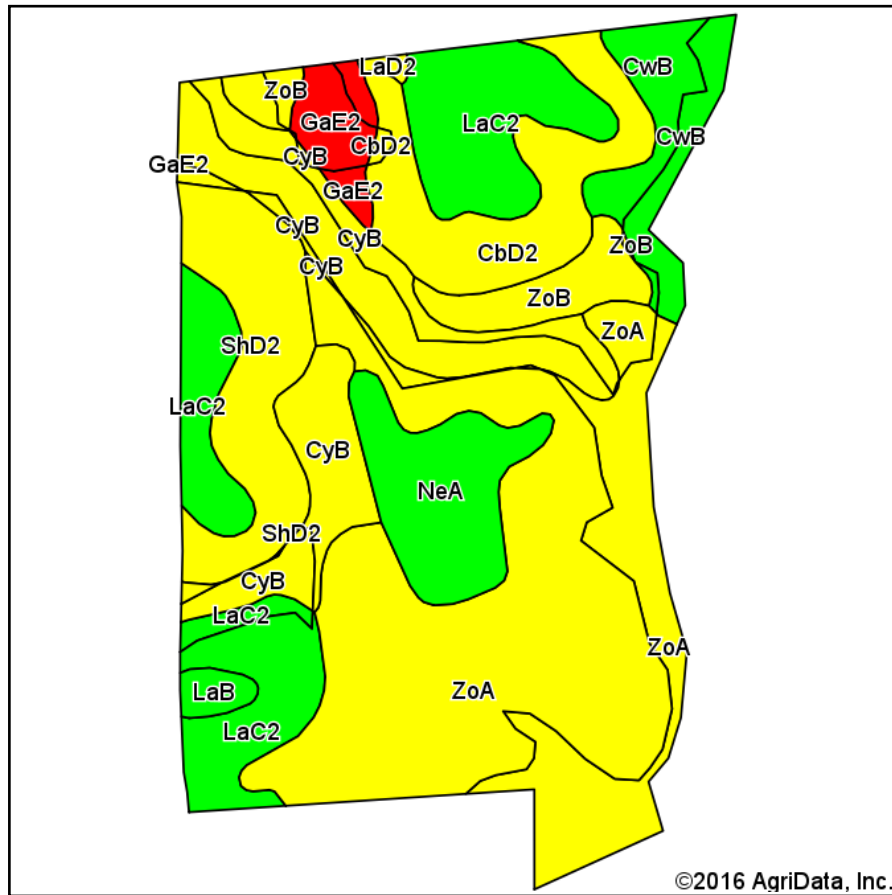

Soils data provided by USDA and NRCS.

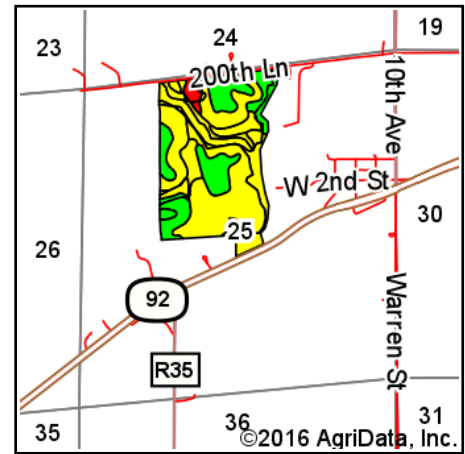

State: **Iowa**  
 County: **Madison**  
 Location: **25-76N-26W**  
 Township: **Crawford**  
 Acres: **109.06**  
 Date: **10/19/2016**



## Area Symbol: IA121, Soil Area Version: 19

Code	Soil Description	Acres	Percent of field	CSR2 Legend	Non-Irr Class *c	CSR2**	CSR
ZoA	Zook silty clay loam, 0 to 2 percent slopes	38.64	35.4%		IIw	65	70
LaC2	Ladoga silt loam, 5 to 9 percent slopes, moderately eroded	16.49	15.1%		IIIe	78	62
CyB	Colo-Ely silty clay loams, gullied, 2 to 5 percent slopes	14.51	13.3%		Vw	57	10
ShD2	Shelby loam, 9 to 14 percent slopes, moderately eroded	9.49	8.7%		IIIe	52	48
CbD2	Caleb loam, 9 to 14 percent slopes, moderately eroded	9.04	8.3%		IVe	52	33
NeA	Nevin silty clay loam, 0 to 2 percent slopes	7.17	6.6%		Iw	94	90
CwB	Colo-Ely silty clay loams, 2 to 5 percent slopes	5.61	5.1%		IIw	77	65
ZoB	Zook silty clay loam, 2 to 5 percent slopes	4.29	3.9%		IIw	70	65
GaE2	Gara loam, 14 to 18 percent slopes, moderately eroded	2.67	2.4%		VIe	35	33
LaB	Ladoga silt loam, 2 to 5 percent slopes	0.89	0.8%		Ile	86	82
LaD2	Ladoga silt loam, 9 to 14 percent slopes, moderately eroded	0.26	0.2%		IIIe	52	52
Weighted Average						65.8	55.8

Area Symbol: IA121, Soil Area Version: 19

\*\*IA has updated the CSR values for each county to CSR2.

\*c: Using Capabilities Class Dominant Condition Aggregation Method

Soils data provided by USDA and NRCS.