

# Soils Map

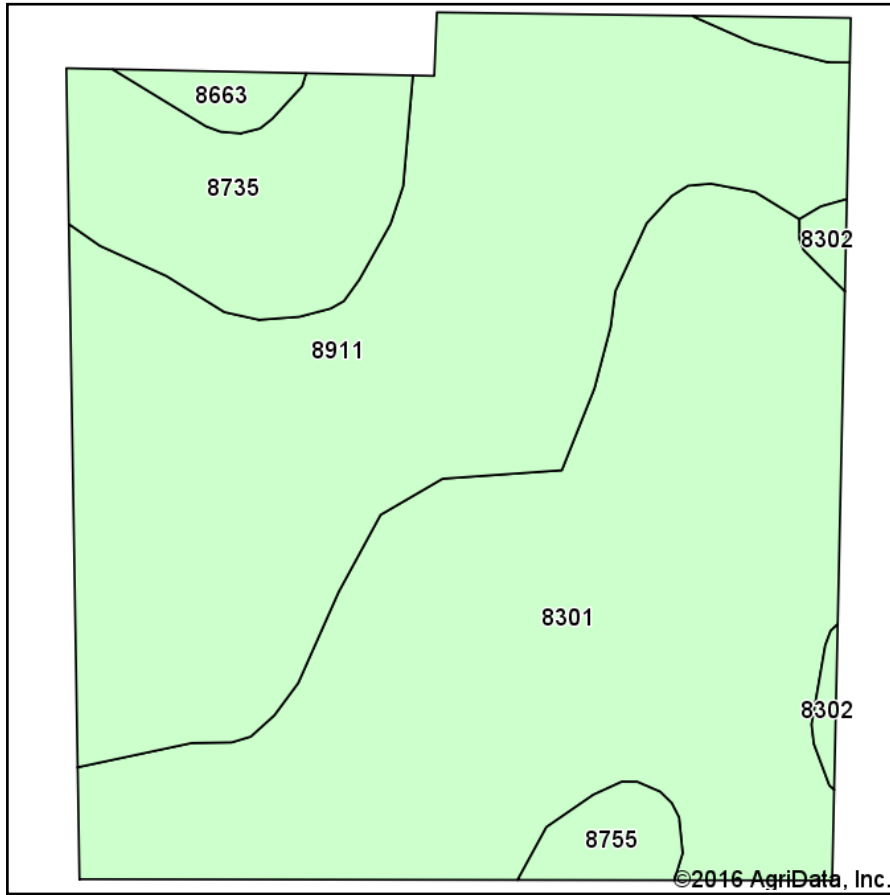

Soils data provided by USDA and NRCS.

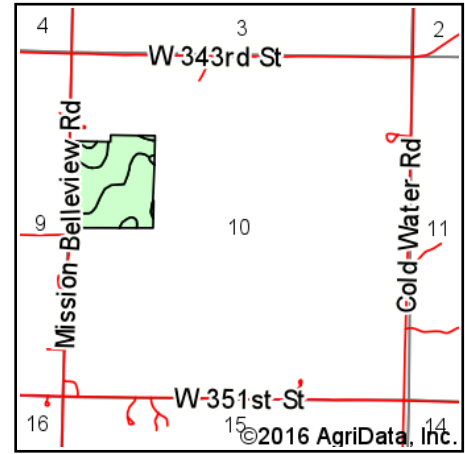

State: **Kansas**  
 County: **Miami**  
 Location: **10-18S-25E**  
 Township: **Sugar Creek**  
 Acres: **40**  
 Date: **10/12/2016**



Maps Provided By:



© AgriData, Inc. 2016

www.AgriDataInc.com



## Area Symbol: KS121, Soil Area Version: 16

Code	Soil Description	Acres	Percent of field	Non-Irr Class *c	Range Production (lbs/acre/yr)	Improved bermudagrass	Tall fescue	Wheat	Alfalfa hay	Grain sorghum	Soybeans	Smooth bromegrass
8301	Verdigris silt loam, 0 to 1 percent slopes, frequently flooded	17.72	44.3%	Vw	8048							
8911	Summit silty clay loam, 1 to 3 percent slopes	16.53	41.3%	Ile	4828							
8735	Eram silty clay loam, 3 to 7 percent slopes	4.23	10.6%	IVe	4328	5	4					
8755	Eram-Lebo silty clay loams, 5 to 20 percent slopes	0.73	1.8%	VIe	4550	4	4	12	2	22	12	1
8663	Clareson-Rock outcrop complex, 3 to 15 percent slopes	0.45	1.1%	VIe	3398							
8302	Verdigris silt loam, 0 to 1 percent slopes, occasionally flooded	0.34	0.8%	IIw	7758							
<b>Weighted Average</b>					<b>6205.3</b>	<b>0.6</b>	<b>0.5</b>	<b>0.2</b>	<b>*-</b>	<b>0.4</b>	<b>0.2</b>	<b>*-</b>

Area Symbol: KS121, Soil Area Version: 16

\*c: Using Capabilities Class Dominant Condition Aggregation Method

Soils data provided by USDA and NRCS.