

THE SIDEWALK PAVERS IN AREA "A" & "B" MUST BE DISCED AND SMOOTHED BEFORE INSTALLATION. THIS TASK MUST BE ACCOMPLISHED UNDER THE DIRECT SUPERVISION OF THE MCDSM.

THE GARDEN AREA IN AREA "A" & "B" MUST BE DISCED AND SMOOTHED BEFORE INSTALLATION. THIS TASK MUST BE ACCOMPLISHED UNDER THE DIRECT SUPERVISION OF THE MCDSM.

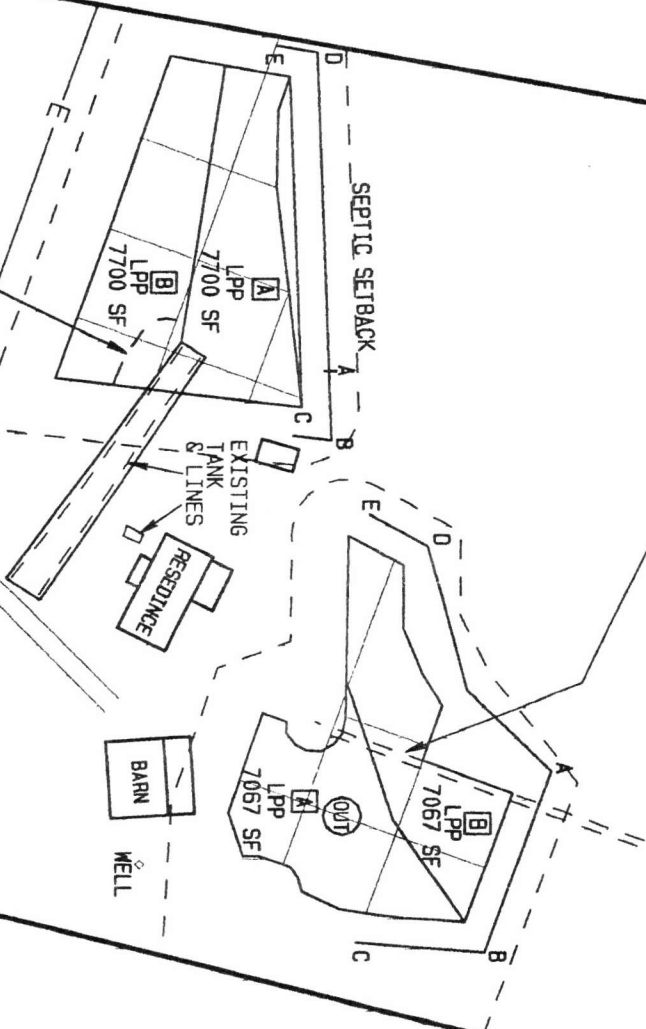

1) THE PURPOSE OF THIS PLAT IS TO EXCEPT FOR THE SEPTIC SETBACKS AS DETERMINED BY THE WILLIAMSON COUN

I HEREBY CERTIFY THAT THE SEPTIC, STAKED AT A PRECISION EXCEEDING 1:

J. MARK CANTRELL TN RLS# 1859

SULPHUR SPRINGS RD

ARROWHEAD SURVEY  
4119 OLD HILLSBORO RD