

Soils Map

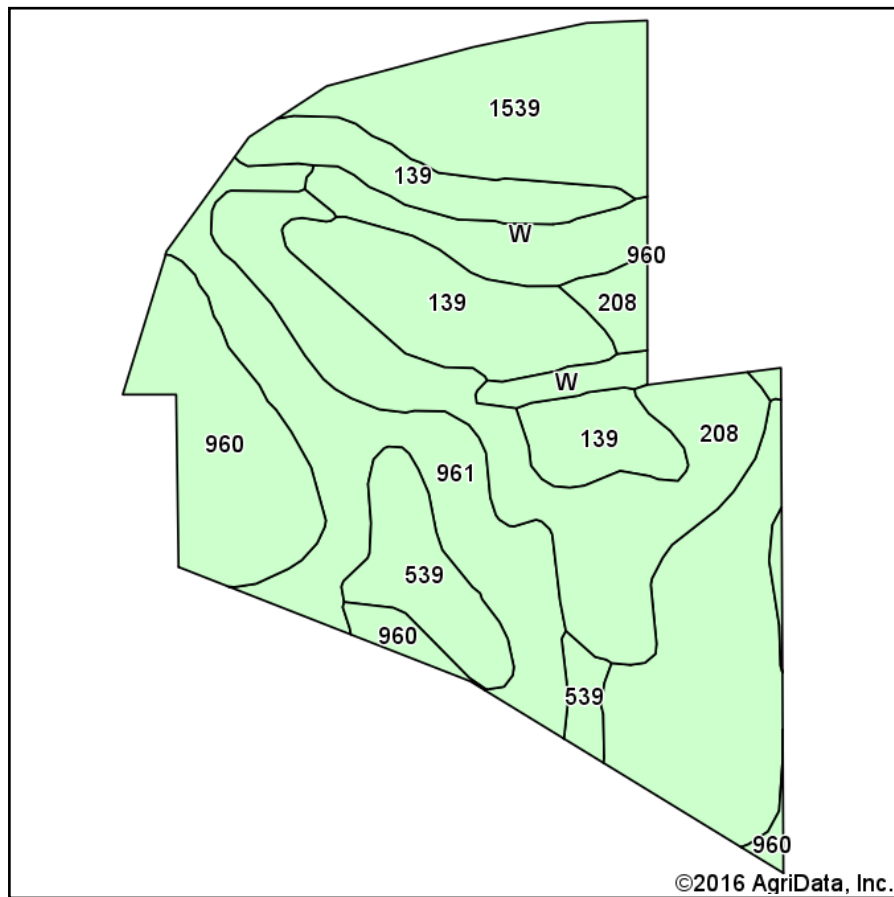

Soils data provided by USDA and NRCS.

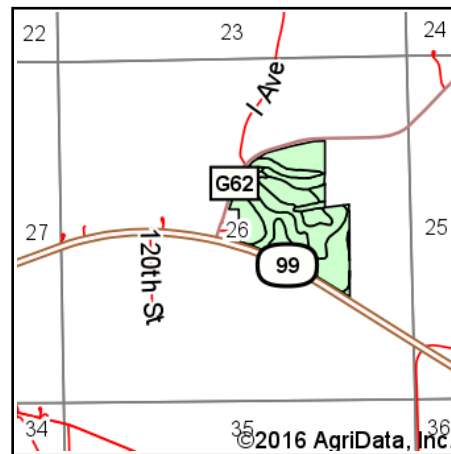

State: **Iowa**
 County: **Louisia**
 Location: **26-74N-3W**
 Township: **Wapello**
 Acres: **61.35**
 Date: **7/8/2016**



Maps Provided By:

 © AgriData, Inc. 2016 www.AgriDataInc.com



Area Symbol: IA115, Soil Area Version: 19

Code	Soil Description	Acres	Percent of field	Water Table	Restrictive Layer	Non-Irr Class *c	CSR2**	CSR
961	Ambraw loam, 0 to 2 percent slopes	17.76	28.9%	0ft.	> 6.5ft.	IIw	73	70
208	Klum fine sandy loam, 0 to 2 percent slopes	11.28	18.4%	4ft.	> 6.5ft.	IIIw	57	55
139	Perks loamy sand, 0 to 3 percent slopes	10.12	16.5%	> 6.5ft.	> 6.5ft.	IVs	11	15
960	Shaffton loam, 0 to 2 percent slopes	7.31	11.9%	1ft.	> 6.5ft.	IIw	58	78
1539	Coland-Perks-Lawson complex, frequently flooded, 0 to 2 percent slopes	7.10	11.6%	0ft.	> 6.5ft.	Vw	5	25
W	Water	3.90	6.4%	> 6.5ft.	> 6.5ft.		0	0
539	Perks sandy loam, 0 to 3 percent slopes	3.88	6.3%	> 6.5ft.	> 6.5ft.	IIIs	7	30
Weighted Average							41.4	46.9

Area Symbol: IA115, Soil Area Version: 19

**IA has updated the CSR values for each county to CSR2.

*c: Using Capabilities Class Dominant Condition Aggregation Method

Soils data provided by USDA and NRCS.