

# Soils Map-CSR2

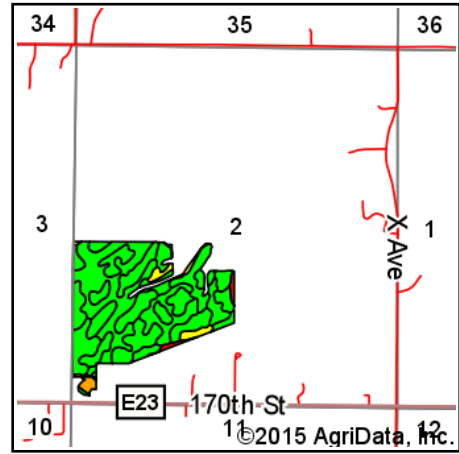

State: **Iowa**  
 County: **Boone**  
 Location: **2-84N-25W**  
 Township: **Jackson**  
 Acres: **99.06**  
 Date: **1/21/2016**

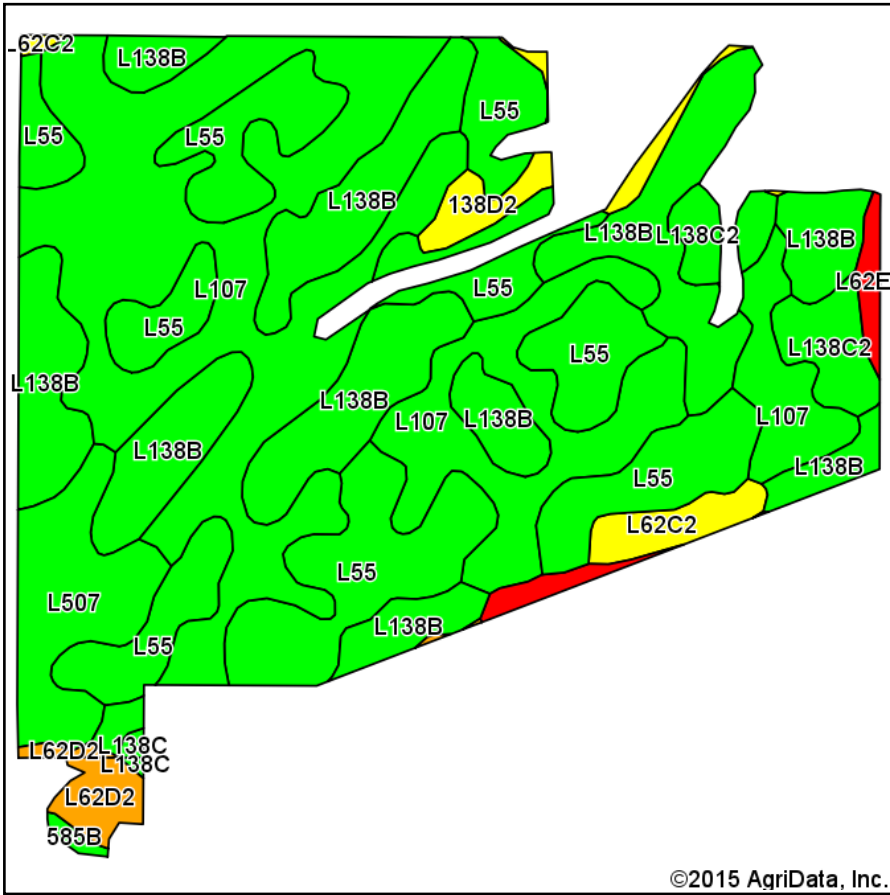

Soils data provided by USDA and NRCS.

©2015 AgriData, Inc.

## Area Symbol: IA015, Soil Area Version: 21

Code	Soil Description	Acres	Percent of field	CSR2 Legend	Non-Irr Class *c	CSR2**	CSR
L107	Webster clay loam, Bemis moraine, 0 to 2 percent slopes	34.08	34.4%		IIw	88	
L138B	Clarion loam, Bemis moraine, 2 to 6 percent slopes	25.47	25.7%		IIe	88	
L55	Nicollet loam, 1 to 3 percent slopes	24.29	24.5%		Ie	91	
L507	Canisteo clay loam, Bemis moraine, 0 to 2 percent slopes	5.32	5.4%		IIw	87	
L138C2	Clarion loam, Bemis moraine, 6 to 10 percent slopes, moderately eroded	3.29	3.3%		IIIe	83	
138D2	Clarion loam, 9 to 14 percent slopes, moderately eroded	1.75	1.8%		IIIe	56	56
L62C2	Storden loam, Bemis moraine, 6 to 10 percent slopes, moderately eroded	1.69	1.7%		IIIe	64	
L62D2	Storden loam, Bemis moraine, 10 to 16 percent slopes, moderately eroded	1.48	1.5%		IVe	41	
L62E2	Storden loam, Bemis moraine, 10 to 22 percent slopes, moderately eroded	1.29	1.3%		IVe	32	
585B	Coland-Spillville complex, 2 to 5 percent slopes	0.23	0.2%		IIw	71	70
L138C	Clarion loam, Bemis moraine, 6 to 10 percent slopes	0.17	0.2%		IIIe	84	
<b>Weighted Average</b>						<b>86.1</b>	<b>*-</b>

Area Symbol: IA015, Soil Area Version: 21

\*\*IA has updated the CSR values for each county to CSR2.

\*- CSR weighted average cannot be calculated on the current soils data, use prior data version for csr values.

\*c: Using Capabilities Class Dominant Condition Aggregation Method

Soils data provided by USDA and NRCS.