

Colorado Division of Water Resources

Colorado's Well Permit Search

THIS PAGE IS NOT THE ACTUAL PERMIT

The information contained on this page is a summary of the permit file and may not reflect all details of the well permit. ([Full Disclaimer](#))

Well Constructed

[Help](#) Last Refresh: 4/26/2016 12:01:29 AM

Receipt: 9077606 **Division:** 2
Permit #: 122454- **Water District:** 12
Well Name / #: **County:** CUSTER
Designated Basin: **Management District:**
Case Number:
WDID:

[-] Imaged Documents - Permit File

Document Name	Date Imaged	Annotated
Original File	12/05/2007	No

[-] Applicant/Contact

Applicant/Contact Name	Mailing Address	City/State/Zip
BARR HUGH	ILSE ROUTE	CANON CITY, CO 81212

[-] Location Information

Approved Well Location:

Q40	Q160	Section	Township	Range	PM	Footage from Section Lines
SW	SE	25	21.0S	71.0W	Sixth	950 S 2000 E

Northing (UTM y): 4226834.9 **Easting (UTM x):** 476215.8

Location Accuracy: Spotted from section lines

Subdivision Name

Filing Block Lot

Parcel ID:

Acres in Tract:

[-] Permit Details

Date Issued: **Date Expires:**

Uses (See [Imaged Documents](#) for more information)

General Use(s): DOMESTIC
STOCK

Aquifer(s): ALL UNNAMED AQUIFERS

Special Use:

Area which may be irrigated: 10 acres

Annual volume of appropriation:

Statute:

Cross Reference Permit(s): Permit Number Receipt

Comments:

[-] Construction/Usage Details

Well Construction Date: **Pump Installation Date:**
Well Plugged: **1st Beneficial Use:** 09/10/1984

Elevation	Depth	Perforated Casing (Top)	Perforated Casing (Bottom)	Static Water Level	Pump Rate
	115			30	15

[-] Application/Permit History

First Beneficial Use 09/10/1984

Disclaimer

***The information contained on this page is a summary of the permit file and may not reflect all details of the well permit. THIS PAGE IS NOT THE ACTUAL PERMIT.**

This page should not be used as a basis for any legal consideration, to determine the allowed uses of the well, to determine construction information, or to determine the terms and conditions under which the well can operate. The complete well permit file should be viewed to obtain details on the allowed uses and other relevant information. A complete copy of this file is available in the "Imaged Documents" section of this page, and can be viewed by opening all of the documents listed under that section (documents will open as pdf files).

Note that all of the terms and conditions under which a well can operate, particularly for non-exempt wells, may not be specified on the well permit. Wells may also be subject to relevant statutes, rules and decrees. To learn more about well permitting in Colorado, please visit [DWR's Well Permitting Page](#). If you have any questions about this well permit file, please contact the [DWR Ground Water Information Desk](#).

Copyright © 2016 Colorado Division of Water Resources. All rights reserved.

[Home](#) | [Contact Us](#) | [Help](#) | [Water Links](#) | [Colorado.gov](#) | [DNR](#) | [Privacy Policy](#) | [Transparency Online Project \(TOP\)](#)

COLORADO DIVISION OF WATER RESOURCES

818 Centennial Bldg., 1313 Sherman St.

Denver, Colorado 80203

RECEIVED

DEC 12 1984

TYPE OR
PRINT IN BLACK INK
COPY OF ACCEPTED
STATEMENT MAILED
ON REQUEST

STATE OF COLORADO

COUNTY OF CUSTER

SS.

WATER RESOURCES
STATE - ENGINEER
AFFIDAVIT COLO.

X STATEMENT OF BENEFICIAL USE OF GROUND WATER
____ AMENDMENT OF EXISTING RECORD
____ LATE REGISTRATION

PERMIT NUMBER 122454

LOCATION OF WELL

THE AFFIANT(S) Hugh BARR County CUSTER
whose mailing
address is ILSE ROUTE, CANON CITY CO 81212 SW 1/4 of the SE 1/4, Section 25
City CANON CITY CO 81212 Twp. 21 S Rng. 71 W 6 P.M.
(STATE) (TWP) (N OR S) (E OR W)

being duly sworn upon oath, deposes and says that he (they) is (are) the owner(s) of the well described hereon; the well is
located as described above, at distances of 950 feet from the SOUTH section line and 2000 feet from the
EAST section line; water from this well was first applied to a beneficial use for the purpose(s) described herein on the 10
(EAST OR WEST)

day of SEPT., 1984; the maximum sustained pumping rate of the well is 15 gallons per minute, the pumping
rate claimed hereby is 15 gallons per minute; the total depth of the well is 115 feet; the average annual amount

of water to be diverted is 1 acre-feet; for which claim is hereby made for DOMESTIC USE, AND
WATERING OF LIVESTOCK
IRRIGATION OF ONE ACRE purpose(s); the legal description of the land on which the water from this well is used is

SW 1/4 SE 1/4, SEC. 25, T. 21 S, R. 71 W, 6 P.M. - LOT #3 PETERSON RANCH of which
1 acres are irrigated and which is illustrated on the map on the reverse side of this form; that this well was completed in
compliance with the permit approved therefor; this statement of beneficial use of ground water is filed in compliance with law; he
(they) has (have) read the statements made hereon; knows the content thereof; and that the same are true of his (their) knowledge.

(COMPLETE REVERSE SIDE OF THIS FORM)

Signature(s) Hugh E. Barr
Subscribed and sworn
to before me on this 8 day of December, 1984
My Commission expires: June 10, 1987
USAT L McQuinn
NOTARY PUBLIC

ACCEPTED FOR FILING BY THE STATE ENGINEER OF COLORADO
PURSUANT TO THE FOLLOWING CONDITIONS:

THAT THOSE CONDITIONS OF APPROVAL AS STATED ON THE
PERMIT ARE COMPLIED WITH.

FOR OFFICE USE ONLY

Court Case No. _____
Prior. _____ Mo. _____ Day _____ Yr. _____
Div. 2 City. 14
Sec. _____ 1/4. _____ 1/4. _____ 1/4.
Well Use 3
Dist. 12 Basin _____ Man. Dis. _____

JAN 31 1985

Robert A. Longenbaugh
STATE ENGINEER
Assistant

RA Barr
BY

Well drilled by ALPINE DRILLING SERVICE Lic. No. 746

Permanent
Pump installed by NEQUETTE DRILLING CO. Lic. No. 1043

Meter Serial No. _____ ☒ Flow Meter Date Installed (Pump) SEPT. 8, 1984

Owner of land on which
water is being used HUGH C. BARR AND GERALDINE L. BARR

THE LOCATION OF THE WELL MUST BE SHOWN AND FOR LARGE CAPACITY IRRIGATION WELLS THE AREA ON WHICH THE WATER IS USED MUST BE SHADED OR CROSS-HATCHED ON THE DIAGRAM BELOW.

This diagram represents nine (9) sections. Use the **CENTER SQUARE** (one section) to indicate the location of the well, if possible.

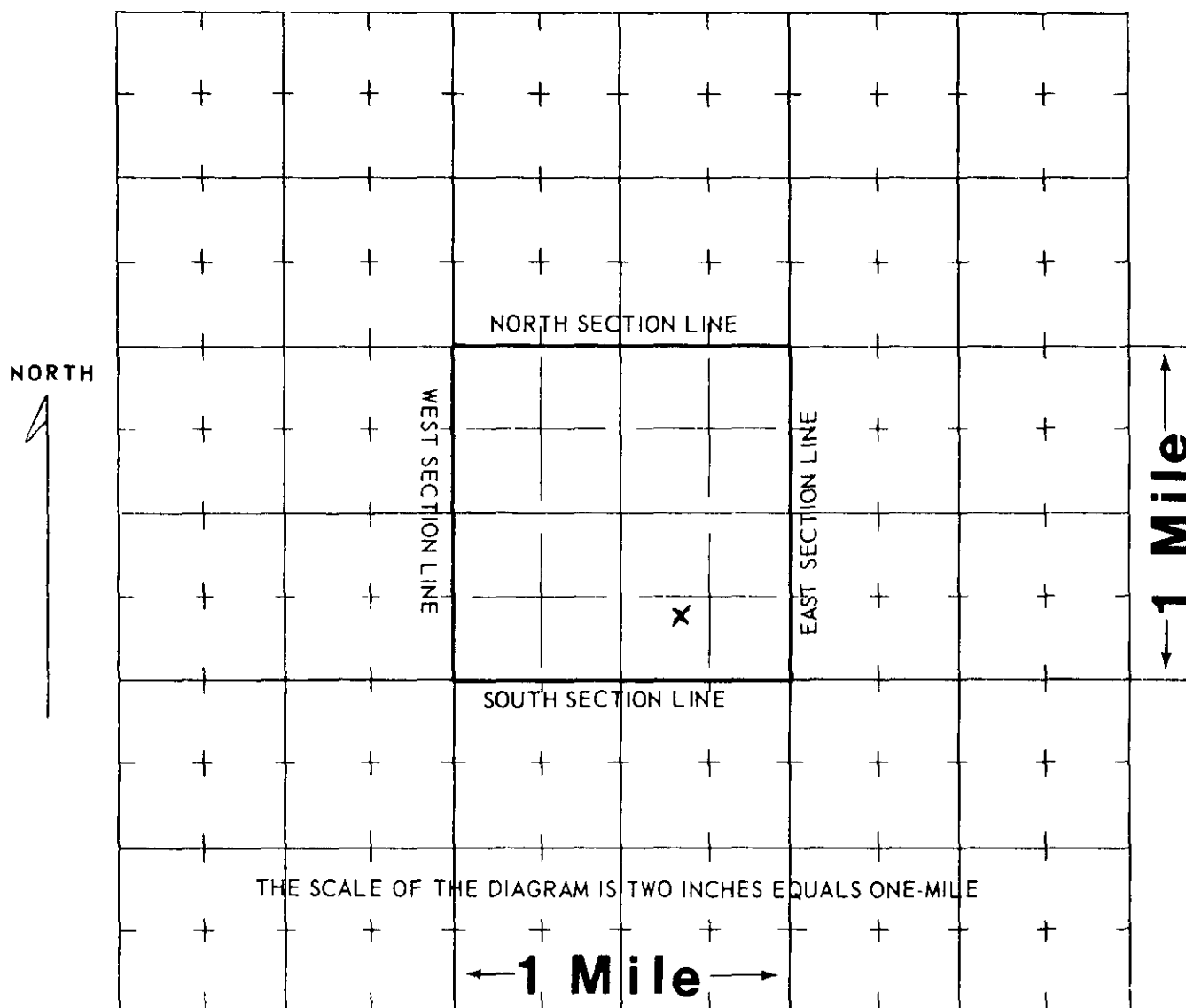

WATER EQUIVALENTS TABLE (Rounded Figures)

An acre-foot covers 1 acre of land 1 foot deep.

1 cubic foot per second (cfs) . . . 449 gallons per minute (gpm).

1 acre-foot . . . 43,560 cubic feet . . . 325,900 gallons.

1,000 gpm pumped continuously for one day produces 4.42 acre-feet.

100 gpm pumped continuously for one year produces 160 acre-feet.

(WHITE AND PINK COPY TO BE FILED WITH THE STATE ENGINEER
PINK COPY WILL BE RETURNED TO OWNER)

COLORADO DIVISION OF WATER RESOURCES

1313 Sherman Street - Room 818
Denver, Colorado 80203

WELL COMPLETION AND PUMP INSTALLATION REPORT

PERMIT NUMBER 122454

RECEIVED
NOV 24 '81
WATER RESOURCES
DIVISION
COLORADO

THIS FORM MUST BE SUBMITTED
WITHIN 60 DAYS OF COMPLETION
OF THE WORK DESCRIBED HERE-
ON. TYPE OR PRINT IN BLACK
INK.

WELL OWNER Hugh Barr

SW 25 % of the SE 25 % of Sec.

ADDRESS Ilse Route Canon City Colo 81212

T. 21 S. 71 W. 6 P.M.

DATE COMPLETED 10-15-81, 19

HOLE DIAMETER

7 7/8 in. from 0 to 20 ft.

6 in. from 20 to 115 ft.

 in. from to ft.

DRILLING METHOD air percussion

CASING RECORD: Plain Casing

Size 6 5/8 & kind steel from 0 to 20 ft.

Size 4 & kind plastic from 5 to 65 ft.

Size & kind from to ft.

Perforated Casing

Size 4 & kind plastic from 65 to 115 ft.

Size & kind from to ft.

Size & kind from to ft.

GROUTING RECORD

Material cement

Intervals 0-20

Placement Method poured

GRAVEL PACK: Size

Interval

TEST DATA

Date Tested 10-15-81, 19

Static Water Level Prior to Test 30 ft.

Type of Test Pump air

Length of Test 1 hour

Sustained Yield (Metered) 15 GPM

Final Pumping Water Level NA

WELL LOG

From	To	Type and Color of Material	Water Loc.
0	7	Topsoil	
7	50	pink Granite	
50	115	gray Granite	58 103
TOTAL DEPTH <u>115'</u>			

Use additional pages necessary to complete log.

PUMP INSTALLATION REPORT

Pump Make _____
 Type _____
 Powered by _____ HP _____
 Pump Serial No. _____
 Motor Serial No. _____
 Date Installed _____
 Pump Intake Depth _____
 Remarks _____

WELL TEST DATA WITH PERMANENT PUMP

Date Tested _____
 Static Water Level Prior to Test _____
 Length of Test _____ Hours
 Sustained yield (Metered) _____ GPM
 Pumping Water Level _____
 Remarks _____

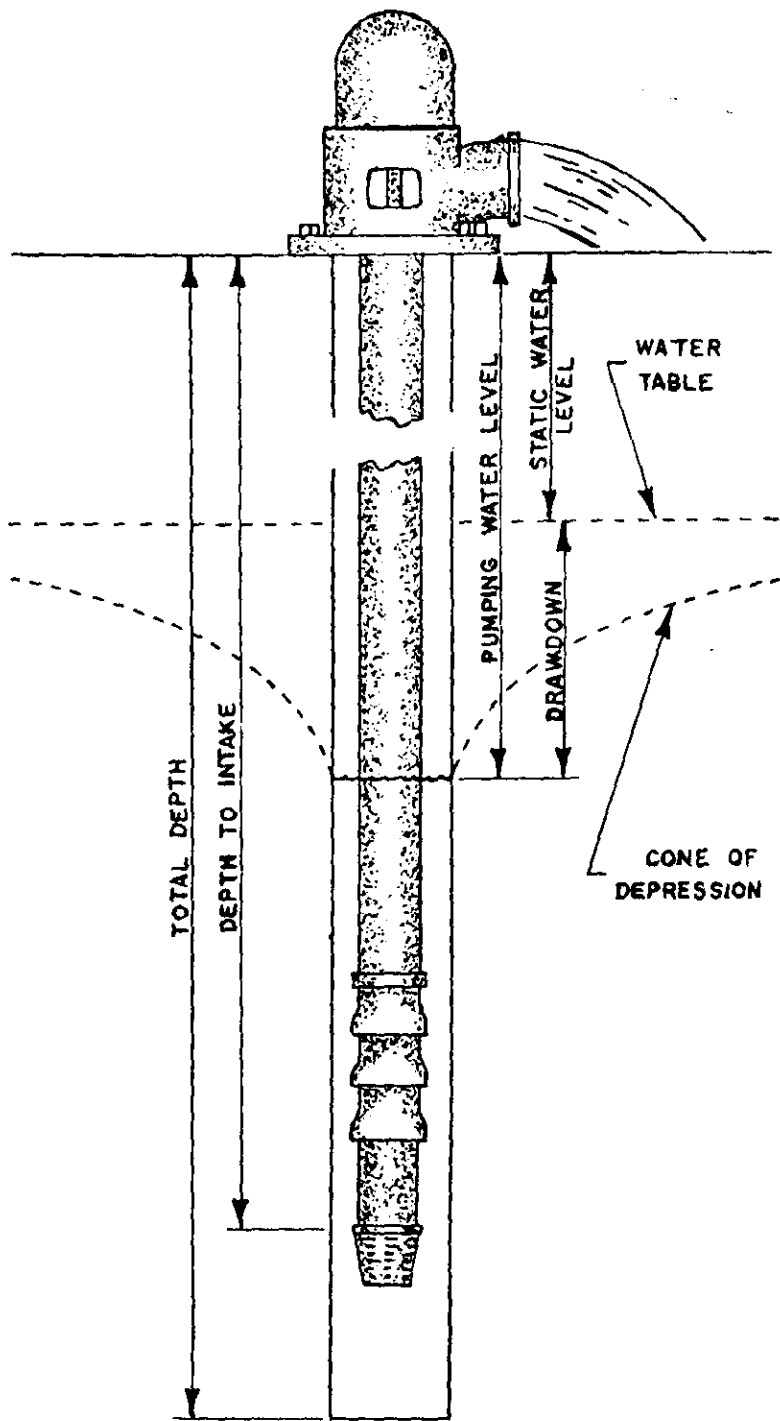

CONTRACTORS STATEMENT

The undersigned, being duly sworn upon oath, deposes and says that he is the contractor of the well or pump installation described hereon; that he has read the statement made hereon; knows the content thereof, and that the same is true of his own knowledge.

Signature M J Sullivan License No. 746

State of Colorado, County of Fremont SS

Subscribed and sworn to before me this 20 day of NOV., 1981.

My Commission expires 5-25, 1982.

Notary Public Harold Schuman
310 Bellvue Ln. Canon City, Colo.

FORM TO BE MADE OUT IN QUADRUPLICATE: WHITE FORM must be an original copy on both sides and signed. WHITE AND GREEN copies must be filed with the State Engineer. PINK COPY is for the Owner and YELLOW COPY is for the Driller.

THIS FORM MUST BE SUBMITTED
WITHIN 60 DAYS OF COMPLETION
OF THE WORK DESCRIBED HERE-
ON. TYPE OR PRINT IN BLACK
INK.

COLORADO DIVISION OF WATER RESOURCES

1313 Sherman Street - Room 818
Denver, Colorado 80203

WELL COMPLETION AND PUMP INSTALLATION REPORT

PERMIT NUMBER 122454

RECEIVED

JAN 28 1985

WATER RESOURCES
STATE ENGINEER
COLL.

WELL OWNER Hugh Barr

WELL OWNER P.O. Box 69

ADDRESS Silver Cliff, Colorado 81249

DATE COMPLETED _____, 19

SW ¼ of the SE ¼ of Sec. 25

T. 21 S. R. 71 W. 6th P.M.

HOLE DIAMETER

_____ in. from _____ to _____ ft.

_____ in. from _____ to _____ ft.

_____ in. from _____ to _____ ft.

DRILLING METHOD

CASING RECORD: Plain Casing

Size _____ & kind _____ from _____ to _____ ft.

Size _____ & kind _____ from _____ to _____ ft.

Size _____ & kind _____ from _____ to _____ ft.

Perforated Casing

Size _____ & kind _____ from _____ to _____ ft

Size _____ & kind _____ from _____ to _____ ft

Size _____ & kind _____ from _____ to _____ ft

GROUTING RECORD

Material _____

Intervals _____

Placement Method _____

GRAVEL PACK: Size _____

Interval _____

TEST DATA

Date Tested _____, 19____

Static Water Level Prior to Test _____ ft

Type of Test Pump _____

Length of Test _____

Sustained Yield (Metered) _____

Final Pumping Water Level _____

WELL LOG

From	To	Type and Color of Material	Water Loc.
		PUMP REPORT	
		TOTAL DEPTH _____	

Use additional pages necessary to complete log.

Use additional pages necessary to complete log.

PUMP INSTALLATION REPORT

Pump Make Sta-Rite
 Type submersible
 Powered by electricity HP 1/3
 Pump Serial No. 4PL4023
 Motor Serial No. M4B025
 Date Installed 9/8/84
 Pump Intake Depth 97'
 Remarks _____

WELL TEST DATA WITH PERMANENT PUMP

Date Tested _____
 Static Water Level Prior to Test _____
 Length of Test _____ Hours
 Sustained yield (Metered) _____ GPM
 Pumping Water Level _____
 Remarks _____

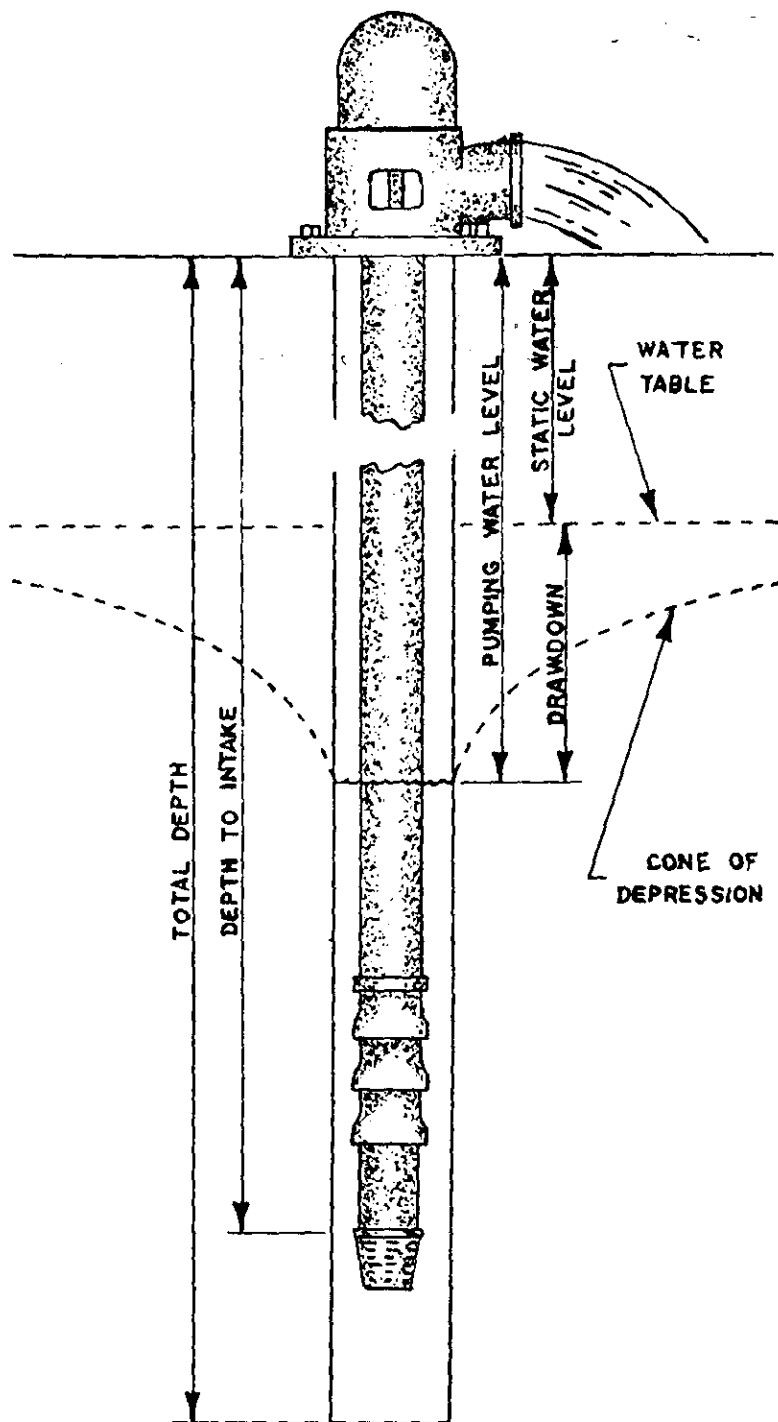

CONTRACTORS STATEMENT

The undersigned, being duly sworn upon oath, deposes and says that he is the contractor of the well or pump installation described hereon; that he has read the statement made hereon; knows the content thereof, and that the same is true of his own knowledge.

Signature [Signature]

License No. 1043

State of Colorado, County of Custer

SS

Subscribed and sworn to before me this 10 day of October, 1984

My Commission expires: 6/6, 19 87

Notary Public [Signature]

FORM TO BE MADE OUT IN QUADRUPLICATE: WHITE FORM must be an original copy on both sides and signed. WHITE AND GREEN copies must be filed with the State Engineer. PINK COPY is for the Owner and YELLOW COPY is for the Driller.

PERMIT NUMBER 122454
DATE ISSUED OCT 05 1981
EXPIRATION DATE OCT 05 1983
Robert G. Longenbaugh
Assistant (STATE ENGINEER)
BY Deane R. R. R. R.
I.D. 2-12 COUNTY 14

(5) THE LOCATION OF THE PROPOSED WELL and the area on which the water will be used must be indicated on the diagram below. Use the CENTER SECTION (1 section, 640 acres) for the well location.

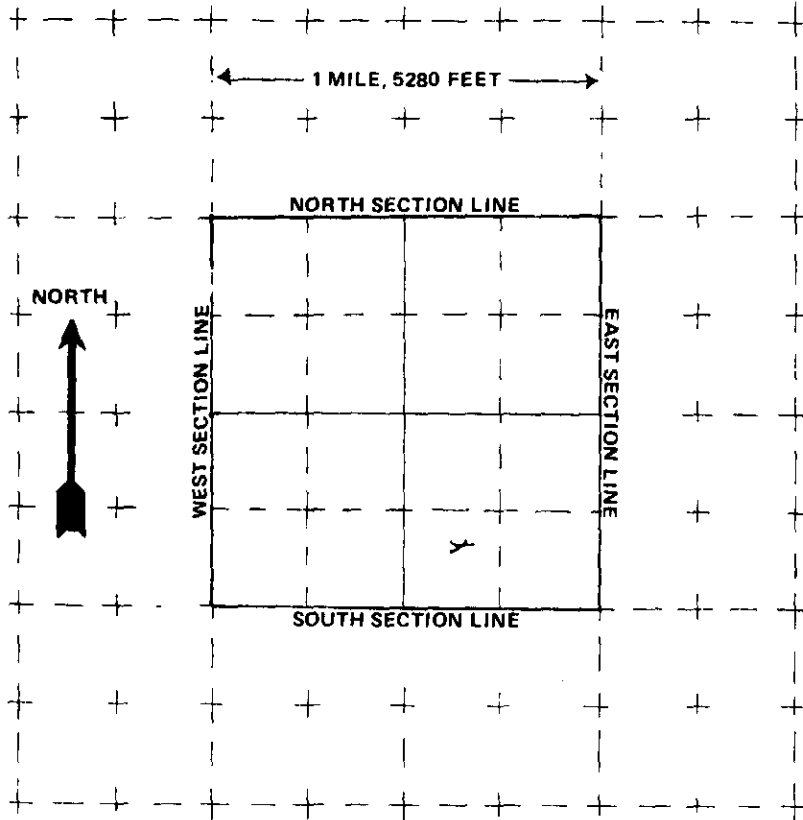

The scale of the diagram is 2 inches = 1 mile
Each small square represents 40 acres.

WATER EQUIVALENTS TABLE (Rounded Figures)

An acre-foot covers 1 acre of land 1 foot deep
1 cubic foot per second (cfs) . . . 449 gallons per minute (gpm)
A family of 5 will require approximately 1 acre-foot of water per year.
1 acre-foot . . . 43,560 cubic feet . . . 325,900 gallons.
1,000 gpm pumped continuously for one day produces 4.42 acre-feet.

(6) THE WELL MUST BE LOCATED BELOW by distances from section lines.

950 ft. from SOUTH sec. line
(north or south)
2000 ft. from EAST sec. line
(east or west)

LOT 3 BLOCK _____ FILING # 1

SUBDIVISION PETERSON RANCH

(7) TRACT ON WHICH WELL WILL BE LOCATED Owner: HUGH C. BARR

No. of acres 35 Will this be the only well on this tract? YES

(8) PROPOSED CASING PROGRAM

Plain Casing

6 3/8 in. from 0 ft. to 20 ft.

4 in. from 10 ft. to 60 ft.

Perforated casing

4 in. from 60 ft. to 100 ft.

_____ in. from _____ ft. to _____ ft.

(9) FOR REPLACEMENT WELLS give distance and direction from old well and plans for plugging it:

N - A

(10) LAND ON WHICH GROUND WATER WILL BE USED:

Owner(s): HUGH C. BARR No. of acres: 35

Legal description: SW. SE. 25

(11) DETAILED DESCRIPTION of the use of ground water: Household use and domestic wells must indicate type of disposal system to be used.

DOMESTIC & LIVESTOCK
SEPTIC TANK & LEACH FIELD

(12) OTHER WATER RIGHTS used on this land, including wells. Give Registration and Water Court Case Numbers.

Type of right	Used for (purpose)	Description of land on which used
<u>NONE</u>	<u>—</u>	<u>—</u>

(13) THE APPLICANT(S) STATE(S) THAT THE INFORMATION SET FORTH HEREON IS TRUE TO THE BEST OF HIS KNOWLEDGE.

Hugh C. Barr
SIGNATURE OF APPLICANT(S)