

Soils Map

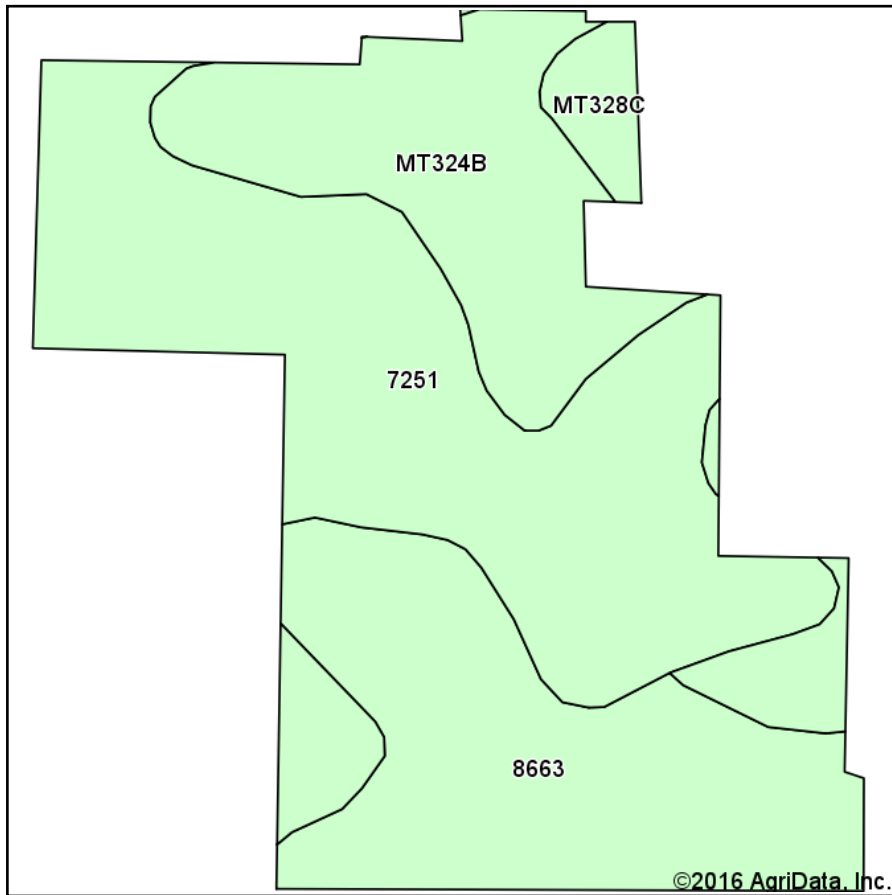

Soils data provided by USDA and NRCS.

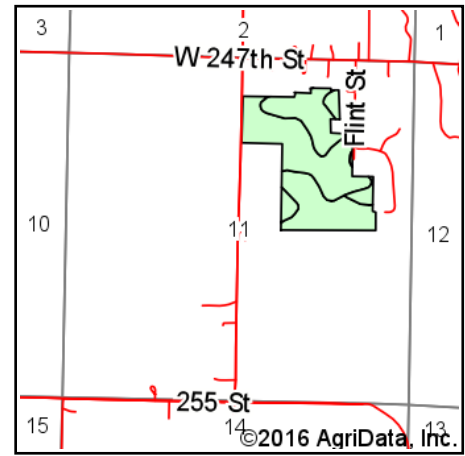

State: **Kansas**
 County: **Miami**
 Location: **11-16S-24E**
 Township: **Ten Mile**
 Acres: **66.4**
 Date: **5/31/2016**



Maps Provided By:

 © AgriData, Inc. 2016 www.AgriDataInc.com



Area Symbol: KS121, Soil Area Version: 16

Code	Soil Description	Acres	Percent of field	Non-Irr Class *c	Range Production (lbs/acre/yr)	Brome grass alfalfa hay	Corn	Grain sorghum	Smooth brome grass	Soybeans	Winter wheat	Warm season grasses
7251	Grundy silt loam, 1 to 3 percent slopes	30.25	45.6%	Ile	450	4	88	76	8	34	36	
8663	Clareson-Rock outcrop complex, 3 to 15 percent slopes	18.92	28.5%	Vle	3398							
MT324B	Bucyrus silty clay loam, 1 to 3 percent slopes	15.45	23.3%	Ile	5120						47	8
MT328C	Bucyrus silty clay loam, 3 to 8 percent slopes	1.78	2.7%	IIle	0						46	8
Weighted Average					2364.6	1.8	40.1	34.6	3.6	15.5	28.6	2.1

Area Symbol: KS121, Soil Area Version: 16

*c: Using Capabilities Class Dominant Condition Aggregation Method

Soils data provided by USDA and NRCS.