

Soil Map

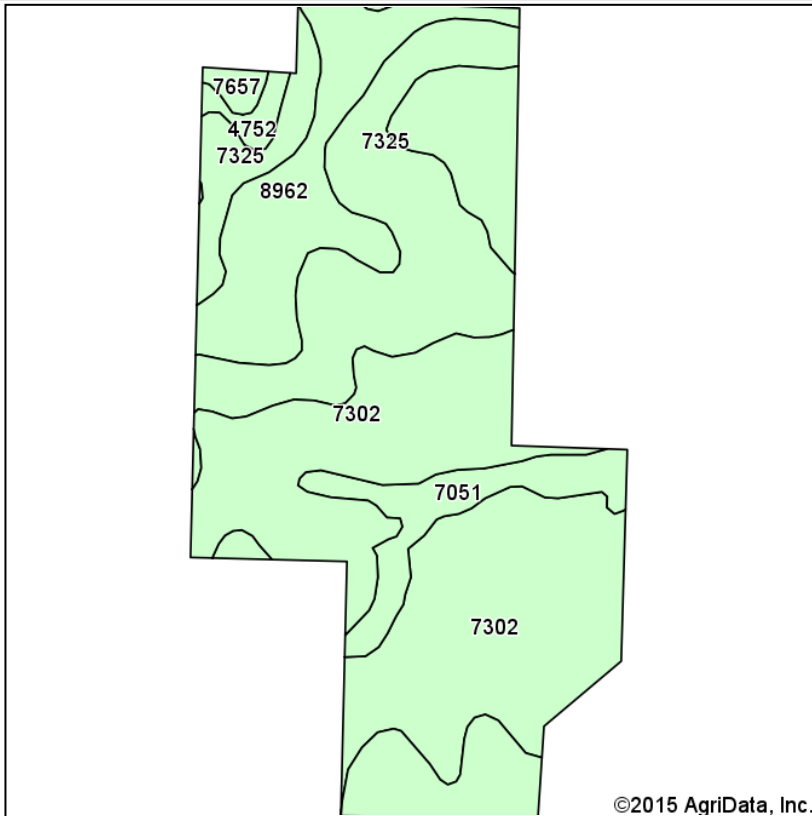

Soils data provided by USDA and NRCS.

©2015 AgriData, Inc.

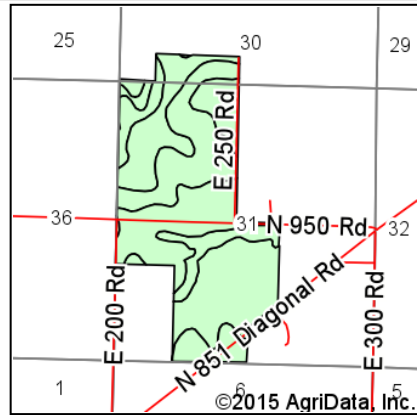

State: **Kansas**
 County: **Douglas**
 Location: **31-13S-18E**
 Township: **Clinton**
 Acres: **287.17**
 Date: **4/7/2015**

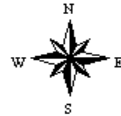

Maps Provided By:



Area Symbol: KS045, Soil Area Version: 11

Code	Soil Description	Acres	Percent of field	Non-Irr Class	Smooth brome-grass	Alfalfa hay	Corn	Grain sorghum	Soybeans	Winter wheat	Pasture
7302	Martin silty clay loam, 3 to 7 percent slopes	137.39	47.8%	IIIe	6	3	75	55	35	30	
7325	Martin-Oska silty clay loams, 3 to 6 percent slopes	86.94	30.3%	IIIe	3	3	69	61	34	32	2
8962	Woodson silt loam, 1 to 3 percent slopes	38.43	13.4%	IIs							
7051	Kennebec silt loam, frequently flooded	18.50	6.4%	Vw							
4752	Sogn-Vinland complex, 3 to 25 percent slopes	3.52	1.2%	VIIe	1						
7657	Vinland-Martin complex, 7 to 15 percent slopes	2.39	0.8%	Ve	4	1	27	18	12	10	
Weighted Average					3.8	2.4	57	44.9	27.1	24.1	0.6

Soils data provided by USDA and NRCS.