

WASHINGTON COUNTY, TEXAS
JOSHUA FLETCHER LEAGUE
ABSTRACT NO. 41

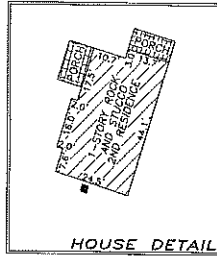
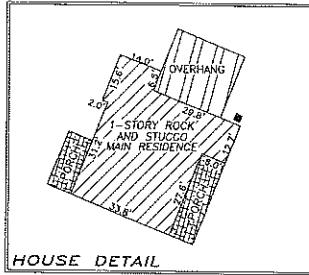

JUNE 10, 2008

ARNOLD KNUPPEL
 CALLED 42.48 ACRES
 VOLUME 543, PAGE 8
 O.R.W.C.T.

20.00 ACRES
 CALLED 20.00 ACRES
 VOLUME 1215, PAGE 139
 O.R.W.C.T.

VERNA M. DRUCKHAMMER
 CALLED 145.18 ACRES
 VOLUME 953, PAGE 489
 O.R.W.C.T.

TIMOTHY D. PHILLIPS, ET UX
 CALLED 27.45 ACRES
 VOLUME 1216, PAGE 188
 O.R.W.C.T.

PROPERTY ADDRESS
 8101 MAYER CEMETERY ROAD
 BURTON, TX 77835

SURVEY NOTES

- ALL BEARINGS ARE BASED ON THE LAMBERT GRID, TEXAS COORDINATE SYSTEM OF 1983, TEXAS CENTRAL ZONE. THE CONVERGENCE ANGLE FROM GRID NORTH IS 1°55'31".
- AS PER GRAPHICAL SCALING OF THE FEMA COMMUNITY-PANEL NO. 481188 0008 A, EFFECTIVE DATE OF MAY 24, 1977, THE PROPERTY IS SHOWN TO LIE INSIDE (ZONE C).
- THE SURVEYOR DID NOT ABSTRACT THE PROPERTY AND RELIED UPON A TITLE COMMITMENT ISSUED BY BOTTIS TITLE COMPANY, G.F. NO. WA-08-161. PROPERTY IS SUBJECT TO THOSE EASEMENTS, RESTRICTIONS, ETC. THAT APPEAR OF RECORD AND NOT SHOWN ON SURVEY.
- FIELD NOTES TO ACCOMPANY THIS PLAT.

SURVEY PLAT

OF A SURVEY OF A 20.00 ACRE TRACT OF LAND OUT OF THE JOSHUA FLETCHER LEAGUE, ABSTRACT NO. 41, WASHINGTON COUNTY, TEXAS, SAID 20.00 ACRE TRACT BEING THAT SAME PROPERTY DESCRIBED IN A DEED DATED AUGUST 21, 2006 TO TIMOTHY D. PHILLIPS AND WIFE, ROBIN L. PHILLIPS, RECORDED IN VOLUME 1215, PAGE 139, WASHINGTON COUNTY OFFICIAL RECORDS.

THIS SURVEY WAS THIS DAY MADE ON THE GROUND, UNDER MY SUPERVISION AND REPRESENTS THOSE FACTS FOUND ON THE GROUND AT THE TIME OF SURVEY.

FOR FRANK SURVEYING CO., INC.
 BY: MATTHEW W. LOESSIN, RPLS
 TEXAS REGISTRATION NO. 5953



LEGEND

- 1/2" IRON ROD FOUND
- ⊕ 3/8" IRON ROD FOUND W/CAP
- ⊕ 3/8" IRON ROD FOUND
- ⊕ IRON AXLE FOUND
- ⊕ ELECTRIC METER
- ⊕ GUY ANCHOR
- ⊕ AC PAD
- ⊕ PROPANE TANK (UNDERGROUND)
- ⊕ WATER WELL
- ⊕ SEPTIC SYSTEM
- FENCE (WIRE TYPE)
- POWERLINE (OVERHEAD)
- () RECORD DEED CALL

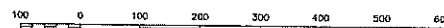

SCALE: 1" = 200 FEET

SURVEY PLAT OF 20.00 ACRES
JOSHUA FLETCHER LEAGUE, A-41
WASHINGTON COUNTY, TEXAS

2205 WALNUT STREET
 COLUMBUS, TX 78934
 979.732.3114

FRANK SURVEYING
COMPANY

COPYRIGHT 2008
 ALL RIGHTS RESERVED

DRAWN BY: KYLE KANA

REV:

SCALE: 1" = 200'

PROJECT NO: 08-185

SHEET 1 OF 1

FIELD CREW: TWH/WL

CHECKED BY: MWL COMPUTATION: AM

COPYRIGHT NOTICE:
THIS ORIGINAL WORK IS PROTECTED UNDER U.S. COPYRIGHT LAW, TITLE 17, UNITED STATES CODE SECTIONS 101 AND 102. THIS SURVEY IS BEING PROVIDED SOLELY FOR THE USE OF THE CLIENT'S REFERENCE HEREON AND NO LICENSE HAS BEEN CREATED, EXPRESSED, OR IMPLIED TO MAKE COPIES OF THIS PRODUCT. THIS PRODUCT IS VALID ONLY FOR A PERIOD OF THIRTY (30) DAYS FROM THE DATE SHOWN NEAR THE NORTH ARROW AND IS VALID FOR THIS TRANSACTION ONLY.

SHORT LINE TABLE

LINE	BEARING	DISTANCE
L1	N 07°05'02" W	133.06'
L2	N 37°18'56" E	73.22'
L3	N 16°18'22" E	115.75'
L4	N 31°50'36" E	155.00'
L5	N 01°29'36" E	179.00'
L6	N 05°31'24" W	322.00'
L7	N 16°31'36" E	110.00'
L8	N 33°58'36" E	54.00'
L9	N 67°00'36" E	51.00'
L10	N 17°50'36" E	129.00'
L11	N 29°09'36" E	28.00'
L12	N 03°58'11" W	72.93'

SCHAEFER REVOCABLE TRUST
CALLED 105.6118 ACRES
VOLUME 842, PAGE 706
O.R.W.C.T.

GARY A. RICHARDS, ET UX
CALLED 20.000 ACRES
VOLUME 1155, PAGE 367
O.R.W.C.T.

AUGUST 22, 2006

VIRGINIA WELCH
CALLED 129.2 ACRES
VOLUME 315, PAGE 634
D.R.W.C.T.

CALLED CENTERLINE
AS PER VOL. 697,
PG. 463, D.R.W.C.T.

VERNA M. DRUCKHAMMER
CALLED 145.18 ACRES
VOLUME 953, PAGE 489
O.R.W.C.T.

SURVEY NOTES

1. ALL BEARINGS ARE BASED ON LAMBERT GRID, TEXAS COORDINATE SYSTEM OF 1983, TEXAS CENTRAL ZONE AS DETERMINED BY GPS OBSERVATIONS.
2. A PORTION OF THE PROPERTY IS SHOWN TO BE INSIDE (ZONE A) OF THE FLOOD HAZARD AREA AS PER FEMA COMMUNITY-PANEL NO. 481188 0008 A, EFFECTIVE DATE OF MAY 24, 1977. (THE AREA ALONG THE CREEK IS SHOWN TO BE INSIDE FLOOD AREA).
3. THIS SURVEY WAS PREPARED WITH THE BENEFIT OF A TITLE COMMITMENT PREPARED BY BOTTS TITLE COMPANY, C.F. NO. WA-06-240, ISSUED JULY 18, 2006.
4. FIELD NOTES TO ACCOMPANY THIS PLAT.

100 0 100 200 300 400 500 600

SCALE: 1" = 200 FEET

SURVEY PLAT

OF A SURVEY OF A 27.45 ACRE TRACT OF LAND OUT OF THE JOSHUA FLETCHER LEAGUE, ABSTRACT NO. 41, WASHINGTON COUNTY, TEXAS, SAID 27.45 ACRES BEING A PART OF THAT CALLED 47.48 ACRE TRACT DESCRIBED IN A DEED DATED MAY 6, 1993 TO LINDA WIESEPAPE AND JIMMIE VOELKEL, RECORDED IN VOLUME 697, PAGE 463, OF THE OFFICIAL RECORDS OF WASHINGTON COUNTY, TEXAS.

THIS SURVEY WAS THIS DAY MADE ON THE GROUND, UNDER MY SUPERVISION, AND THIS PLAT CORRECTLY REPRESENTS THE FACTS FOUND AT THE TIME OF THE SURVEY. THIS SURVEY CONFORMS TO THE TEXAS SOCIETY OF PROFESSIONAL SURVEYORS SPECIFICATIONS FOR A CATEGORY 1A, CONDITION IV SURVEY.

FOR FRANK SURVEYING CO., INC.
BY: LEONARD W. FRANK, RPLS
TEXAS REGISTRATION NO. 1669



**SURVEY PLAT OF 27.45 ACRES
JOSHUA FLETCHER LEAGUE, A-41
WASHINGTON COUNTY, TEXAS**

2205 WALNUT STREET
COLUMBUS, TX 78934
979.732.3114

FRANK SURVEYING
COMPANY

COPYRIGHT 2006
ALL RIGHTS RESERVED

DRAWN BY: KYLE KANA

REV:

SCALE: 1" = 200'

PROJECT NO: 06-277

SHEET 1 OF 1

FIELD CREW: RJF/RDF

CHECKED BY: MWL COMPUTATION: MWL