

Soils Map

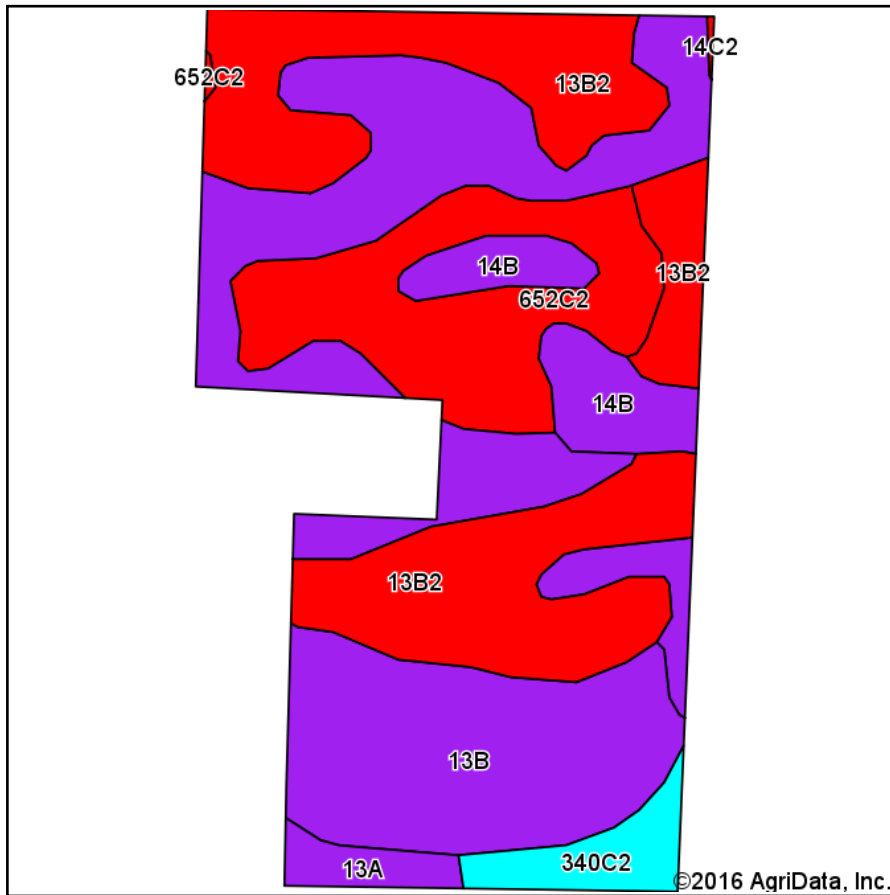

Soils data provided by USDA and NRCS.

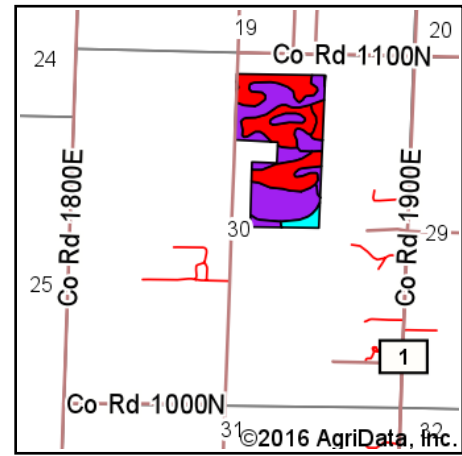

| | |
|-----------|-----------|
| State: | Illinois |
| County: | Wayne |
| Location: | 30-1S-8E |
| Township: | Jasper |
| Acres: | 58.37 |
| Date: | 2/29/2016 |

Maps Provided By:



Area Symbol: IL191, Soil Area Version: 13

| Code | Soil Description | Acres | Percent of field | Il. State Productivity Index Legend | Corn Bu/A | Soybeans Bu/A | Wheat Bu/A | Crop productivity index for optimum management |
|------------------|--|-------|------------------|-------------------------------------|-----------|---------------|------------|--|
| **13B | Bluford silt loam, 2 to 5 percent slopes | 23.82 | 40.8% | | **135 | **44 | **54 | **100 |
| **13B2 | Bluford silt loam, 2 to 5 percent slopes, eroded | 17.47 | 29.9% | | **129 | **42 | **52 | **96 |
| **652C2 | Passport silt loam, 5 to 10 percent slopes, eroded | 8.95 | 15.3% | | **116 | **39 | **51 | **88 |
| **14B | Ava silt loam, 2 to 5 percent slopes | 4.94 | 8.5% | | **134 | **44 | **54 | **99 |
| **340C2 | Zanesville silt loam, 5 to 10 percent slopes, eroded | 2.03 | 3.5% | | **112 | **39 | **48 | **85 |
| 13A | Bluford silt loam, 0 to 2 percent slopes | 1.16 | 2.0% | | 136 | 44 | 55 | 101 |
| Weighted Average | | | | | 129.4 | 42.5 | 52.8 | 96.4 |

Area Symbol: IL191, Soil Area Version: 13

Table: Optimum Crop Productivity Ratings for Illinois Soil by K.R. Olson and J.M. Lang, Office of Research, ACES, University of Illinois at Champaign-Urbana. Version: 1/2/2012 Amended Table S2 B811

Crop yields and productivity indices for optimum management (B811) are maintained at the following NRES web site:
<https://www.ideals.illinois.edu/handle/2142/1027/>

** Indexes adjusted for slope and erosion according to Bulletin 811 Table S3

Soils data provided by USDA and NRCS. Soils data provided by University of Illinois at Champaign-Urbana.

*c: Using Capabilities Class Dominant Condition Aggregation Method