

TARRANT REGIONAL WATER DISTRICT

140 FM 416, Streetman, Texas 75859
903-389-3928

**NOTICE OF APPROVAL
OF
ON-SITE SEWAGE FACILITY**

PERMIT # 030019

Property Owner JACKIE THOMAS EATON

Mailing Address 602 GRANDVIEW
CORSEICANA, TX. 75110

Property Location LOT # 65, B/LK. 1
GRANDVIEW ESTATES
NAVARRO County, Tx.

This serves to notify all persons that the on-site sewage facility owned by the above has satisfied design, construction, and installation requirements of the Texas Natural Resource Conservation Commission (TNRCC) and the District Waste Control Order. This Tarrant Regional Water District On-Site Sewage Facility Permit is issued for the operation of the above identified on-site sewage facility.

ANY MODIFICATIONS TO THE SYSTEM STRUCTURE, OR ITS COMPONENTS, MAY REQUIRE A NEW PERMIT. The owner must notify this office of the aforementioned changes.

ADDITIONAL INFORMATION:

James H. Bailey
Authorized District Representative

6-13-00
Date

TARRANT REGIONAL WATER DISTRICT

Rt 1 Box 1660, Streetman, Texas 75859

903-389-3928

PROPERTY OWNER: Jackie Thomas Eaton

PERMIT NUMBER: RC 030019

On 4-26-00 an inspection was conducted on the on-site sewerage facility designed to serve your property.

System approval is **DENIED** until the following deficiency(s) is corrected and the system reinspected:

Service contract is required prior to approval.

Chapter 366, Subchapter D, Section 366.055 (b) of the Texas Health and Safety Code states that "An on-site sewage disposal system may not be used unless it is inspected and approved by the department or the authorized agent". Furthermore Section 366.056 (a) states that "The department or authorized agent may approve or disapprove the on-site disposal system depending on the results of the inspections under Section 366.055"; while 366.055 (b) states that "If a system is not approved under this section, the on-site sewage disposal system may not be used until all deficiencies are corrected and the system is reinspected and approved by the department or authorized agent".

All final permits are being held pending the correction of the above identified deficiency(s) and inspected and approved by this office. Use of the system without agency approval may result in the appropriate legal action being initiated.

Please contact our office at 903-389-3928 as soon as corrective actions are completed to arrange for an inspection to verify that the deficiencies have been corrected.

Chris R. Bailey James H. Bailey Perry Richter
Inspector Owner/Installer

TARRANT REGIONAL WATER DISTRICT

Rt 1 Box 1660, Streetman, Texas 75859
903-389-3928

ON-SITE SEWAGE FACILITY PROGRAM

AEROBIC SYSTEM INSPECTION REPORT

PROPERTY OWNER: Jackie Thomas Eaton PERMIT NUMBER: RC030019

I. SEWER		Y	N
CLEANOUTS PROPERLY INSTALLED:		<input checked="" type="checkbox"/>	
PROPER TYPE PIPE FROM STRUCTURE TO DISPOSAL SYSTEM:		<input checked="" type="checkbox"/>	
SLOPE OF SEWER 1/4 TO 1/8 INCH PER FOOT:		<input checked="" type="checkbox"/>	
II. PRETREATMENT		Y	N
IS PRETREATMENT REQUIRED?		<input checked="" type="checkbox"/>	
TANK PROPERLY PLUMBED?		<input checked="" type="checkbox"/>	
TANK SIZE REQUIRED: <u>400</u>	TANK SIZE INSTALLED: <u>400</u>	**	**
TANK TYPE: <u>concrete</u>	MANUFACTURER: <u>Hoot</u>	**	**
III. AEROBIC TREATMENT UNIT		Y	N
UNIT SIZE REQUIRED <u>300</u> GPD	UNIT SIZE INSTALLED <u>500</u> GPD	**	**
MANUFACTURER: <u>Hoot</u>		**	**
MODEL NUMBER: <u>H-500AS</u>	SERIAL NUMBER: <u>400-H500-750-H10</u>	**	**
TYPE OF AERATOR <u>Hoot</u>	SERIAL NUMBER: <u>40</u>	**	**
HIGH WATER ALARM INSTALLED?	(check type) <input checked="" type="checkbox"/> LIGHT <input type="checkbox"/> SOUND	<input checked="" type="checkbox"/>	
FILTER INSTALLED (if required)?		<input checked="" type="checkbox"/>	
ALARM WIRING SEPARATE FROM PUMP?		<input checked="" type="checkbox"/>	
CHLORINATOR PROPERLY INSTALLED?		<input checked="" type="checkbox"/>	
CHLORINE TABLETS IN PLACE?		<u>N/A</u>	
IV. PUMP TANK			
TANK SIZE REQUIRED: <u>750</u>	TANK SIZE INSTALLED: <u>750</u>		
TYPE: <u>concrete</u>	MANUFACTURER: <u>Hoot</u>		
TYPE AND SIZE OF PUMP: <u>Blaster Model 12EB 1/2 HP</u>			
V. APPLICATION AREA (SUB-SURFACE ONLY)			
AREA REQUIRED: <u>3000 ft²</u>	AREA INSTALLED: <u>3080 ft²</u>		
TYPE LINE INSTALLED: <u>Hoot drip emitter</u>			
LENGTH OF DRIP EMITTER LINE INSTALLED: <u>1540 ft</u>			
LENGTH OF LOW PRESSURE DOSING LINE INSTALLED: <u>N/A</u>			
SPACING OF LINE INSTALLED: <u>2 ft</u>			
DEPTH OF LINE INSTALLED: <u>8 in</u>			

COMMENTS: Pressure set at 20 PSI - 4-26-00

INSPECTED BY: JAMES H. Bailey / Chris Rolin

DATE: 4-26-00

11:00

TARRANT REGIONAL WATER DISTRICT

140 FM 416, Streetman, Texas 75859
903-389-3928

**AUTHORIZATION TO CONSTRUCT
AN
ON-SITE SEWAGE FACILITY**

Application Number RC 030019

Property Owner Jackie Thomas Eaton

Mailing Address 602 Grandview
 Corsicana, Tx. 75110

Property Location Lot # 65, Blk. 1
 Grandview Estates
 Navarro County, Texas

This serves to notify all persons that an on-site sewerage facility application, related technical data, and the appropriate fee have been received by the Tarrant Regional Water District (District) from the property owner. The application has been reviewed for technical and administrative consideration against the standards set forth by the District. Approval is hereby granted for the construction as shown on the submitted plans.

Any modifications to submitted plans require approval by the Tarrant Regional Water District prior to installation.

You or your installer must contact the District office at 903-389-3928 between 7:30 A.M. to 8:30 A.M. to arrange for the required facility inspection. Calls after 8:30 A.M. may result in inspection being delayed until the next working day. **The authorization to construct is valid for one year from the date of issue of an application.** If a final inspection has not been performed within one year of issue, a new application and fee will be required.

Comments: The following design is based upon the minimum standards set forth by the Texas Natural Resource Conservation Commission and is based on a maximum daily flow of 300 gallons, the use of water saving devices is required.



Authorized District Representative

4-3-00

Date

TARRANT REGIONAL WATER DISTRICT
140 FM 416, Streetman, Texas 75859
903-389-3928
Fax # 903-389-7587

TR'VD USE ONLY

RC030019
APPLICATION NO.
9886
RECEIPT NO.
3-17-00
DATE
9886
AMOUNT

APPLICATION FOR ON-SITE
SEWAGE FACILITY

Richland-Chambers
TRWD RESERVOIR
Haggarro
COUNTY OF INSTALLATION

1. PROPERTY OWNER'S NAME: Eaton JACIE Thomas
(LAST) (FIRST) (MIDDLE)
2. PERMANENT MAILING ADDRESS: 602 Grandview Corsicana TX 75110
(STREET/PO BOX) (CITY/STATE) (ZIP)
3. TELEPHONE NO. DURING DAY: (903) 872-0850
4. SITE ADDRESS: 602 Grandview Corsicana TX 75110
(STREET) (CITY/STATE) (ZIP)
5. PROPERTY DESCRIPTION: LOT NO. 65 BLOCK 1 SEC 1 SIZE 1/2 AC SQ.FT.
SUBDIVISION: Grandview Acreage 1/2 AC Survey LOT
6. SOURCE OF WATER: Private Well ☒ Public Water Supply men water Supply
(NAME OF SUPPLIER)
7. SINGLE FAMILY RESIDENCE: No. of Bedrooms 4 JHB Living Area (sq. ft.) 2492 JHB
DESIGNED MAXIMUM DAILY WATER CONSUMPTION (gpd): 300
240 gal
8. COMMERCIAL/INSTITUTIONAL (including multi-family residences) TYPE: —
NO. OF EMPLOYEES/OCCUPANTS/UNITS: 2 DAYS OCCUPIED PER WEEK: 7
DESIGNED MAXIMUM DAILY WATER CONSUMPTION (gpd): —
9. IS AN ORGANIZED SEWAGE COLLECTION WITHIN 300 FEET? Yes ☒ No
10. DESIGNER: William Hill LICENSE NO.: ~~957522~~ 1361
PHONE NO.: 903-874-3945
11. INSTALLER: Perry Richter - Richter Back Service REGISTRATION NO.: 0511 3111
PHONE NO.: 903-874-6006

I certify that the above statements are true and correct to the best of my knowledge. Authorization is hereby given to the Tarrant Regional Water District to enter upon the above described private property for the purpose of lot evaluation and inspection of on-site sewerage facilities. I understand that the approval of this application constitutes authorization for construction of the on-site sewerage facility and that a permit to operate the facility will be granted following successful inspection of the installed system which indicates that the system was installed in compliance with TNRCC's On-Site Sewage Facility Rules (OSSF) and the District's Waste Control Order.

Jacque T. Eaton
(SIGNATURE OF OWNER)
Charlotte Smith
(SIGNATURE OF AUTHORIZED DISTRICT REPRESENTATIVE)

3-15-00
(DATE)
3/17/00
(DATE)

BUILDING PERMIT

COUNTY OF NAVARRO, TEXAS

№ 0500

COUNTY OF NAVARRO, TEXAS					
JOB ADDRESS					
LOT NO.	BLK.	SUBDIVISION			
65		Grandview Estates			
OWNER	Tom Eaton 3112		ADDRESS	Purdue	PHONE Coreciana Tx.
CONTRACTOR	Generation II		ADDRESS		PHONE
ELECTRICAL	Sub		ADDRESS		PHONE
PLUMBING	Sub		ADDRESS		PHONE
MECHANICAL	Sub		ADDRESS		PHONE
USE OF BUILDING residential					
CLASS OF WORK: <input checked="" type="checkbox"/> NEW <input type="checkbox"/> ADDITION <input type="checkbox"/> ALTERATION <input type="checkbox"/> REPAIR <input type="checkbox"/> DEMOLISH					
DESCRIBE WORK: build new home					
TYPE OF CONST. Brick		SQ. FT. 2494'	NO. OF STORIES 1		
NO. OF ROOMS 4 BR		NO. OF BATHS 3	FOUNDATION Concrete		
ROOF comp.		SP RINKLERS REQUIRED	PARKING SPACES		
NO. OF DWELLING UNITS 1		ZONING SF-1	OCCUPANCY GROUP SF		
NOTICE THIS PERMIT BECOMES NULL AND VOID IF WORK OR CONSTRUCTION AUTHORIZED IS NOT COMMENCED WITHIN 6 MONTHS, OR IF CONSTRUCTION OR WORK IS SUSPENDED OR ABANDONED FOR A PERIOD OF 1 YEAR AT ANY TIME AFTER WORK IS COMMENCED. THE ISSUANCE OF THIS PERMIT SHOULD NOT BE CONSTRUED BY ANY PERSON AS AN APPROVAL OF BUILDING OR CONSTRUCTION TECHNIQUES, METHODS, OR MATERIALS.			I HEREBY CERTIFY THAT I HAVE READ AND EXAMINED THIS APPLICATION AND KNOW THE SAME TO BE TRUE AND CORRECT. ALL PROVISIONS OF LAWS AND ORDINANCES GOVERNING THIS TYPE OF WORK WILL BE COMPLIED WITH WHETHER SPECIFIED HEREIN OR NOT. THE GRANTING OF A PERMIT DOES NOT PRESUME TO GIVE AUTHORITY TO VIOLATE OR CANCEL THE PROVISIONS OF ANY OTHER STATE OR LOCAL LAW REGULATING CONSTRUCTION OR THE PERFORMANCE OF CONSTRUCTION.		
			SIGNATURE: Dennis R. Phelts		
			VALUATION: \$120,000.00 PERMIT FEE \$292.50		
			APPROVED FOR ISSUANCE BY: Vicki Lane DATE: 7-4-2000		
SPECIAL CONDITIONS:					
THIS BECOMES YOUR PERMIT WHEN APPROVED FOR ISSUANCE					

ON-SITE SEWAGE FACILITY SOIL SURVEY REPORT INFORMATION

Property Owner's Name Tom Eaton
 Mailing Address 3012 Purdue St.
 City, State, Zip Corsicana, TX 75110
 Site Location Grandview Estates, Lot 65
 County Navarro

(FOR HOLE #1)

DEPTH	TEXTURE	CLASS	STRUCTURE	WATER TABLE	SLOPE 0-30%	* SOIL SERIES	* SOIL ABSORPTION
in.	i.e. Loamy Sand, Sandy Loam, Loam, Silty Clay Loam, Sandy Clay, or Clay.	per USDA Chart i.e. Ia,Ib,II,III,or IV	Only if soil is a Class III i.e. Blocky, Platy, or Massive	PRESENT Yes / No	Maximum of overall drainfield	per County Soil Survey i.e. "Bowie"	LIMITATION RATING i.e. Fair, Moderate, Severe
0 - 30	Sa Clay	III	Sub Ang Bl	No	2.6%		Moderate
30 - 48	Clay	IV					Severe

* This can be found in the County Soil Survey entitled "Sanitary Facilities" (optional)

THE MOST RESTRICTIVE SOIL CLASS FOUND WITHIN TWO (2) FEET OF THE BOTTOM OF THE PROPOSED EXCAVATION IS: CLASS IV [Note Class Ia & IV are unsuitable for standard disposal systems]

(FOR HOLE #2)

DEPTH	TEXTURE	CLASS	STRUCTURE	WATER TABLE	SLOPE 0-30%	* SOIL SERIES	* SOIL ABSORPTION
in.	i.e. Loamy Sand, Sandy Loam, Loam, Silty Clay Loam, Sandy Clay, or Clay.	per USDA Chart i.e. Ia,Ib,II,III,or IV	Only if soil is a Class III i.e. Blocky, Platy, or Massive	PRESENT Yes / No	Maximum of overall drainfield	per County Soil Survey i.e. "Bowie"	LIMITATION RATING i.e. Fair, Moderate, Severe
0 - 16	Sa Clay Loam	III		No	2.60%		Moderate
16 - 42	Clay	IV					Severe

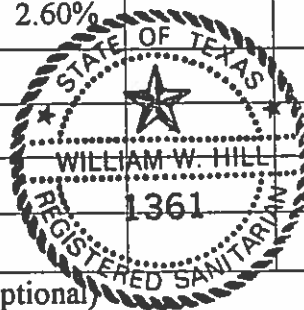

* This can be found in the County Soil Survey entitled "Sanitary Facilities" (optional)

THE MOST RESTRICTIVE SOIL CLASS FOUND WITHIN TWO (2) FEET OF THE BOTTOM OF THE PROPOSED EXCAVATION IS: CLASS IV [Note: Class Ia & IV are unsuitable for standard disposal systems]

EVALUATION PERFORMED BY: William Hill circle one (RS) PE, CPSS, DR. **
 DATE OF SOIL SURVEY: 7 January 2000 CERTIFICATION NO: OS7622

Testing
Backflow Preventers
RPZA, PVB, DC

WILL HILL
TESTING AND DESIGN
204 N. FM 2555
CORSICANA, TEXAS 76110
903-876-3965

Design
On-Site Sewage Systems
Sludge Disposal Sites

Calculations for Drip Emitter System

Tom Eaton
Grandview Estates; Lot 65

4 bedroom house with water saving fixtures = 300 gal./day

Long term application in Class IV soil = 0.1 gal./ sq. ft./day

Required:

300 gal/day + 0.1 gal./sq. ft./day = 3000 sq. ft. application area (required)

3000 sq. ft. + 4 sq. ft./emitter = 750 emitters X 2 ft. drip line/emitter = 1500 ft. of drip line.

Designed: (See explanation after calculations).

1500 ft drip line + 2 ft. dripline / emitter = 750 emitters.

750 emitters x 1.13 gal./hr./emitter = 847.5 GPH + 2 fields = 424 GPH/field.

424 GPH + 60 min./hr. = 7.0 GPM.

(6 cycles/day) 300 GPD + 6 cycles/day = 50 gal./cycle

(8 cycles/day) 300 GPD + 8 cycles/day = 37.5 gal./cycle

50 gal./cycle + 7.0 gal./min. = 7.1 min./cycle.

37.5 gal./cycle + 7.0 gal./min. = 5.3 min./cycle.

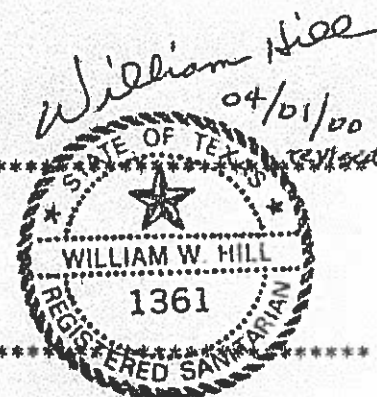

Cont. specifications for Tom Eaton

TNRCC requires 1/3 daily rated usage as reserve capacity in the pump tank in case of malfunction of the treatment system. At a designed usage of 300 GPD (300 gal. \div 3 = 100 gal. req.) there will be 100 gal. or 1.0 times the required reserve capacity.

Operating Pressure = 20 psi = 46 ft. head.

Pump Head:

Pressure Head = 46 ft.

Friction Head = 7 ft.

Elevation Head = 6 ft.

59 ft. @ 7.0 GPM + 2 GPM recycle = 9.0 GPM @ 59 ft total pump head.

The treatment system is to be a Hoot H-500 AD, CP with the Blaster (Model 12EB) 1/2 HP pump. The field is split into two units since the total drip line exceeds 1000 feet in length.

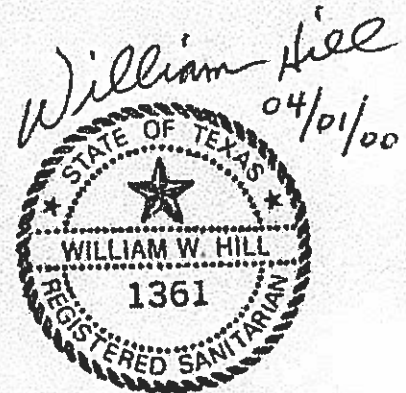

Tom Eaton
Grandview Estates
Lot 65

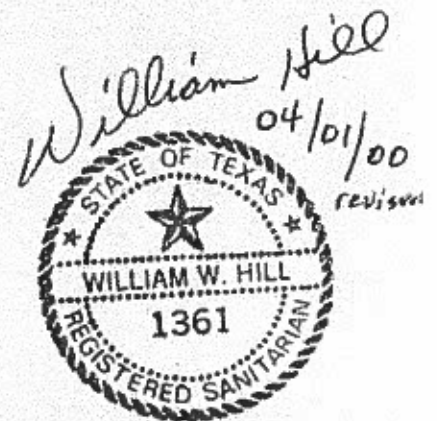
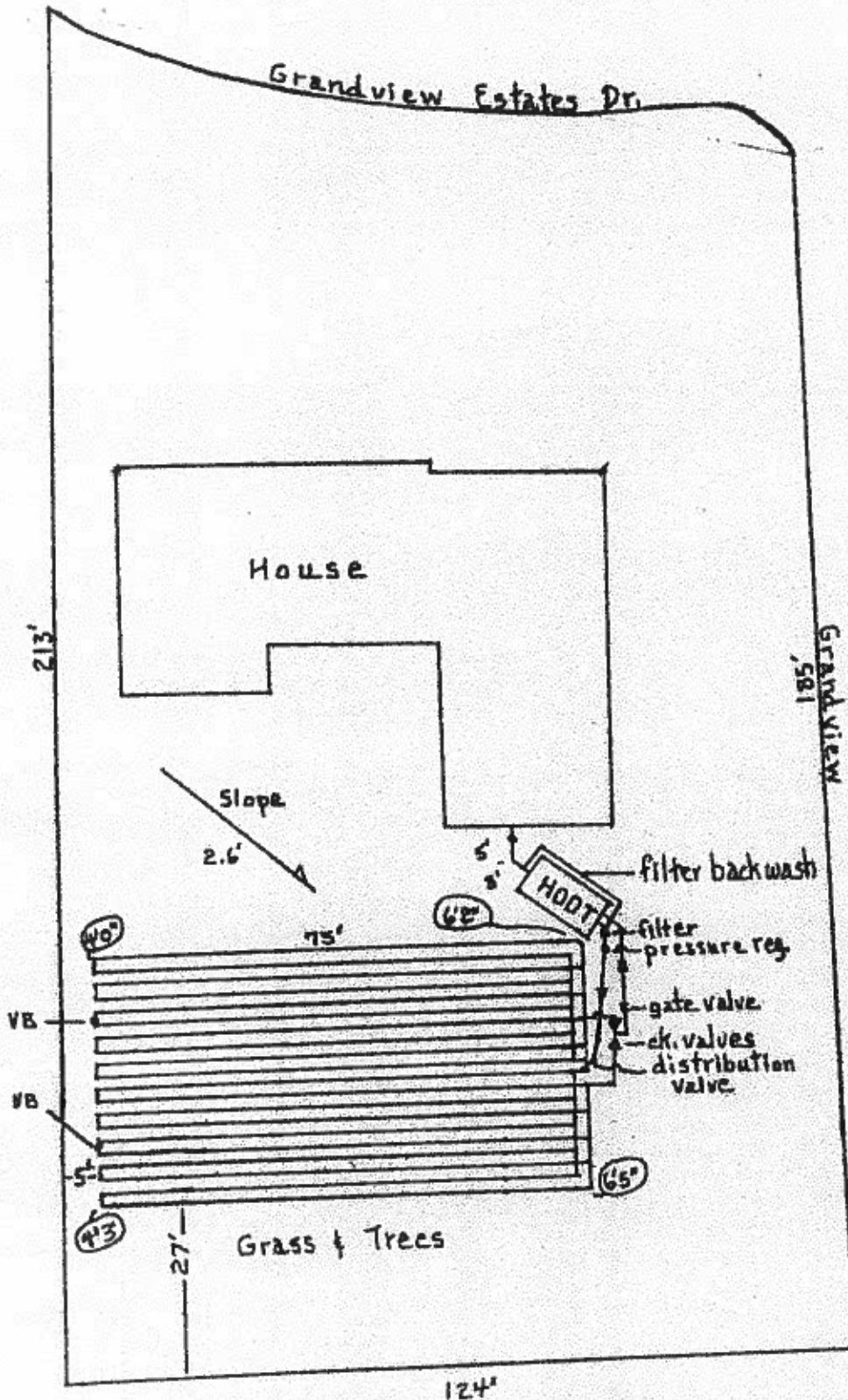

500 GPD DEMAND PUMPING SYSTEM H-500 AD,CP

Tom Eaton
Grandview Estates

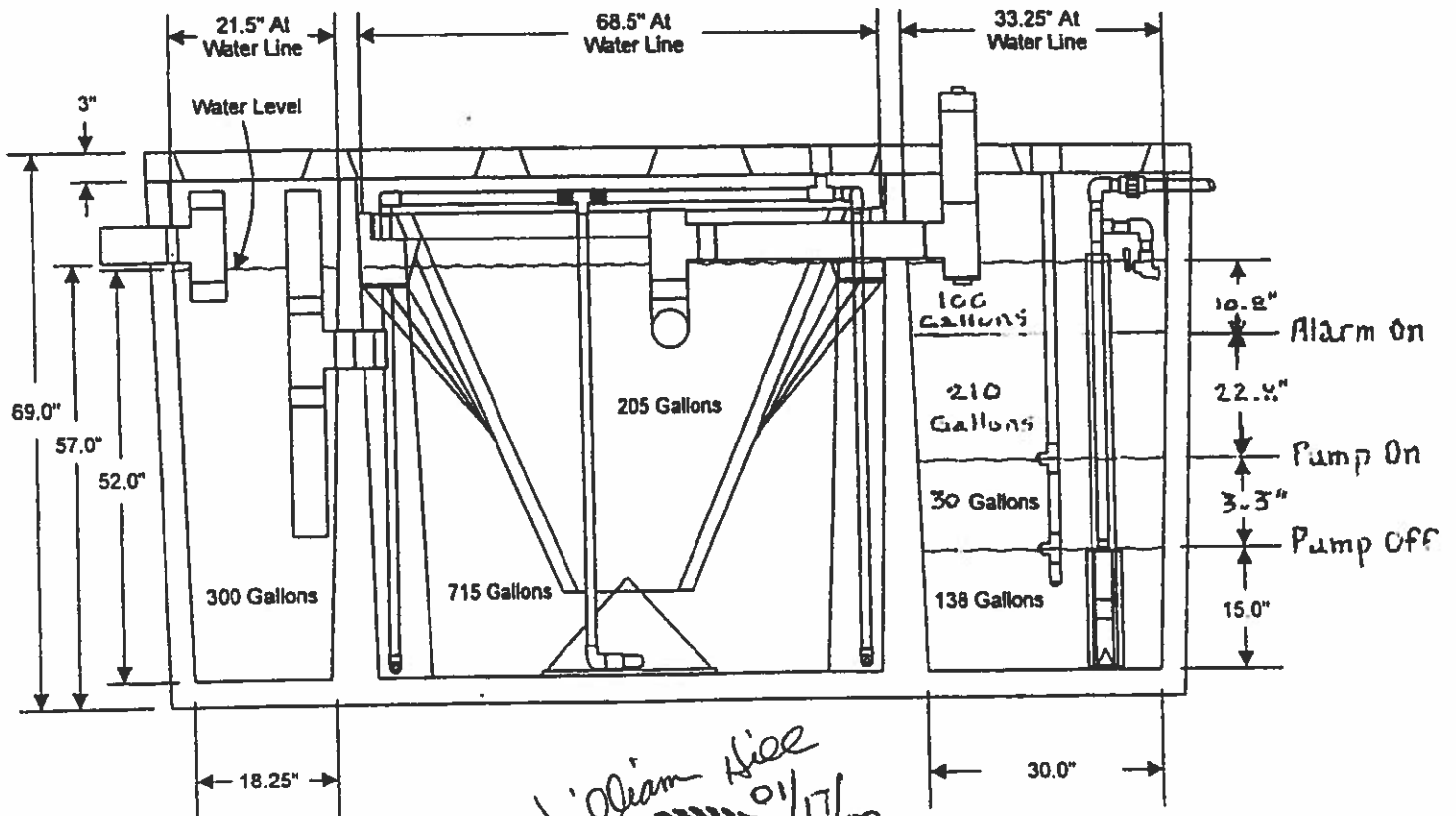
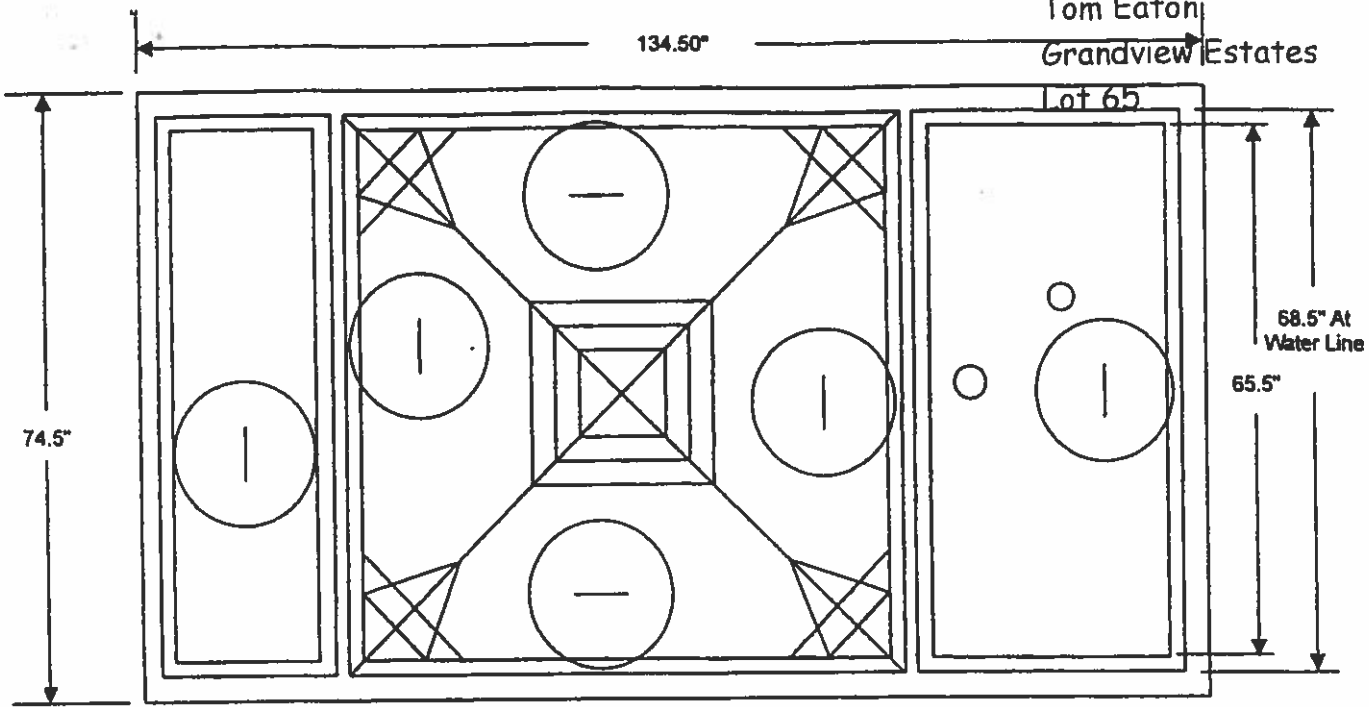

1.656' Avg. Length
5.600' Avg. Width
4.333' Depth

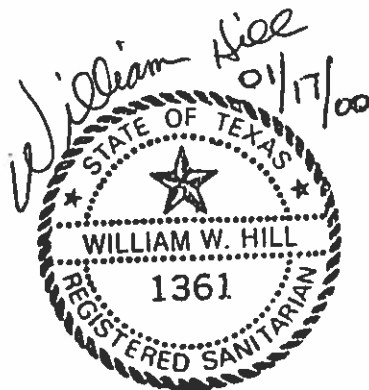

2.630' Avg. Length
5.600' Avg. Width
4.333' Depth

478 Gallons
138 Gallons Remaining In Tank

340 Gallons