

Map of the 2015-2016 growing season precipitation for the 2017-2018 growing season. The map shows precipitation levels in inches across the state of Iowa. The legend indicates three categories: 17.2 inches or more (orange), 24.8 inches (yellow), and 5.4 inches or less (light yellow). The map shows that the northern part of the state received 17.2 inches or more of precipitation, while the southern part received 5.4 inches or less. The central part of the state received 24.8 inches of precipitation.

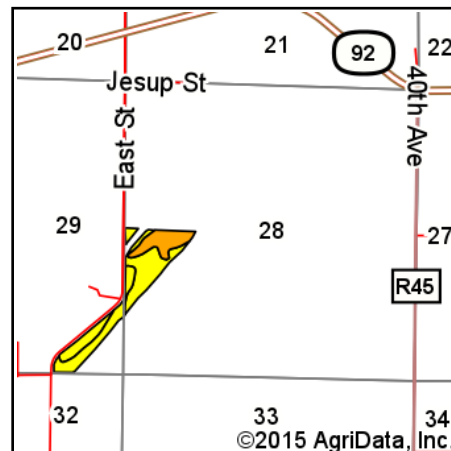

State:	Iowa
County:	Warren
Location:	29-76N-25W
Township:	Jefferson
Acres:	33.86
Date:	12/22/2015



Maps Provided By:

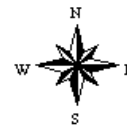

Soils data provided by USDA and NRCS.

Code	Soil Description	Acres	Percent of field	CSR Legend	Non-Irr Class *c	CSR*	Bromegrass alfalfa	Bromegrass alfalfa hay	Corn	Kentucky bluegrass	Oats	Smooth brome	Soybeans
248	Wabash silty clay loam, 0 to 2 percent slopes	17.35	51.2%		IIIw	60	5.5		159		64	4.4	43
54	Zook silty clay loam, 0 to 2 percent slopes	8.88	26.2%		IIw	70		6.1	173	3.4	69	4.8	47
172	Wabash silty clay, 0 to 2 percent slopes	7.63	22.5%		IIIw	45	4.5		139		56	3.6	38
Weighted Average						59.2	3.8	1.6	158.2	0.9	63.5	4.3	42.9

*c: Using Capabilities Class Dominant Condition Aggregation Method

Soils data provided by USDA and NRCS.