

# Soils Map-CSR(as of 1/21/12)

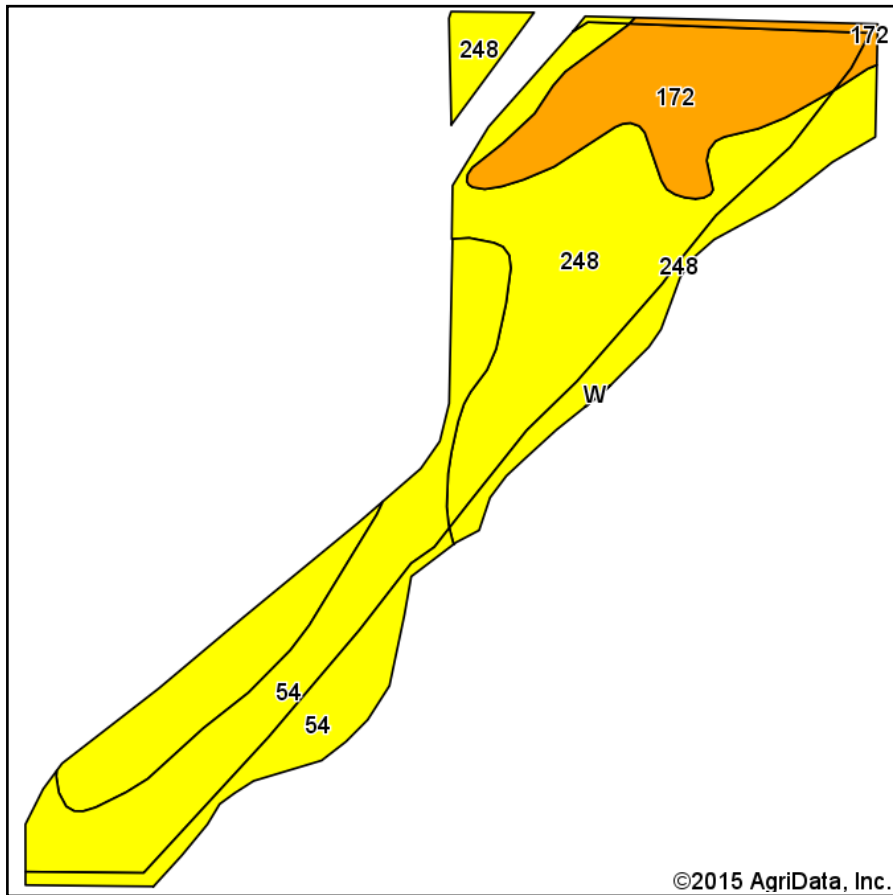

Soils data provided by USDA and NRCS.

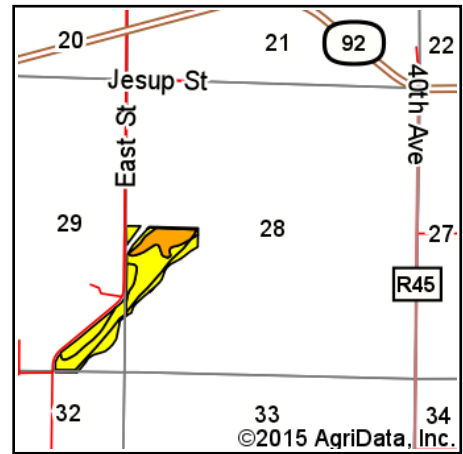

State: **Iowa**  
 County: **Warren**  
 Location: **29-76N-25W**  
 Township: **Jefferson**  
 Acres: **41.72**  
 Date: **12/22/2015**



Maps Provided By:



## Archived Soils Ending 1/21/2012

Code	Soil Description	Acres	Percent of field	CSR Legend	Non-Irr Class *c	CSR*	Bromegrass alfalfa	Bromegrass alfalfa hay	Corn	Kentucky bluegrass	Oats	Smooth bromegrass	Soybeans
248	Wabash silty clay loam, 0 to 2 percent slopes	21.19	50.8%		IIIw	60	5.5		159		64	4.4	43
54	Zook silty clay loam, 0 to 2 percent slopes	12.33	29.6%		IIw	70		6.1	173	3.4	69	4.8	47
172	Wabash silty clay, 0 to 2 percent slopes	8.20	19.7%		IIIw	45	4.5		139		56	3.6	38
<b>Weighted Average</b>						<b>60</b>	<b>3.7</b>	<b>1.8</b>	<b>159.2</b>	<b>1</b>	<b>63.9</b>	<b>4.4</b>	<b>43.2</b>

\*The CSR ratings are dated 1/21/2012 and will be available to aid in the transition to CSR2.

\*c: Using Capabilities Class Dominant Condition Aggregation Method

Soils data provided by USDA and NRCS.