

Soils Map-CSR2

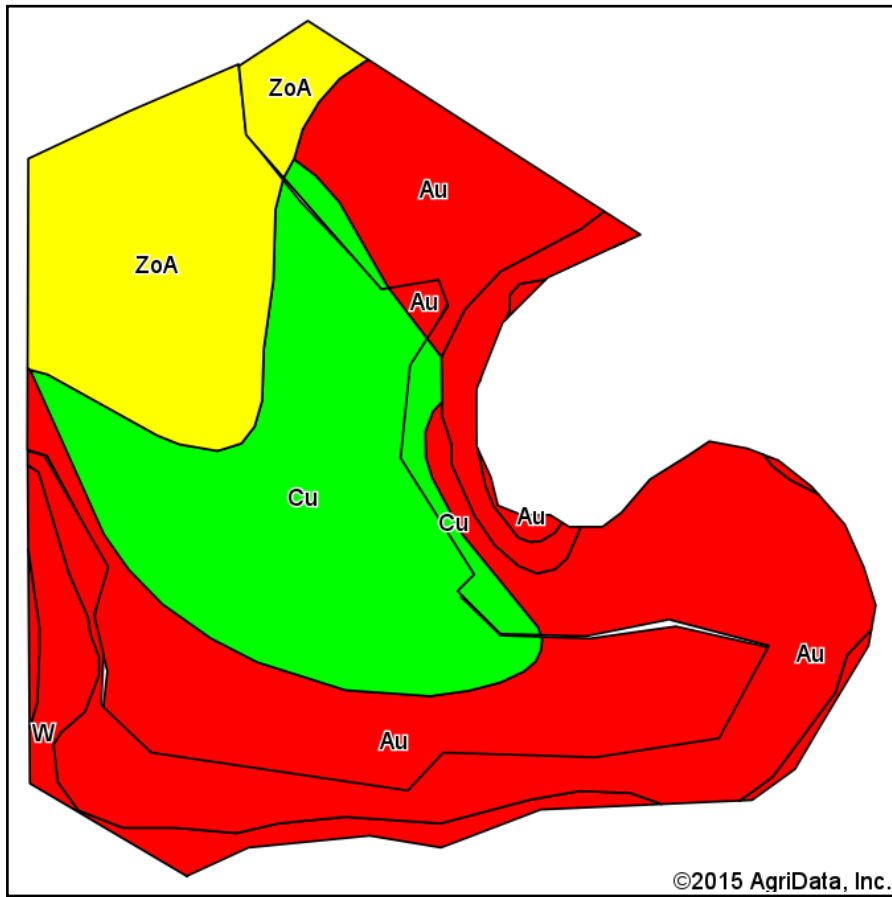

Soils data provided by USDA and NRCS.

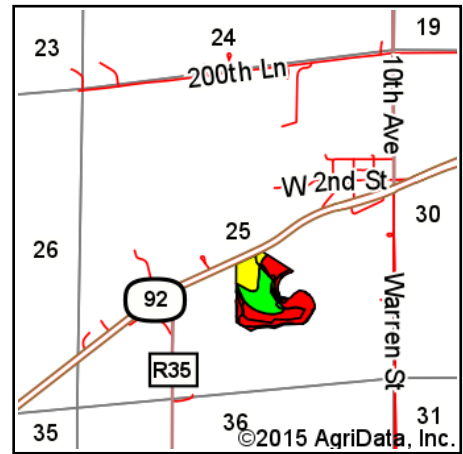

State: **Iowa**
 County: **Madison**
 Location: **25-76N-26W**
 Township: **Crawford**
 Acres: **25.44**
 Date: **11/6/2015**



Maps Provided By:



Area Symbol: IA121, Soil Area Version: 18

Code	Soil Description	Acres	Percent of field	CSR2 Legend	Non-Irr Class *c	CSR2**	CSR
Au	Alluvial land	12.20	48.0%		IIIw	5	20
Cu	Colo silty clay loam	6.56	25.8%		IIw	74	70
ZoA	Zook silty clay loam, 0 to 2 percent slopes	4.50	17.7%		IIw	65	70
W	Water	2.18	8.6%			0	0
Weighted Average						33	40

Area Symbol: IA121, Soil Area Version: 18

**IA has updated the CSR values for each county to CSR2.

*c: Using Capabilities Class Dominant Condition Aggregation Method

Soils data provided by USDA and NRCS.