

These drawings are the sole property of STEGER BIZZELL. The use of these drawings is hereby restricted to the original site for which they were prepared. Reproduction or reuse of these drawings in whole or in part without written permission of STEGER BIZZELL is strictly prohibited.

James A. Page Survey
A - 519

84.0025 Ac.
Robert B. Wood and wife,
Barbara A. Wood
Doc. No.2002011867
O.P.R.W.C.T.

James W. Mago Tr.
of The James W. Mago Living Trust
10.668 Acres
Doc. No.2013110169
O.P.R.W.C.T.

Craig Alan Stark and
Brandi Reeves Stark
20.084 Acres
Doc. No.2008027562
O.P.R.W.C.T.

Ryan Rychlik and
Paula Ann Rychlik
20.084 Acres
Doc. No.2008061525
O.P.R.W.C.T.

Emigration

WILLIAM D. BLAKELY AND
LINDA L. BLAKELY
20.00 ACRES
DOC. No.2008003802
O.P.R.W.C.T.
10.000 AC.

Michael J Zrubek and
Sherry Ann Zrubek
1.00 Acre
Doc. No.2014029435
O.P.R.W.C.T.

0.25 Ac.
C. L. Chance
County Judge of Williamson
County, Texas
Vol.892, Page 265
D.R.W.C.T.

Ryan C. Rychlik and spouse
Paula A. Rychlik
14.07 Acres
Doc. No.2010016877
O.P.R.W.C.T.

Tract 2
69.35 Ac.
Henry Daniel Martinka
and wife,
Frances Mary Martinka
2301 / 81
D.R.W.C.T.

LEGEND

- - 1/2" IRON REBAR FOUND (UNLESS NOTED)
- - 1/2" IRON REBAR SET WITH CAP STAMPED "RPLS 5784"
- () - RECORD INFO PER DOC. NO. 2008003802, O.P.R.W.C.T.
- [] - RECORD INFO PER VOLUME 2301, PAGE 81, D.R.W.C.T.
- O.P.R.W.C.T. - OFFICIAL PUBLIC RECORDS, WILLIAMSON COUNTY, TEXAS
- D.R.W.C.T. - DEED RECORDS, WILLIAMSON COUNTY, TEXAS

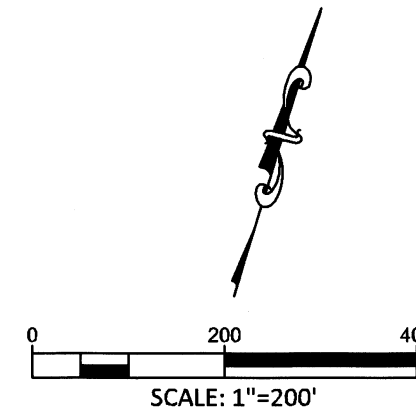

FLOOD PLAIN NOTE: PORTIONS OF THE TRACT SHOWN HEREON DO NOT LIE WITHIN ZONE "AE" AS IDENTIFIED BY THE FEDERAL EMERGENCY MANAGEMENT AGENCY, FEDERAL INSURANCE ADMINISTRATION, AS SHOWN ON MAP NO. FM48491C0325E, DATED SEPTEMBER 26, 2008 FOR WILLIAMSON COUNTY, TEXAS AND INCORPORATED AREAS.

WARNING: IF THIS SITE IS NOT WITHIN AN IDENTIFIED SPECIAL FLOOD HAZARD AREA, THIS FLOOD STATEMENT DOES NOT IMPLY THAT THE PROPERTY AND/OR STRUCTURES THEREON WILL BE FREE FROM FLOODING OR FLOOD DAMAGE. THIS FLOOD STATEMENT SHALL NOT CREATE LIABILITY ON THE PART OF THE SURVEYOR.

BEARINGS SHOWN HEREON ARE BASED ON THE NORTH LINE OF THE 20.00 BLAKELY TRACT OF RECORD IN DOCUMENT No.2008003802 O.P.R.W.C.T.

A METES AND BOUNDS DESCRIPTION OF EVEN DATE ACCOMPANIES THIS 10.000 ACRE SURVEY PLAT.

THIS SURVEY WAS PERFORMED WITHOUT THE BENEFIT OF A COMMITMENT FOR TITLE INSURANCE. NO ADDITIONAL RESEARCH WAS PERFORMED BY THIS SURVEYOR. THERE MAY BE ADDITIONAL EASEMENTS, ENCUMBRANCES, OR RESTRICTIONS THAT MAY AFFECT THE PROPERTY SHOWN HEREON.

THIS 10.000 ACRE DIVISION OF LAND WAS APPROVED BY WILLIAMSON COUNTY THROUGH JOE ENGLAND, P.E., ON OCTOBER 19, 2015.

I, TRAVIS S. TABOR, REGISTERED PROFESSIONAL LAND SURVEYOR, DO HEREBY CERTIFY THAT THE PLAT SHOWN HEREON IS CORRECT TO THE BEST OF MY BELIEF AND IS BASED ON A SURVEY MADE ON THE GROUND AND PERFORMED UNDER MY SUPERVISION DURING THE MONTH OF NOVEMBER, 2015.

TRAVIS S. TABOR
REGISTERED PROFESSIONAL LAND SURVEYOR
STATE OF TEXAS - NO. 6428

11/02/2015

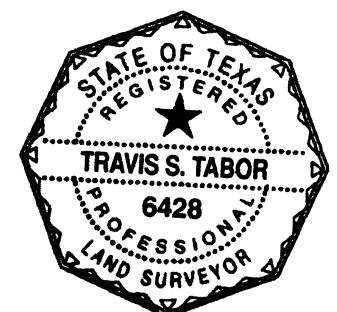

SURVEY PLAT SHOWING
10.000 ACRES IN THE
GERMAN EMIGRATION CO. SURVEY,
ABSTRACT No.698
WILLIAMSON COUNTY, TEXAS

STEGER BIZZELL

ADDRESS	1978 S. AUSTIN AVENUE	GEORGETOWN, TX 78626
METRO	512.930.9412	TEXAS REGISTERED ENGINEERING FIRM F-181 TBPLS FIRM No.10003700
SERVICES	>>ENGINEERS	>>PLANNERS >>SURVEYORS

DRAWN BY:

REVIEWED BY:

APPROVED BY: