

# Soil Map

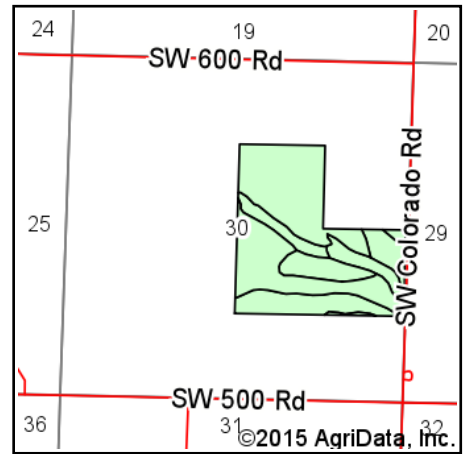

State: **Kansas**  
 County: **Anderson**  
 Location: **30-22S-18E**  
 Township: **Indian Creek**  
 Acres: **120.7**  
 Date: **11/10/2015**

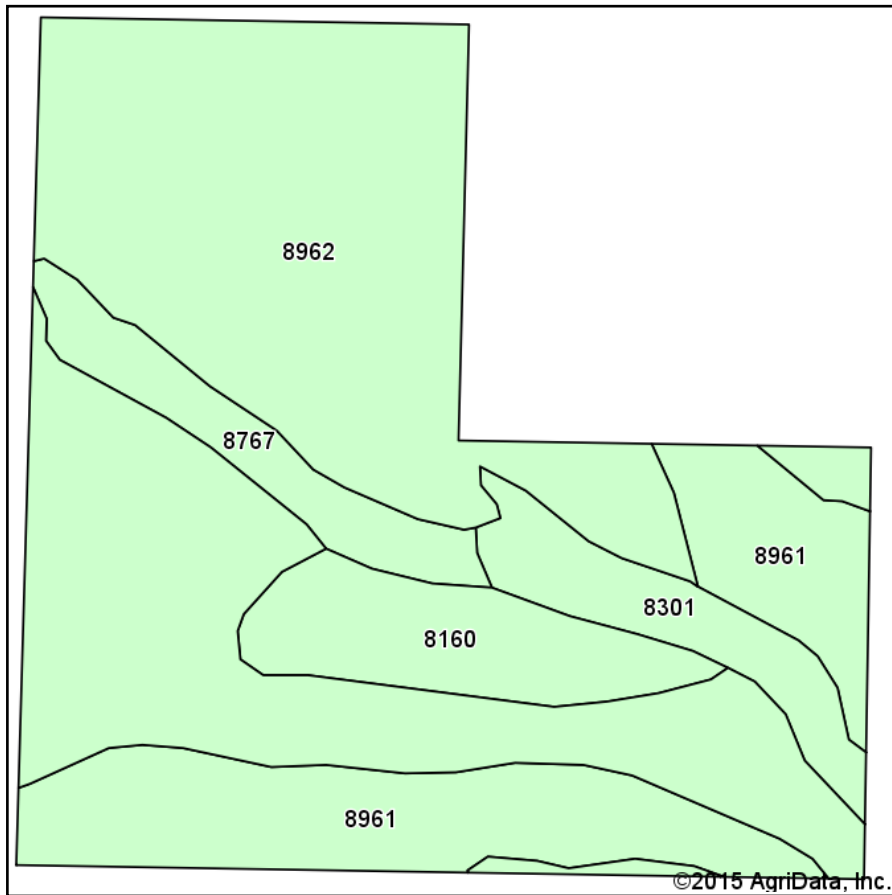

Maps Provided By:



## Area Symbol: KS003, Soil Area Version: 14

Code	Soil Description	Acres	Percent of field	Non-Irr Class *c	Range Production (lbs/acre/yr)	Grain sorghum	Winter wheat
8962	Woodson silt loam, 1 to 3 percent slopes	73.53	60.9%	IIs	4500		
8961	Woodson silt loam, 0 to 1 percent slopes	23.61	19.6%	IIs	4250		
8160	Leanna silt loam, occasionally flooded	9.67	8.0%	IIw	7944	85	33
8301	Verdigris silt loam, 0 to 1 percent slopes, frequently flooded	7.15	5.9%	Vw	8126		
8767	Eram-Verdigris complex, 0 to 8 percent slopes	6.74	5.6%	IVe	5321		
<b>Weighted Average</b>					<b>4987.7</b>	<b>6.8</b>	<b>2.6</b>

Area Symbol: KS003, Soil Area Version: 14

\*c: Using Capabilities Class Dominant Condition Aggregation Method

Soils data provided by USDA and NRCS.