

Soil Map

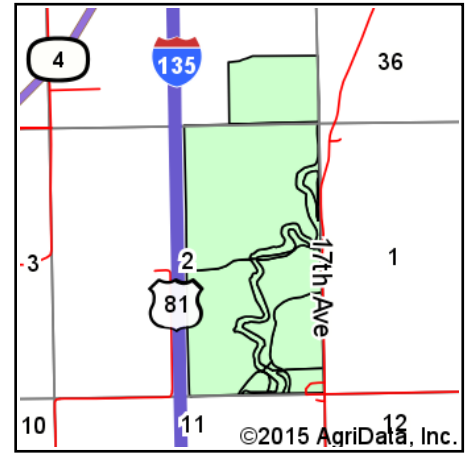

State: **Kansas**
 County: **McPherson**
 Location: **2-17S-3W**
 Township: **Smoky Hill**
 Acres: **374.51**
 Date: **8/28/2015**

Maps Provided By:

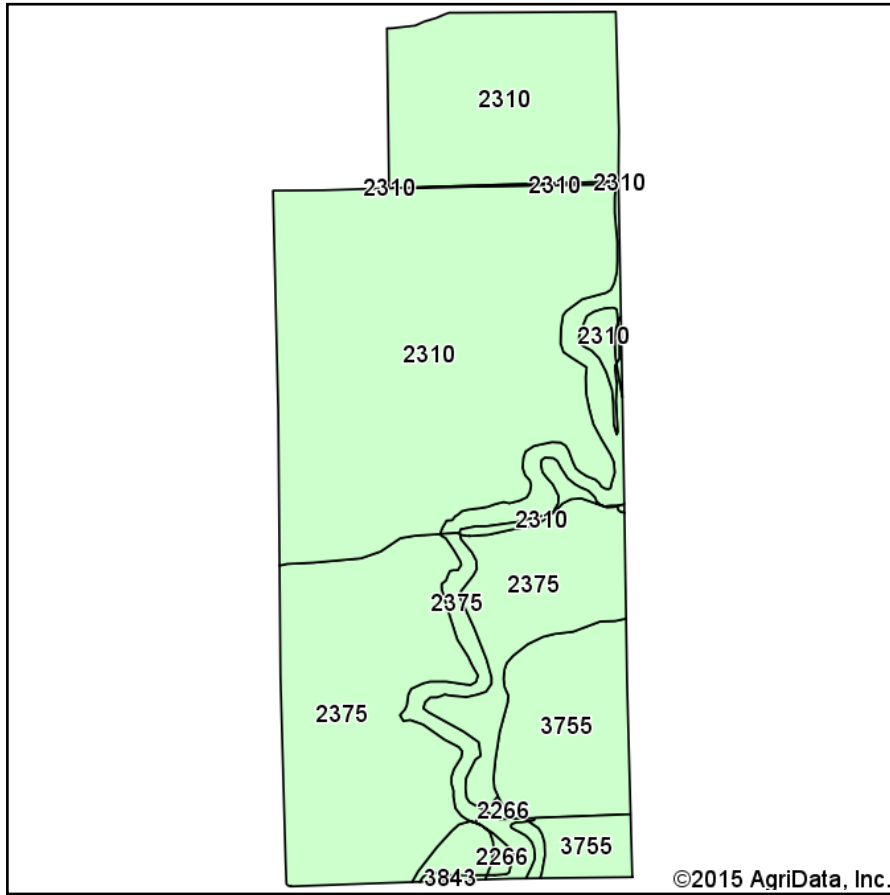

Area Symbol: KS113, Soil Area Version: 12

Area Symbol: KS169, Soil Area Version: 11

| Code | Soil Description | Acres | Percent of field | Non-Irr Class *c | Irr Class *c | Grain sorghum | Winter wheat |
|-------------------------|--|--------|------------------|------------------|--------------|---------------|--------------|
| 2310 | Bridgeport silt loam, rarely flooded | 160.54 | 42.9% | IIc | I | | |
| 2375 | Roxbury silt loam, rarely flooded | 113.57 | 30.3% | I | | 60 | 40 |
| 2310 | Bridgeport silt loam, rarely flooded | 52.77 | 14.1% | IIc | I | | |
| 3755 | Hord silt loam, rarely flooded | 38.44 | 10.3% | IIc | I | | |
| 2266 | Tobin silt loam, occasionally flooded | 4.86 | 1.3% | IIw | | 64 | 41 |
| 3843 | Geary silt loam, 1 to 3 percent slopes | 4.33 | 1.2% | Ile | Ile | | |
| Weighted Average | | | | | | 19 | 12.7 |

Area Symbol: KS113, Soil Area Version: 12

Area Symbol: KS169, Soil Area Version: 11

*c: Using Capabilities Class Dominant Condition Aggregation Method

Soils data provided by USDA and NRCS.