

# Soil Map

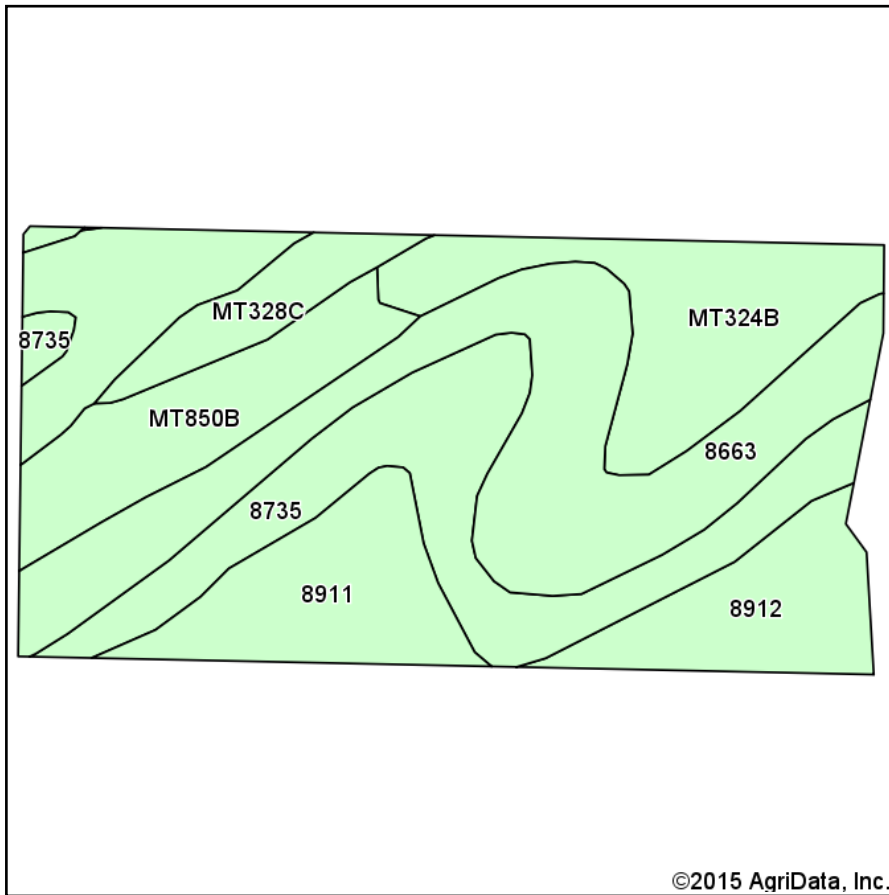

Soils data provided by USDA and NRCS.

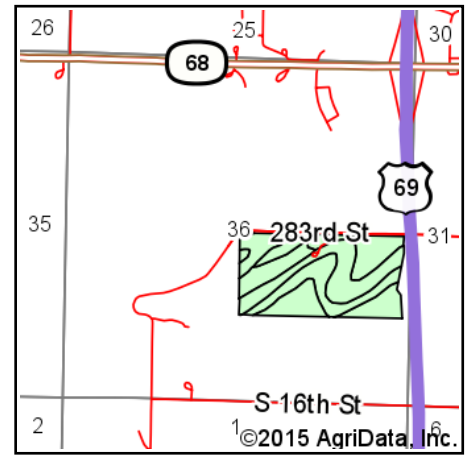

State: **Kansas**  
 County: **Miami**  
 Location: **36-16S-24E**  
 Township: **Wea**  
 Acres: **72.4**  
 Date: **4/13/2015**



Maps Provided By:

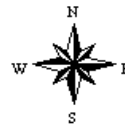

## Area Symbol: KS121, Soil Area Version: 15

Code	Soil Description	Acres	Percent of field	Non-Irr Class	Range Production (lbs/acre/yr)	Tall fescue	Improved bermudagrass	Warm season grasses	Winter wheat
8663	Clareson-Rock outcrop complex, 3 to 15 percent slopes	24.00	33.1%	Vls	3000	3			
8735	Eram silty clay loam, 3 to 7 percent slopes	13.72	19.0%	IVe	4200	5	6		
MT324B	Bucyrus silty clay loam, 1 to 3 percent slopes	10.28	14.2%	Ile	6400			8	51
8911	Summit silty clay loam, 1 to 3 percent slopes	7.53	10.4%	Ile	4875				
MT850B	Wagstaff silty clay loam, 1 to 3 percent slopes	7.33	10.1%	IIle	6400			8	31
8912	Summit silty clay loam, 3 to 7 percent slopes	6.31	8.7%	IIle	5250				
MT328C	Bucyrus silty clay loam, 3 to 8 percent slopes	3.23	4.5%	IIle	0			8	51
<b>Weighted Average</b>					<b>4311.7</b>	<b>1.9</b>	<b>1.1</b>	<b>2.3</b>	<b>12.7</b>

Area Symbol: KS121, Soil Area Version: 15

Soils data provided by USDA and NRCS.