

Hampshire County Health Department On-Site Sewage Disposal System Inspection Form

Permit # **ST-14-09-104**

Name of Owner: Scott & Jacqueline Taylor Installer: Walter Fields
Address: 11214 Lakeview Dr, Dunkirk, Md 20754
Property Location: Orchard Point Lot D Lot Size: 24AC Acres
Type of Facility: Residence Facility is: ☒ New ☐ Existing
Design Loading in gpd/# Bedrooms: 5 Source of Water: Proposed Well

SEWAGE TANK COMPONENT

Capacity in Gallons: 1500 Material: precast concrete Pump Chamber gal.
Distances (in feet) of Tank to: Dwelling
Private ☐ Public ☐ Water Source: Property Line: > 100'

ON-SITE DISPOSAL SYSTEM

Class I Systems: Standard Soil Trenches () or Bed () Gravelless Pipe (), Diameter In.
Chamber Soil Absorption Trenches (X) or Bed ()
Class II Systems: Pumped/Dosed Soil Absorption Trenches () or Bed () LPP ()
Evapotranspiration Trenches () or Bed ()
Shallow Soil Absorption Trenches () or Bed () Other:

No. of Lines: 5 Length (in feet) of Each: 80'
Width of Trenches: 36 inches/feet Depth to Bottom of Field: 18-24 inches
If Bed, Dimensions (in feet): Size Equates to 2000 sq ft of SGF
Distance (in feet) of System to: Dwelling
Private () Public () Water Source: Property Line: > 100'
Remarks: Dwelling and well not constructed at time of inspection S/D Road

GPS: N39 29 39.3 W78 34 18.1

An inspection indicates that
The sewage disposal system
Described above

DOES MEET ☒ X

DOES NOT MEET ☐ or

CANNOT BE DETERMINED TO

MEET ☐ the minimum standards
Established by the West Virginia
Bureau of Public Health.

To correct a health hazard,
Modifications to existing systems
May be done to improve part of a
System. Such modifications may
Not be able to be designated as
a Does meet system since
Inadequate information is known.

Although many factors
Contribute to the successful
Functioning of a sewage disposal
System, this office recommends
Water conservation and
Maintaining an even usage of
Water throughout the week.

Visit Date(s):

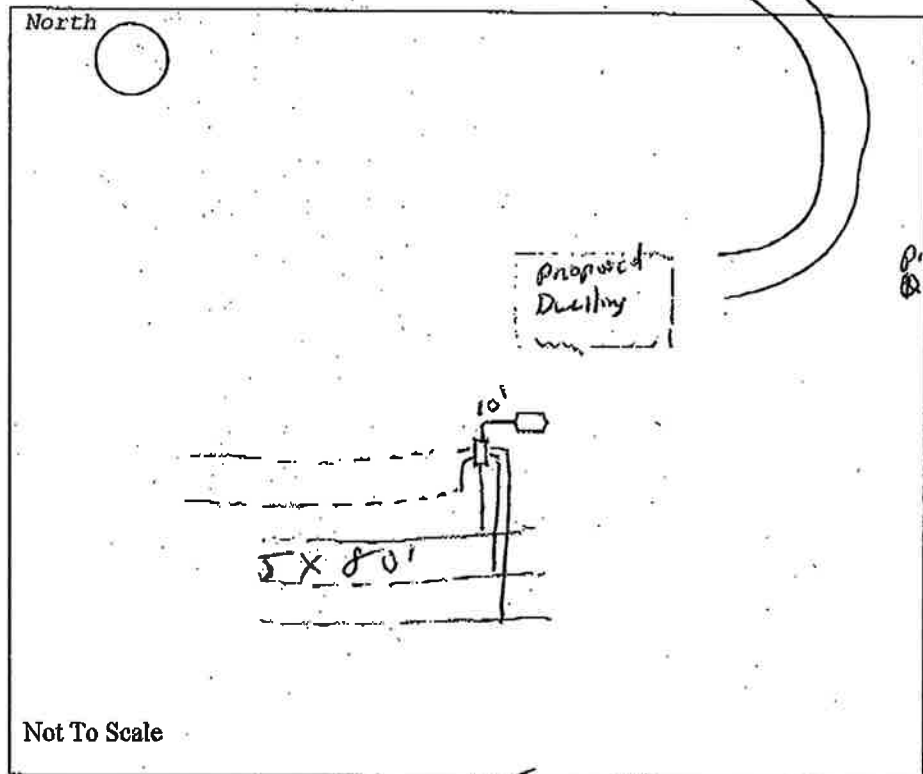

FINAL INSPECTION DATE: 3/24/2009

SANITARIAN: Walter Fields