

Soils Map-CSR2

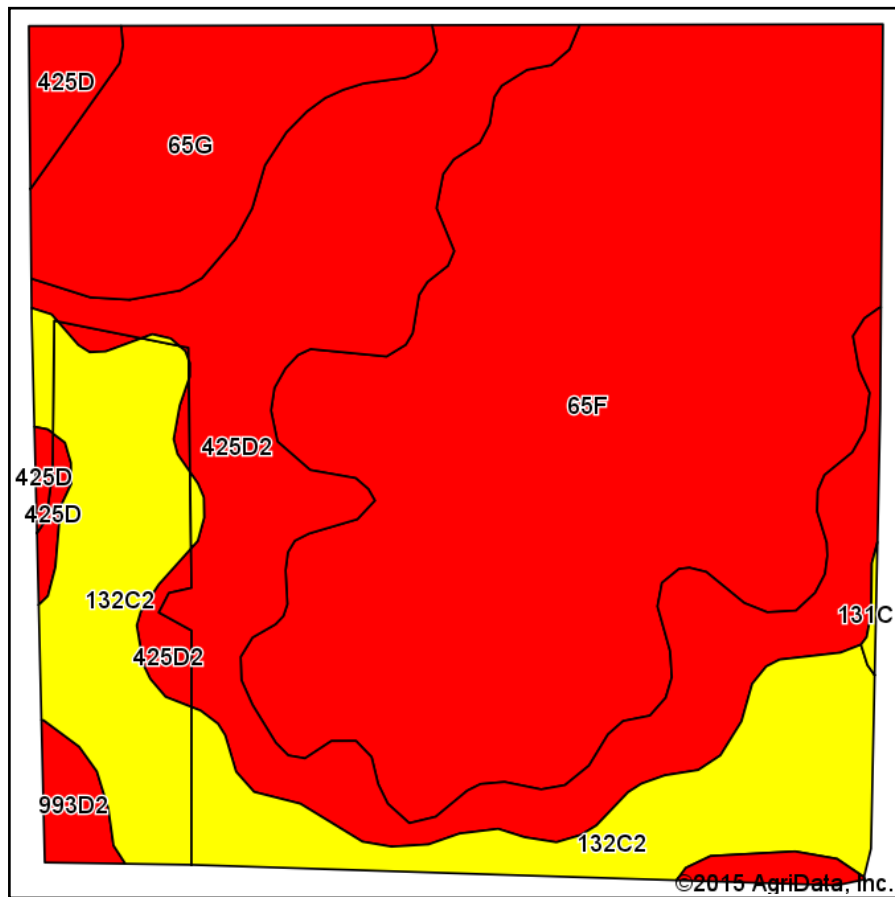

Soils data provided by USDA and NRCS.

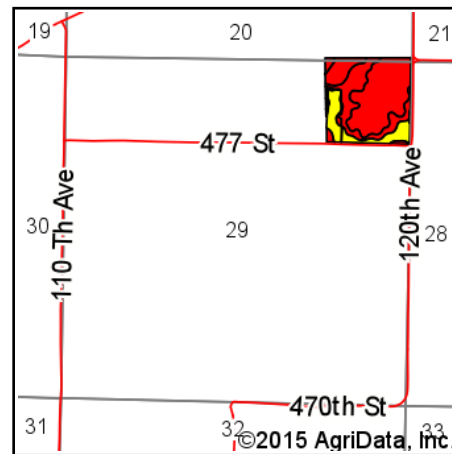

State: **Iowa**
 County: **Lucas**
 Location: **29-72N-23W**
 Township: **Jackson**
 Acres: **38.32**
 Date: **7/14/2015**



Maps Provided By:



Area Symbol: IA117, Soil Area Version: 22

Code	Soil Description	Acres	Percent of field	CSR2 Legend	Non-Irr Class *c	CSR2**	CSR
65F	Lindley loam, 18 to 25 percent slopes	18.03	47.1%		VIIe	14	10
425D2	Keswick clay loam, 9 to 14 percent slopes, moderately eroded	9.21	24.0%		IVe	5	12
132C2	Weller silty clay loam, 5 to 9 percent slopes, moderately eroded	6.64	17.3%		IIIe	62	40
65G	Lindley loam, 25 to 40 percent slopes	3.32	8.7%		VIIe	5	5
425D	Keswick loam, 9 to 14 percent slopes	0.71	1.9%		IVe	5	16
993D2	Gara-Armstrong complex, 9 to 14 percent slopes, moderately eroded	0.41	1.1%		IVe	30	31
Weighted Average						19.4	15.6

Area Symbol: IA117, Soil Area Version: 22

**IA has updated the CSR values for each county to CSR2.

*c: Using Capabilities Class Dominant Condition Aggregation Method

Soils data provided by USDA and NRCS.