



LA - Richland Poverty Point Reservoir Lot 13

0.44 Acres
W \$60000.0

Brown Realty Co

Richard Lemoine

(318) 669-3414

rlemoine@brownrealtyco.com

<http://www.brownrealtyco.com/>

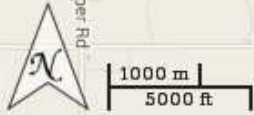
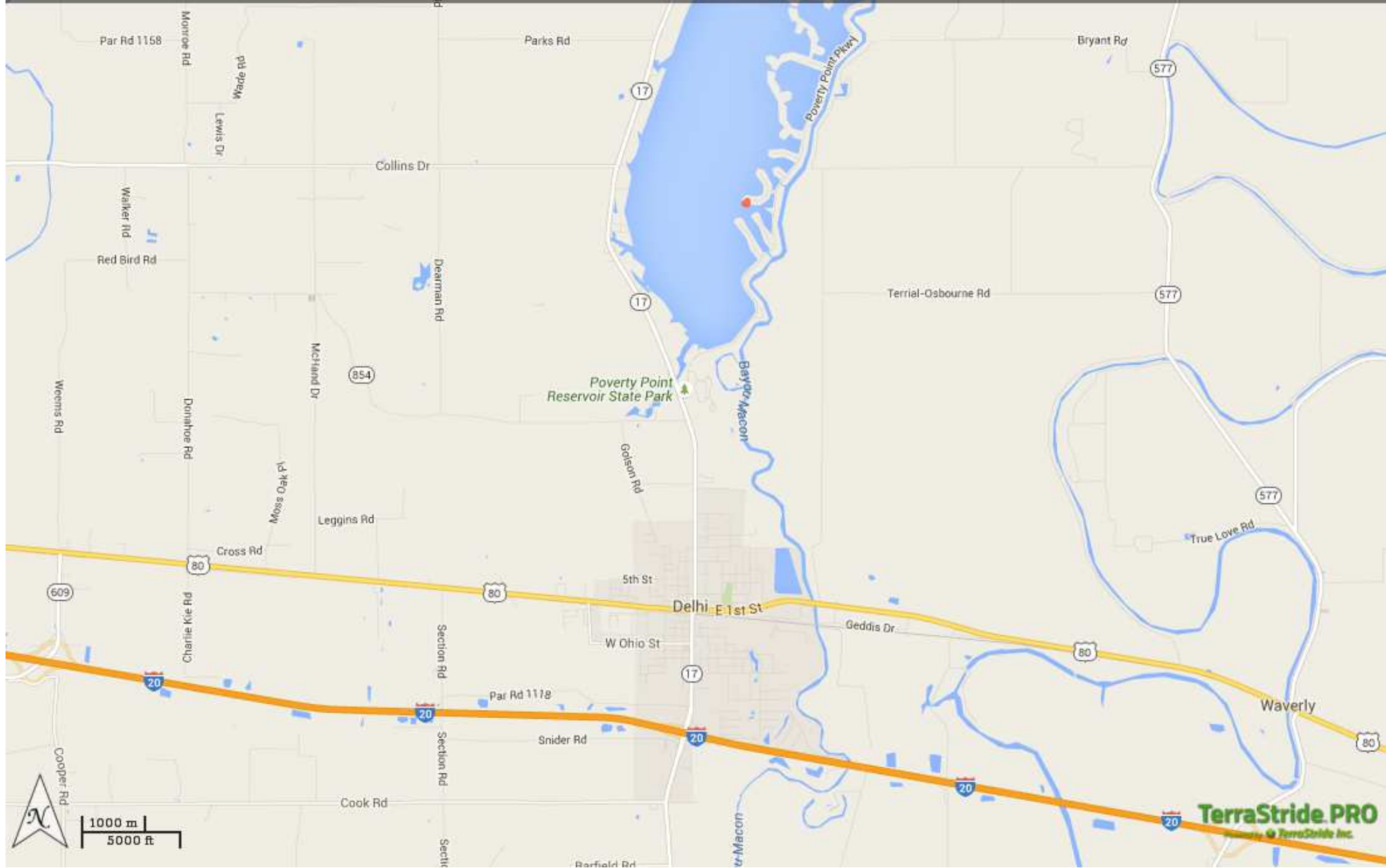

Property Report—LA - Richland Poverty Point Reservoir Lot 13

Legend

Feature	Icon	Colors
Boundary		

Description

Beautiful lake lot on Poverty Point Reservoir in Settler's Point Subdivision. Poverty Point is one of the premier fishing and boating destinations in Northeast LA. The subdivision is nestled within the confines of Poverty Point Reservoir State Park. This is one of the larger lots in the subdivision, measurements indicate approximately 0.4 acre; lake frontage at 136 feet. Any construction is subject both Lake Commission and Settler's Subdivision restrictions. Come build your new home and don't forget to include a nice boat house in your budget. Delhi is convenient to Monroe shopping and the casinos at Vicksburg. Also nearby are the Tensas River NWR and the Poverty Point World Heritage Site at Epps. Brown Realty Co. Jerry Brown, Broker 2189 Hwy 425 Rayville, LA 71269 318.728.9544

DISCLAIMER: The information contained herein is as obtained by this broker from sellers, owners, or other sources. This information is considered reliable, neither this broker nor owners make any guarantee, warranty or representation as to correctness of any data or descriptions and the accuracy of such statements. The correctness and / or accuracy of any and all statements should be determined through independent investigation made by the prospective purchaser. Any offer for sale is subject to prior sale, errors and omissions, change of price, terms or other conditions or withdrawal from sale

Generated on: July 22, 2015