

# Soil Map

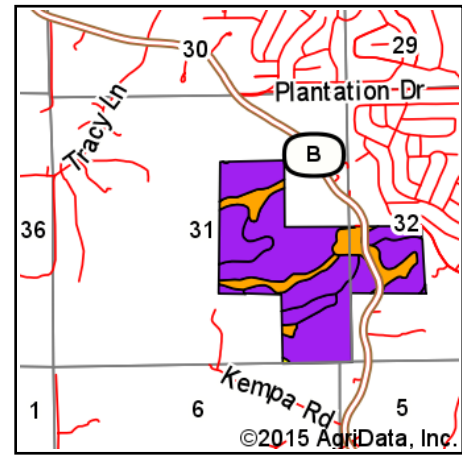

State: **Missouri**  
 County: **Jefferson**  
 Location: **31-41N-4E**  
 Township: **Central**  
 Acres: **200.8**  
 Date: **5/12/2015**

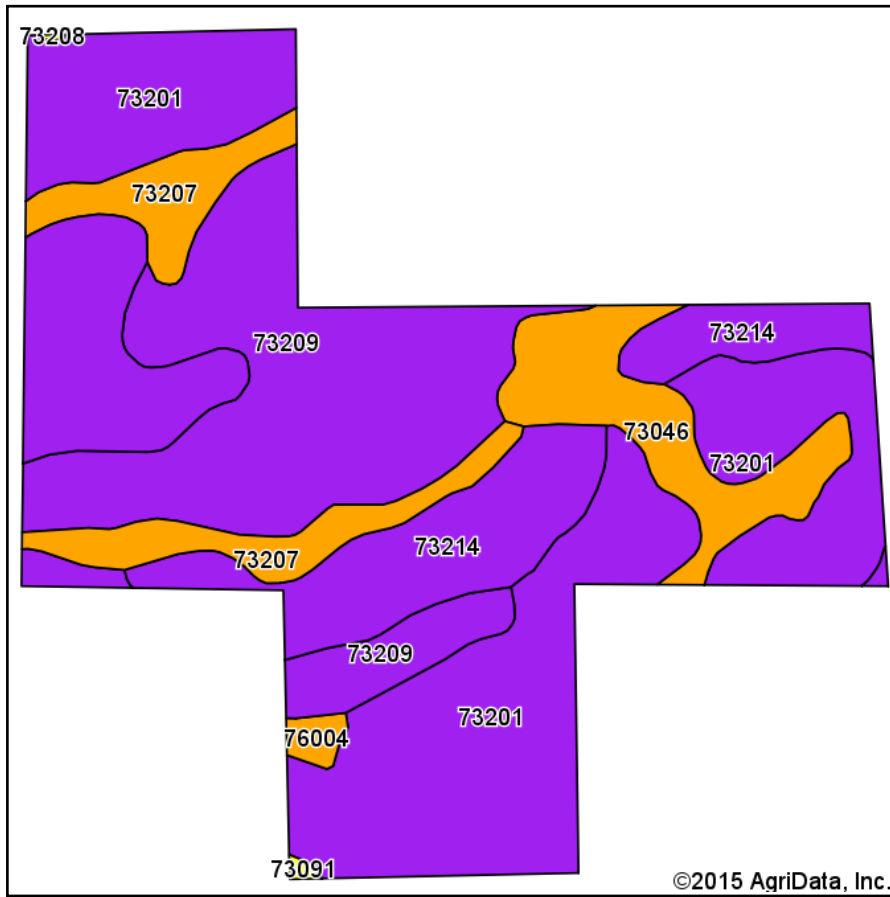

Trophy Properties  
and Auction  
Maps Provided By:



## Area Symbol: MO099, Soil Area Version: 15

Code	Soil Description	Acres	Percent of field	Non-Irr Class Legend	Soil Drainage	Non-Irr Class	NCCPI Overall
73201	Sonsac gravelly silt loam, 15 to 40 percent slopes, very stony	87.64	43.6%		Well drained	VIIs	6
73209	Caneyville silt loam, 15 to 30 percent slopes	54.21	27.0%		Well drained	VIIs	32
73214	Moko-Rock outcrop complex, 15 to 50 percent slopes, extremely stony	25.89	12.9%		Well drained	VIIIs	2
73207	Caneyville silt loam, 3 to 8 percent slopes	15.79	7.9%		Well drained	IIIs	52
73046	Wrengart silt loam, 3 to 8 percent slopes, eroded	15.66	7.8%		Moderately well drained	IIIe	57
76004	Bloomsdale silt loam, 1 to 3 percent slopes, frequently flooded	1.30	0.6%		Well drained	IIIw	68
73091	Useful silt loam, 8 to 15 percent slopes, eroded	0.25	0.1%		Moderately well drained	IVe	43
73208	Caneyville silt loam, 8 to 15 percent slopes	0.06	0.0%		Well drained	IVs	50
<b>Weighted Average</b>							<b>20.6</b>

Area Symbol: MO099, Soil Area Version: 15

Soils data provided by USDA and NRCS.