

REC'D June 24, 2005 at 10:35 A.M.
RECORDED: VOL. 14 SURVEY MAPS PAGE 180
JAMES M. MRDUTT, REG OF DEEDS, DUNN CO. WI

DUNN CO. SURVEYOR
DUNN CO. REAL PROPERTY
DATE 6/23/2005

APPROVED
YES ☒ NO ☐

524362 CERTIFIED SURVEY MAP NO. 3200
VOLUME 14 PAGE 180

LOCATED IN THE SW 1/4 OF THE SW 1/4 OF SECTION 23, T.29N., R.11W.,
BEING LOTS 1 AND 2 OF CERTIFIED SURVEY MAP NUMBER 3115 AND
LOT 1 OF CERTIFIED SURVEY MAP NUMBER 2993, ALL IN THE TOWN OF COLFAX,
DUNN COUNTY, WISCONSIN

SOUTHWEST CORNER
SECTION 23 - FOUND
ALUMINUM CAP MONUMENT

(2632.29')
2632.56'

UNPLATTED LANDS

WEST LINE OF THE SW 1/4
N 01°49'17" W 944.70'
N 01°49'17" W 371.58'
S 01°49'17" E 1316.28' (1316.14')
S 01°49'00"E

WEST QUARTER CORNER
SECTION 23 - FOUND
ALUMINUM MONUMENT

NOTE: EASEMENT DESCRIPTIONS
SHOULD BE INCLUDED WITH ANY
CONVEYANCE OF LOTS 4 AND 5.

PREPARED FOR:
LARRY PAUL

UNPLATTED LANDS

UNPLATTED
LANDS

Page 180A

- LEGEND**
- = SET 1" O.D. X 18" IRON PIPE WEIGHING 1.13 LBS. PER LINEAR FOOT
 - = FND. 1" O.D. IRON PIPE
 - = FND. 3/4" IRON REBAR
 - ⊙ = GOVERNMENT CORNER AS NOTED
 - () = RECORD DATA
 - x = EXISTING POWER POLE

NOTE: THE STATUTORY CENTER OF SECTION WAS
DETERMINED AND UTILIZED FOR THIS SURVEY. AN
ALUMINUM MONUMENT WAS FOUND N89°40'54"W,
23.84' FROM THE STATUTORY CENTER OF SECTION.

NOTE: RIGHT OF WAY FOR THIS CERTIFIED SURVEY MAP WAS
DETERMINED BY CERTIFIED SURVEY MAP NUMBER 2633, DATED
AUGUST 2002. CERTIFIED SURVEY MAP NUMBER 2993, DATED
MARCH 2004, SHOWS IRON REBAR SET ON THE WESTERLY
RIGHT OF WAY LINE OF 940TH AVENUE. MATCHING BEARINGS
FROM CERTIFIED SURVEY MAP NUMBER 2633 TO THE IRON
REBAR WERE FOUND TO BE ERRONEOUSLY SET AND ARE
REFERENCED AS SHOWN.

BEARINGS REFERENCED TO THE WEST
LINE OF THE SW 1/4 OF SECTION 23,
MEASURED AS N01°49'17"W (DUNN
CO. COORD. SYSTEM - NAD 83(91)).

1"=200'
0 100 200 400

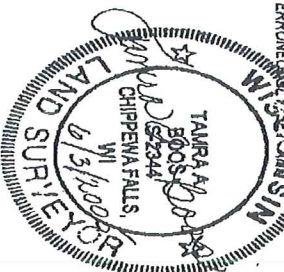

NO. 2633

SHEET 1 OF 2

© NELSEN LAND SURVEYING, INC. 2005

CERTIFIED SURVEY MAP NO. 3200
VOLUME 14 PAGE 180

LOCATED IN THE SW 1/4 OF THE SW 1/4 OF SECTION 23, T.29N., R.11W.,
BEING LOTS 1 AND 2 OF CERTIFIED SURVEY MAP NUMBER 3115 AND
LOT 1 OF CERTIFIED SURVEY MAP NUMBER 2993, ALL IN THE TOWN OF COLFAX,
DUNN COUNTY, WISCONSIN

CURVE TABLE

CURVE	RADIUS	LENGTH	DELTA	CHORD	CH. BEARING	TANGENT BEARINGS
1-2	310.00'	200.41'	37°02'24"	196.93'	S 17°11'05" W	AT 1= S35°42'17"W AT 2= S01°20'07"E

SURVEYOR'S CERTIFICATE

I, Tamra A. Boos, Registered Wisconsin Land Surveyor, do hereby certify:

That I have surveyed, divided and mapped a parcel of land located in the Southwest 1/4 of the Southwest 1/4 of Section 23, Township 29 North, Range 11 West of the 4th Principal Meridian, being Lots 1 and 2 of Certified Survey Map Number 3115 and Lot 1 of Certified Survey Map Number 2993, all in and forming a part of the Town of Colfax, Dunn County, Wisconsin, more particularly described as follows:

Commencing at the Southwest Corner of said Section 23;

thence, along the west line of said Southwest 1/4, North 01°49'17" West, 944.70 feet to the southwest corner of said Lot 1 of Certified Survey Map Number 3115 and the POINT OF BEGINNING;

thence, along said west line, North 01°49'17" West, 371.58 feet to the northwest corner of said Southwest 1/4 of the Southwest 1/4;

thence, along the north line of said Southwest 1/4 of the Southwest 1/4, North 89°33'39" East, 1316.56 feet to the northeast corner of said Southwest 1/4 of the Southwest 1/4;

thence, along the east line of said Southwest 1/4 of the Southwest 1/4, South 01°36'28" East, 455.63 feet to the southeast corner of said Lot 1 of Certified Survey Map Number 2993;

thence, along the south line of said Lot 1 and the south line of said Lot 2 of Certified Survey Map Number 3115, South 89°33'50" West, 727.81 feet;

thence, along the westerly line of said Lot 2, North 08°55'30" East, 32.07 feet to the southeast corner of said Lot 1 of Certified Survey Map Number 3115;

thence, along the southerly line of said Lot 1, North 85°24'05" West, 596.60 feet to the point of beginning.

Containing 565,116 square feet or 12.97 acres. Subject to a 66' wide access easement as shown on map. Together with a 66' wide access easement as shown on Certified Survey Map Number 3115. Also subject to any and all other easements, reservations, restrictions and conveyances of record.

That I have made such survey, land division and map by the direction of Larry Paul.

That such map is a correct representation of the exterior boundaries of the land surveyed and the division of that land.

That I have fully complied with the provisions of Chapter 236.34 of the Wisconsin Statutes and the provisions of the Dunn County Subdivision Ordinance.

Tamra A. Boos
Tamra A. Boos, S-2344

June 3, 2005

NELSEN LAND SURVEYING, INC.



Approved by the Dunn County Zoning Office this 8th day of June, 2005.

Cleo Herick, Act. Zoning Off.
SHEET 2 OF 2

Page 180B