

# NOTICE OF LAND SALE - #4492

## "DeGray Creek Tract"

E½ of SW¼, Sec. 27, T6S, R20W

Clark County, Arkansas

### Directions from Arkadelphia from Exit 73 of I-30:

At Arkadelphia head West from I-30 (exit 73) on Hwy 8 (Pine Street) for 2.2 miles. Turn RIGHT (North) on DeGray Road. Continue for 3 miles, turn RIGHT onto Bledsoe Road. Proceed 0.6 mile to Lower Lake Road. Turn RIGHT (East) onto Lower Lake Road, continue for 0.5 miles. Turn LEFT (North) onto Eagle Drive, continue to yield sign and turn RIGHT (East) on Mosley Road. Continue for 0.25 of a mile. Turn LEFT (North) onto Lookadoo Road. Proceed 0.25 of a mile, cross bridge. Turn LEFT (West) onto Trimble Road. Public access is at end of Trimble Road (signs and flagging at property line).

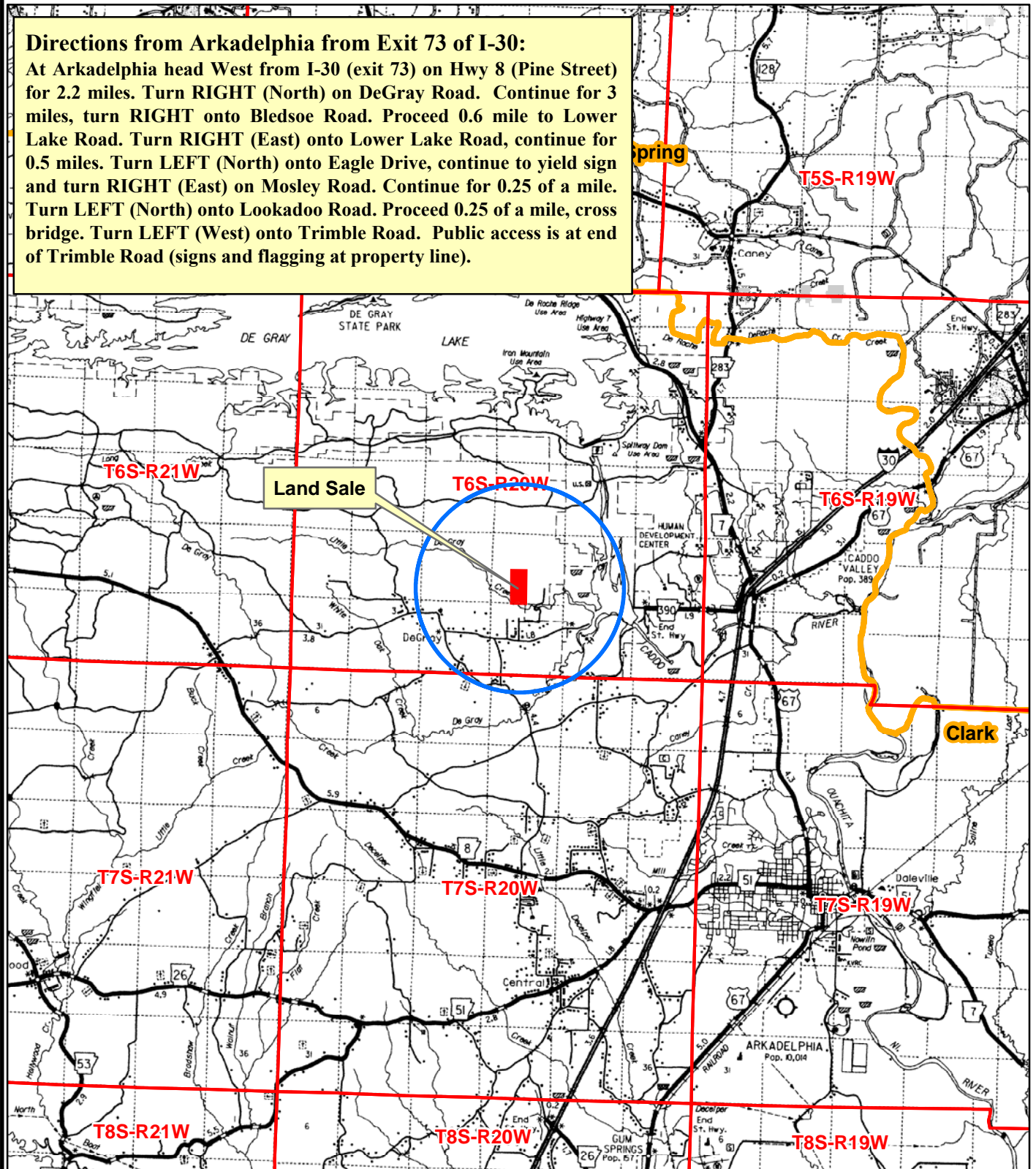

0 0.5 1 2 3 4  
Miles



Created: March, 2015  
ESRI Aerial Photography  
By: JBK