

Soils Map-CSR2

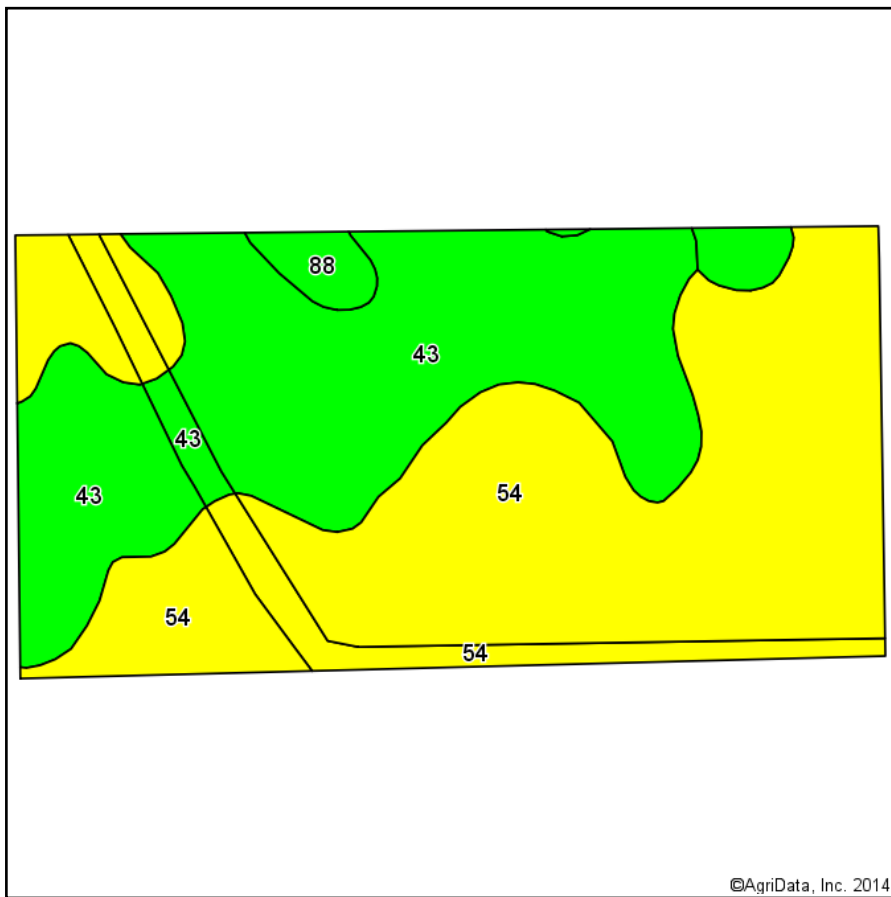

Soils data provided by USDA and NRCS.

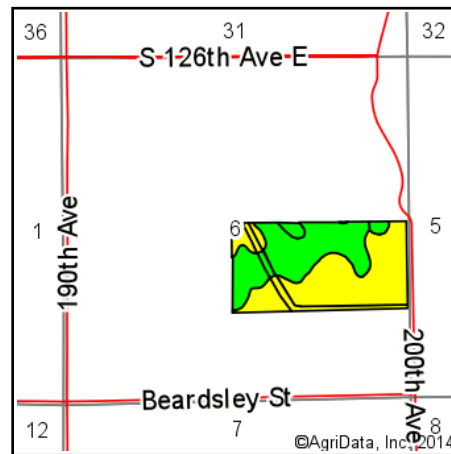

State: **Iowa**
 County: **Marion**
 Location: **6-77N-18W**
 Township: **Lake Prairie**
 Acres: **78.7**
 Date: **1/20/2015**

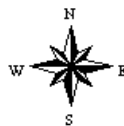

Area Symbol: IA125, Soil Area Version: 23

| Code | Soil Description | Acres | Percent of field | **CSR2 Legend | Non-Irr Class | CSR2** | CSR |
|------------------|---|-------|------------------|---------------|---------------|--------|------|
| 54 | Zook silty clay loam, 0 to 2 percent slopes | 44.47 | 56.5% | | Ilw | 69 | 70 |
| 43 | Bremer silty clay loam, 0 to 2 percent slopes | 31.68 | 40.3% | | Ilw | 78 | 82 |
| 88 | Nevin silty clay loam, 0 to 2 percent slopes | 2.55 | 3.2% | | I | 95 | 90 |
| Weighted Average | | | | | | 73.5 | 75.5 |

Area Symbol: IA125, Soil Area Version: 23

**IA has updated the CSR values for each county to CSR2.

Field borders provided by Farm Service Agency as of 5/21/2008. Aerial photography provided by Aerial Photography Field Office.