

Form : FSA-156EZ

United States Department of Agriculture
Farm Service Agency

Program Year : 2015

Date : Jan 26, 2015

See Page 2 for non-discriminatory Statements.

Abbreviated 156 Farm Record

State : TEXAS

County : COLLINGSWORTH

Farm Number : 2982

Operator Name : DALE MILLER

Farms Associated with Operator : 48-191-374, 48-191-2495, 48-191-2554, 48-087-2982

CRP contract numbers : 823

Farm Land Data

Farm Land Data									
Farmland	Cropland	DCP Cropland	WBP	WRP	CRP	GRP	Farm Status		Number Of Tracts
317.19	127.31	127.31	0.00	0.00	0.00	0.00	Active		1
State Conservation	Other Conservation	Effective DCP Cropland	Double Cropped	MPL	FWP	FAV/WR History	Acre Election	EWP	DCP Ag. Related Activity
0.00	0.00	127.31	0.00	0.00	0.00	No	No	0.00	0.00

DCP Crop Data

Crop Name	Base Acres	CCC-505 CRP Reduction Acres	PTPP Reduction Acres	Direct Yield	Counter Cyclical Yield
Upland Cotton	36.00	0.00	0.00	260	260
TOTAL	36.00	0.00	0.00		

NOTES

State : TEXAS

County : COLLINGSWORTH

Farm Number : 2982

Tract Number : 2337

Description : W 1/2 Sec. 50, Blk. 19.

FAV/WR History : No

BIA Unit Range Number :

HEL Status : HEL field on tract.Conservation system being actively applied

Wetland Status : Tract does not contain a wetland

WL Violations :

Owners : DALE MILLER

Other Producers :

Tract Land Data

Tract Land Data							
Farm Land	Cropland	DCP Cropland	WBP	WRP	CRP	GRP	
317.19	127.31	127.31	0.00	0.00	0.00	0.00	
State Conservation	Other Conservation	Effective DCP Cropland	Double Cropped	MPL	FWP	EWP	DCP Ag. Related Activity
0.00	0.00	127.31	0.00	0.00	0.00	0.00	0.00

DCP Crop Data

Crop Name	Base Acres	CCC-505 CRP Reduction Acres	PTPP Reduction Acres	Direct Yield	Counter Cyclical Yield
Upland Cotton	36.00	0.00	0.00	260	260
TOTAL	36.00	0.00	0.00		

NOTES



Abbreviated 156 Farm Record

The U.S. Department of Agriculture (USDA) prohibits discrimination against its customers, employees, and applicants for employment on the basis of race, color, national origin, age, disability, sex, gender identity, religion, reprisal, and where applicable, political beliefs, marital status, familial or parental status, sexual orientation, or all or part of an individual's income is derived from any public assistance program, or protected genetic information in employment or in any program or activity conducted or funded by the Department. (Not all prohibited bases will apply to all programs and/or employment activities.) Persons with disabilities, who wish to file a program complaint, write to the address below or if you require alternative means of communication for program information (e.g., Braille, large print, audiotape, etc.) please contact USDA's TARGET Center at (202) 720-2600 (voice and TDD). Individuals who are deaf, hard of hearing, or have speech disabilities and wish to file either an EEO or program complaint, please contact USDA through the Federal Relay Service at (800) 877-8339 or (800) 845-6136 (in Spanish).

If you wish to file a Civil Rights program complaint of discrimination, complete the USDA Program Discrimination Complaint Form, found online at http://www.ascr.usda.gov/complaint_filing_cust.html, or at any USDA office, or call (866) 632-9992 to request the form. You may also write a letter containing all of the information requested in the form. Send your completed complaint form or letter by mail to U.S. Department of Agriculture, Director, Office of Adjudication, 1400 Independence Avenue, S.W., Washington, D.C. 20250-9410, by fax (202) 690-7442 or email at program.intake@usda.gov. USDA is an equal opportunity provider and employer.



Farm: 2982
Tract: 2337

Collingsworth County

Wetland Determination Identifiers

- Restricted Use
- ▽ Limited Restrictions
- ⊞ Exempt from Conservation Compliance Provisions

Wetland identifiers do not represent the size, shape, or specific determination of the area. Refer to your original determination (CPA-026 and attached maps) for exact wetland boundaries and labels, or contact NRCS.

Crop Year 2014

Map Created: November 06, 2013

0 320 640 Feet



Texas
Hall

Report ID: FSA-156EZ

U.S. Department of Agriculture
Farm Service Agency
Abbreviated 156 Farm Record

FARM: 2495

Prepared: 1/26/15 4:12 PM

Crop Year: 2015

Page: 5 of 5

DISCLAIMER: This is data extracted from the web farm database. Because of potential messaging failures in MIDAS, this data is not guaranteed to be an accurate and complete representation of data contained in the MIDAS system, which is the system of record for Farm Records.

Tract Number: 1793 Description: L2

BIA Range Unit Number:

HEL Status: HEL Determinations not complete

Wetland Status: Wetland determinations not complete

WL Violations: None

FAV/WR
History

N

Farmland	Cropland	DCP Cropland	WBP	WRP/EWP	CRP Cropland	GRP
1.52	1.52	1.52	0.0	0.0	0.0	0.0
State Conservation	Other Conservation	Effective DCP Cropland	Double Cropped	MPL/FWP		
0.0	0.0	1.52	0.0	0.0		

Owners: DALE MILLER

Other Producers: None

Tract Number: 1798 Description: 48-087

BIA Range Unit Number:

HEL Status: HEL: conservation system is being actively applied

Wetland Status: Tract does not contain a wetland

WL Violations: None

FAV/WR
History

N

Farmland	Cropland	DCP Cropland	WBP	WRP/EWP	CRP Cropland	GRP
321.89	130.62	130.62	0.0	0.0	0.0	0.0
State Conservation	Other Conservation	Effective DCP Cropland	Double Cropped	MPL/FWP		
0.0	0.0	130.62	0.0	0.0		

Crop	Base Acreage	Direct Yield	CC Yield	CCC-505 CRP Reduction
UPLAND COTTON	19.4	260	260	0.0
Total Base Acres:	19.4			

Owners: DALE MILLER

Other Producers: None

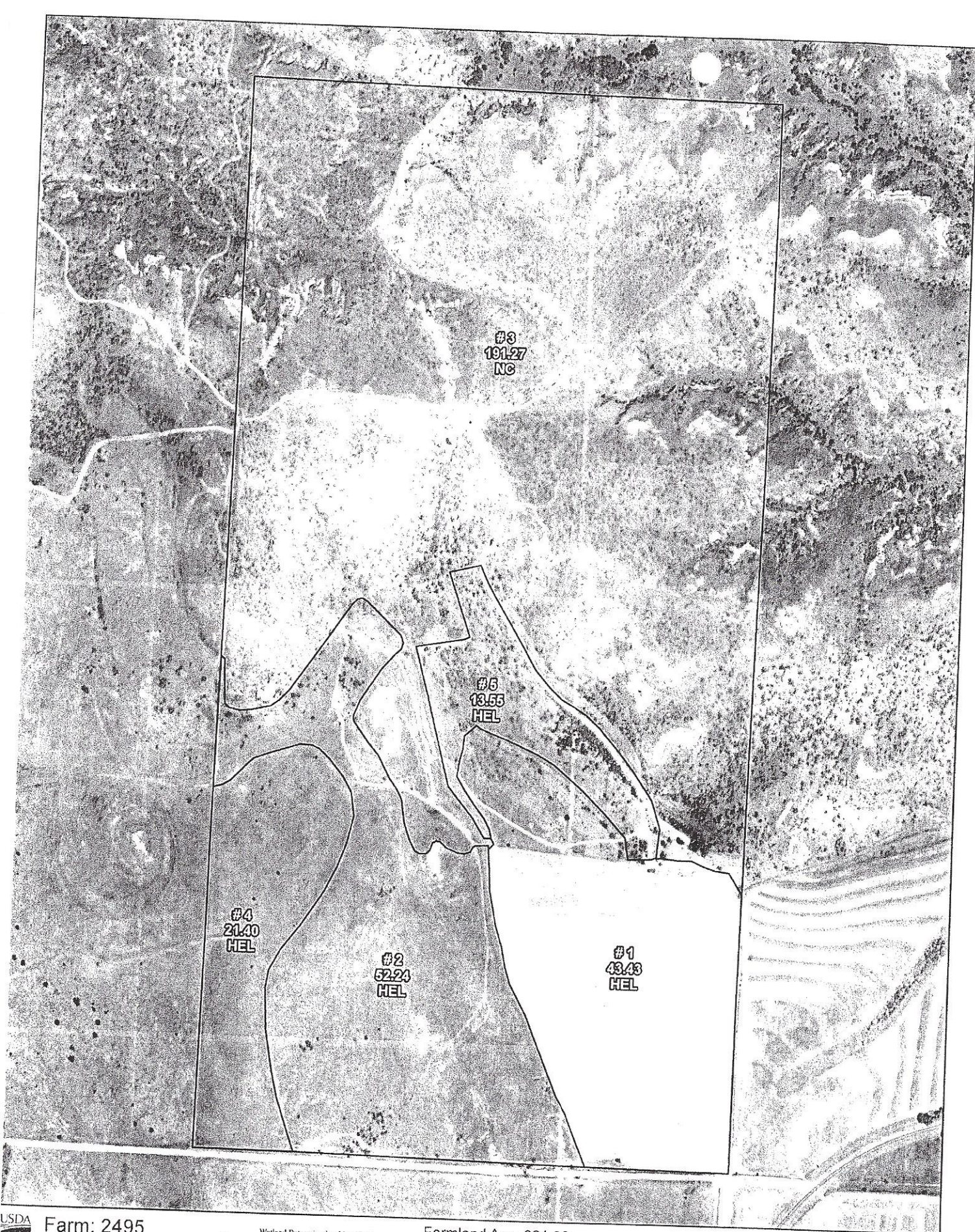

USDA Farm: 2495
 FSA Tract: 1798
 Hall County



Wetland Determination Identifiers
 • Restricted Use
 • Limited Restrictions
 • Exempt from Conservation Compliance Provisions

Wetland identifiers do not represent the size, shape, or specific determination of the area. Refer to your original determination (CPA-026 and attached maps) for exact wetland boundaries and labels, or contact NRCS.

Farmland Ac.: 321.89
 Cropland Ac.: 130.62

0 225 450 Feet

Crop Year:

Map Created: 02/08/2012