

Soil Map

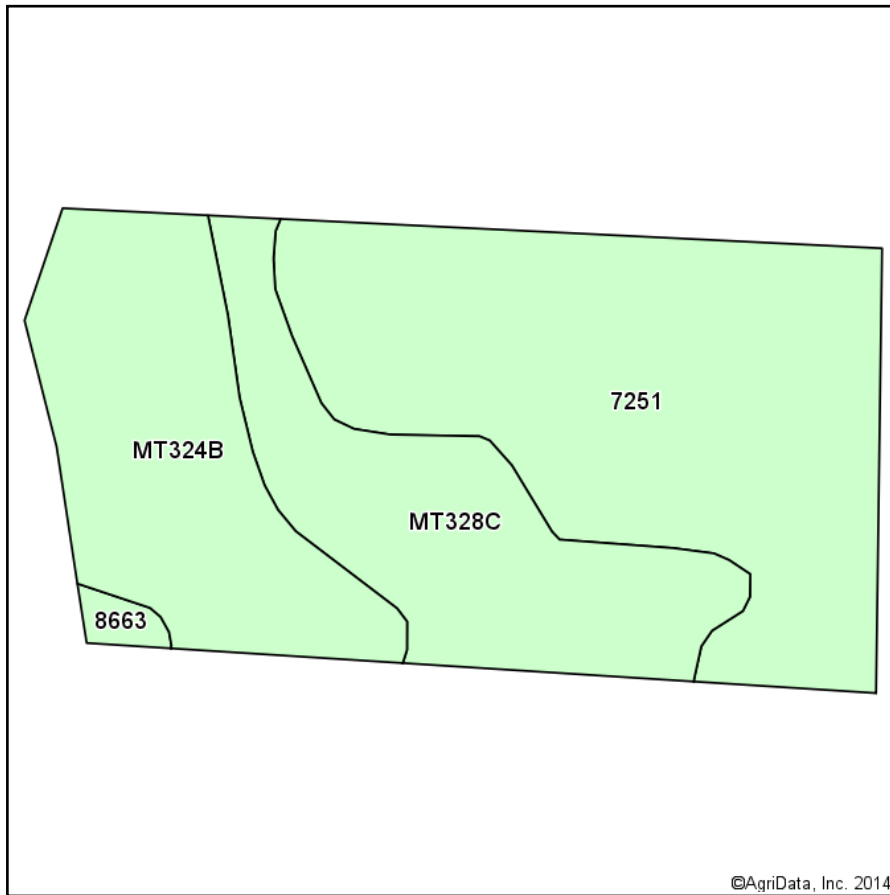

Soils data provided by USDA and NRCS.

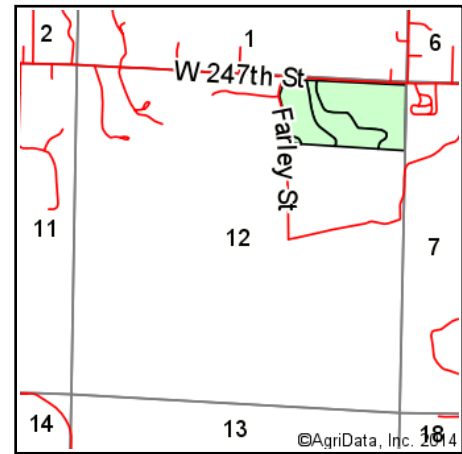

State: **Kansas**
 County: **Miami**
 Location: **12-16S-24E**
 Township: **Ten Mile**
 Acres: **46.69**
 Date: **10/30/2014**



Maps Provided By:

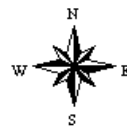

Area Symbol: KS121, Soil Area Version: 14

Code	Soil Description	Acres	Percent of field	Non-Irr Class	Range Production (lbs/acre/yr)	Brome grass alfalfa hay	Corn	Grain sorghum	Smooth brome grass	Soybeans	Winter wheat	Tall fescue	Warm season grasses
7251	Grundy silt loam, 1 to 3 percent slopes	23.04	49.3%	Ile	0	4	98	85	9	38	40		
MT324B	Bucyrus silty clay loam, 1 to 3 percent slopes	11.98	25.7%	Ile	6400						51		8
MT328C	Bucyrus silty clay loam, 3 to 8 percent slopes	11.17	23.9%	IIle	0						51		8
8663	Clareson-Rock outcrop complex, 3 to 15 percent slopes	0.50	1.1%	Vis	3000							3	
Weighted Average					1674.3	2	48.4	41.9	4.4	18.8	45	*~	4

Area Symbol: KS121, Soil Area Version: 14

Field borders provided by Farm Service Agency as of 5/21/2008. Aerial photography provided by Aerial Photography Field Office.