

Soil Map

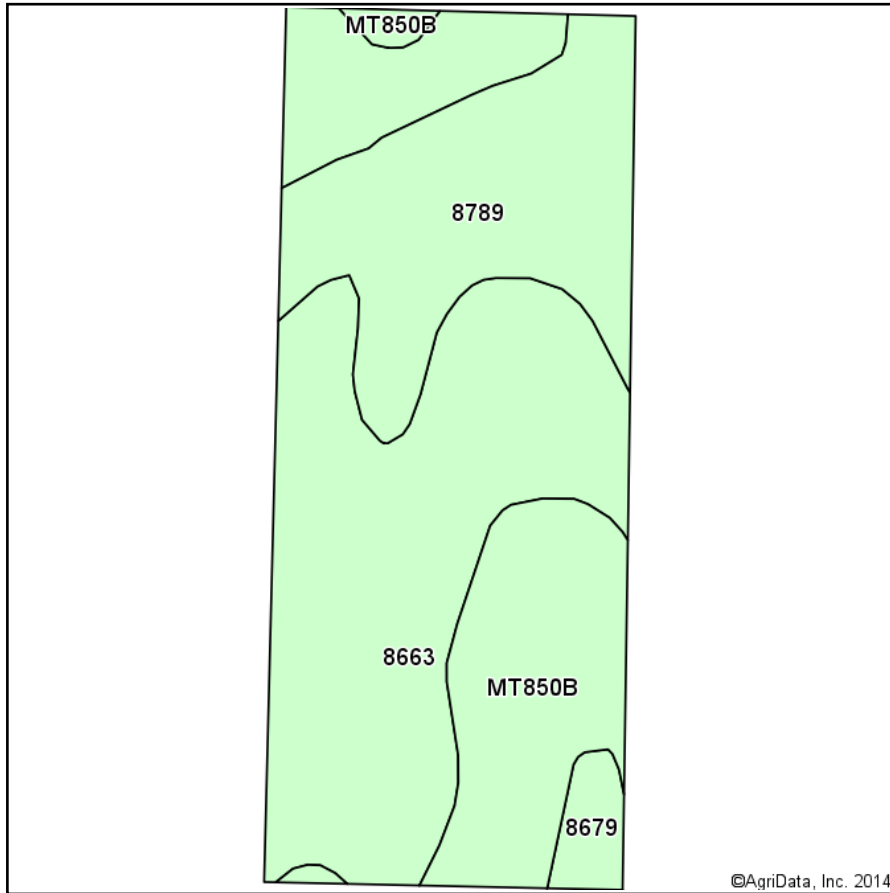

Soils data provided by USDA and NRCS.

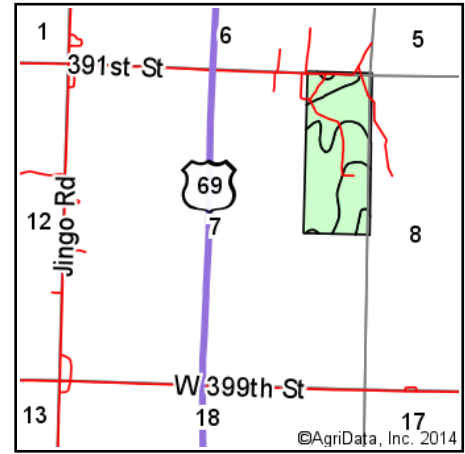

State: **Kansas**
 County: **Miami**
 Location: **7-19S-25E**
 Township: **Sugar Creek**
 Acres: **68.4**
 Date: **12/3/2014**

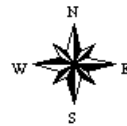

Maps Provided By:



Area Symbol: KS121, Soil Area Version: 15

Code	Soil Description	Acres	Percent of field	Non-Irr Class	Range Production (lbs/acre/yr)	Tall fescue	Smooth bromegrass	Warm season grasses	Winter wheat
8663	Clareson-Rock outcrop complex, 3 to 15 percent slopes	35.80	52.3%	Vis	3000	3			
8789	Lebo channery silty clay loam, 15 to 30 percent slopes	17.69	25.9%	Vle	5000	4	4		
MT850B	Wagstaff silty clay loam, 1 to 3 percent slopes	13.08	19.1%	Ille	6400			8	31
8679	Dennis silt loam, 1 to 3 percent slopes	1.83	2.7%	Ile	4950				
Weighted Average					4219.6	2.6	1	1.5	5.9

Area Symbol: KS121, Soil Area Version: 15

Field borders provided by Farm Service Agency as of 5/21/2008. Aerial photography provided by Aerial Photography Field Office.