

Soil Map

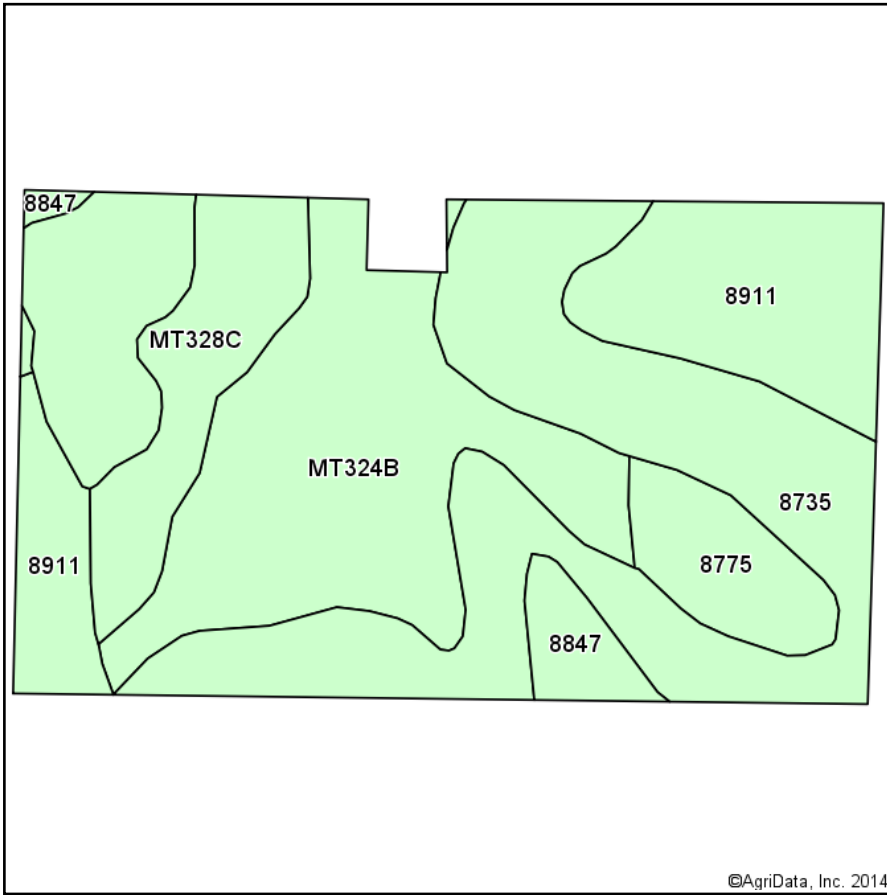

Soils data provided by USDA and NRCS.

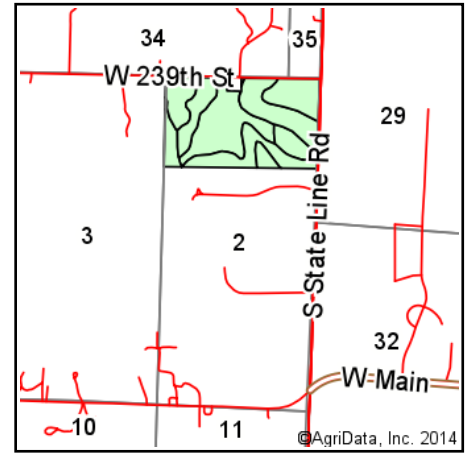

State: **Kansas**
 County: **Miami**
 Location: **2-16S-25E**
 Township: **Wea**
 Acres: **99**
 Date: **10/30/2014**



Maps Provided By:

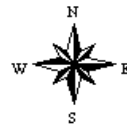

Area Symbol: KS121, Soil Area Version: 14

Code	Soil Description	Acres	Percent of field	Non-Irr Class	Range Production (lbs/acre/yr)	Improved bermudagrass	Tall fescue	Alfalfa hay	Corn	Grain sorghum	Soybeans	Wheat	Winter wheat	Warm season grasses
8735	Eram silty clay loam, 3 to 7 percent slopes	39.31	39.7%	IVe	4200	6	5							
MT324B	Bucyrus silty clay loam, 1 to 3 percent slopes	24.98	25.2%	Ile	6400								51	8
8911	Summit silty clay loam, 1 to 3 percent slopes	16.70	16.9%	Ile	4000	7	6	4	60	65	35		40	
MT328C	Bucyrus silty clay loam, 3 to 8 percent slopes	9.07	9.2%	IIle	0								51	8
8775	Kenoma silt loam, 1 to 3 percent slopes	5.68	5.7%	IIle	0									
8847	Okemah silt loam, 0 to 3 percent slopes	3.26	3.3%	Ile	5500	7	6	4	60	70	35	40		
Weighted Average					4138.4	3.8	3.2	0.8	12.1	13.3	7.1	1.3	24.3	2.8

Area Symbol: KS121, Soil Area Version: 14

Field borders provided by Farm Service Agency as of 5/21/2008. Aerial photography provided by Aerial Photography Field Office.