



KLAMATH COUNTY PUBLIC RECORDS REQUEST FORM

Oregon Public Records Law grants each person the right to inspect the records of a public body (unless exempt from disclosure).

Requested By: (Person/Organization)

Name (Printed): Linda Long Daytime Phone: 541-783-2759
Date: _____ Alt. # Cell/Fax: _____
Address: _____ City, State, Zip: _____
Email Address: victoria@orprop.com Form of Response: E-mail ☒ Mail ☐ Fax ☐

Requested From: (Department)

Department: On-Site
Address: _____
City, State, Zip: _____

**This form must be submitted
to the custodial department
(see back of form):**

Please specify the preferred format of record(s). Not all options available from all Departments.
Electronic Media ☐ Paper Copy ☐ Visual Inspection Only ☐

Description of records requested. Please be as specific as possible. Attach additional pages if necessary): All septic records for 1111 Bronco Lane, Chiloquin, R-3407-01500-00800

Fees: (Payment is to be made in advance unless prior arrangements are made. You may qualify for a fee waiver.
Request form # BOCC0012 Public Records - Fee Waiver)

**Klamath County may require
up to seven (7) business days
to comply with any request.**

Research Fee..... Hourly staff rate + overhead (35%)
(if more than 15 minutes staff time will be required)

Photocopies \$ 0.25 / page*

Audio CD..... \$ 3.00*

Video DVD..... \$ 3.00*

Electronic format records may be provided at **no cost**, if less than 15 min. staff time is involved*

*Unless superseded by a specific departmentally adopted fee schedule.

If the request involves research prior to giving an estimate of the costs, and it is determined that the costs will exceed \$25.00, the custodial department shall prepare an estimate and contact the requestor to receive approval/denial to proceed with the records request.

Requestor Signature: Victoria OB Trees for Linda Long

STAFF USE ONLY

Response:

☐ County does not possess or is not the custodian of requested records.

☐ Copies of all requested, non-exempt records provided.

☒ County has at least some of the requested records.

☐ Acknowledgment of record prohibited or restricted under State or Federal Law: _____
(list applicable law(s))

Completed: Initial / Date
OK 12/31/13

Fees for Services

Description	Rate	Quantity	Cost
Photocopies	\$0.25	6	1.50
CD's	\$3.00		
DVD's	\$3.00		
Staff Time			
Overhead (35%)			
Total Charges			

Comments:

billed

30080

Control No.

STATE OF OREGON

PERMIT NO. 30080

DEPARTMENT OF ENVIRONMENTAL QUALITY

\$ 150.00

Fee

Receipt # 2299



New Construction



Repair



Other Alteration

Permit Issued To

Ron Davis

(Property Owner's Name)

34

(Township)

7

(Range)

15

(Section)

800

(Tax Lot / Acct. No.)

18

(County)

Pine Ridge Rd.

(Road Location)

Chiloquin

(City)

Cindy Foster

(Issued by - Signature)

6-25-92

(Date Issued)

PERMITS ARE NOT TRANSFERABLE

ALL WORK TO CONFORM TO OREGON ADMINISTRATIVE RULES, CHAPTER 340. WORK SHALL BE DONE BY PROPERTY OWNER OR BY LICENSED SEWAGE DISPOSAL SERVICE. (MAKE NO CHANGES IN LOCATION OR SPECIFICATIONS WITHOUT WRITTEN APPROVAL)

SPECIFICATIONS

EXPIRATION DATE 6-25-93

TYPE OF SYSTEM

Standard

Average Daily Sewage Flow 225 Gallons/Day

Design Peak Sewage Flow 450 Gallons/Day

concrete 1100 dosing septic Tank Volume 1100 Gallons Disposal Trenches ☐Seepage Bed(s) ☐ Square Feet

Maximum Depth _____ inches.

Minimum Depth _____ inches.

Linear Feet

Equal ☐Loop ☐Serial ☐Pressurized ☐

Minimum Distance Between Trenches _____

Total Rock Depth _____ inches.

Below Pipe _____ inches.

Above Pipe _____ inches.

☐ Rake Sidewall

Special Conditions (Follow Attached Plot Plan)

Alteration to connect to existing septic system for house. Will use either dosing septic or 1500 2-comp. tanks. Will be pumping up to tank in residence.

PRE-COVER INSPECTION REQUIRED — CONTACT

CERTIFICATE OF SATISFACTORY COMPLETION

As-Built Drawing

with Reference Locations

Installer

Pete Pate

Final Insp. Date

7-13-92



Inspected By

C. Foster



Issued by Operation of Law



Pre-cover inspection waived pursuant to OAR 340, Division 71

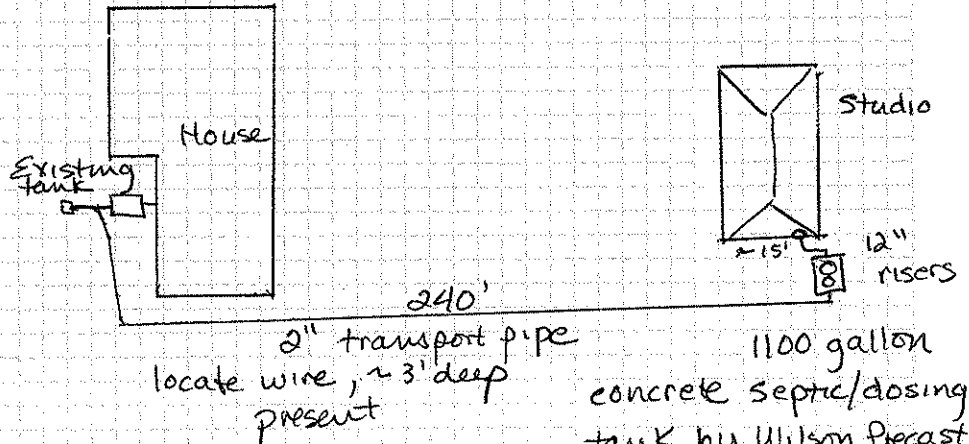

In accordance with Oregon Revised Statute 454.665, this Certificate is issued as evidence of satisfactory completion of an on-site sewage disposal system at the location identified above.

Issuance of this Certificate does not constitute a warranty or guarantee that this on-site disposal system will function indefinitely without failure.

Cindy Foster

(Authorized Signature)

Sanitarian

(Title)

7-16-92

(Date)

KCHD

(Office)



KLAMATH COUNTY

Department of Health Services

403 Pine Street
Klamath Falls, OR 97601

PUBLIC HEALTH
(503) 882-8846

WIC
(503) 883-4276

AIR QUALITY
(503) 883-5118

ENVIRONMENTAL HEALTH
(503) 883-1122

FAX #
(503) 883-4270

June 4, 1992

IMPORTANT DOCUMENT - SITE EVALUATION REPORT

John and Cindy Davis
1111 Bronco
Chiloquin, OR 97624

re: T34S, R7E, S15; TL 800
8.03 acres

Based on the soil profile in test holes you provided, the site is approved for a sewage disposal system. A copy of the study is attached and the requirements are as follows:

- Approved for an Alternative Bottomless Sand Filter System.
- Filter unit must be installed in the area shown on the back of the Site Evaluation field worksheet (attached).
- Filter unit and replacement area setbacks are 100 feet from all wells, and from springs located on property, and 10 feet from property lines.
- Any alteration of the natural conditions (i.e. cutting or filling) in the approval area or further partitioning or subdividing on the subject or adjacent properties may void this approval (ORS 454 and OAR 340).
- Sites for the initial and replacement Sand Filter units must be kept free from development.
- Due to the alternate design and cost of this system, a potential buyer should be shown a copy of this letter and attachments.
- Sand filter unit shall be installed on ground surface.

SAND FILTER UNIT SPECIFICATIONS

- Design flow: 450 gallons per day.
- Filter area: Minimum 366 square feet.
- Sand Criteria: Medium sand per OAR 340-71-290 (b) (enclosed).
- Bottom of filter unit shall be installed on ground surface.

John and Cindy Davis
June 4, 1992
Page 2

Any person other than the property owner must be licensed by the DEQ to construct/install a sewage disposal system. A permit must be obtained from this office prior to installation. Submit the following items to obtain a permit:

1. An application signed by the Klamath County Planning Department for Land Use Compatibility approval.
2. Permit fee, \$305
3. A detailed plot plan.
4. Detailed plans which will be reviewed and approved by this department, must be of construction quality and include the hydraulic calculations for the pressurized distribution system. OAR 340-71-415, copy enclosed, gives you the ability to apply for a variance to the rules which may allow installation of a less expensive system. The cost of a Formal Rule Variance is \$225., with application and fee directed to the DEQ, On-Site Sewage Systems Section, Sherman Olson, 811 S.W. Sixth Avenue, Portland, OR 97204, phone (503) 229-6443. For your convenience I enclosed an application.

Also, you may apply for a Site Evaluation Report Review within 30 days of the date on this report. Send your request to Don Bramhall, DEQ Central Region Office, 2146 NE 4th Street, Bend, OR 97701, phone 503 388-6146. The fee is \$200.

If you have questions or need assistance, please feel free to contact us at 883-1122.

Sincerely,

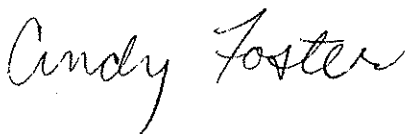

Cindy Foster
Environmental Health Sanitarian

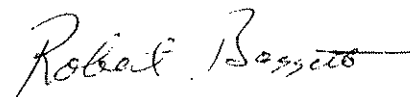

Robert Baggett, R.S.
Environmental Health Director

ef/botsand

enclosures

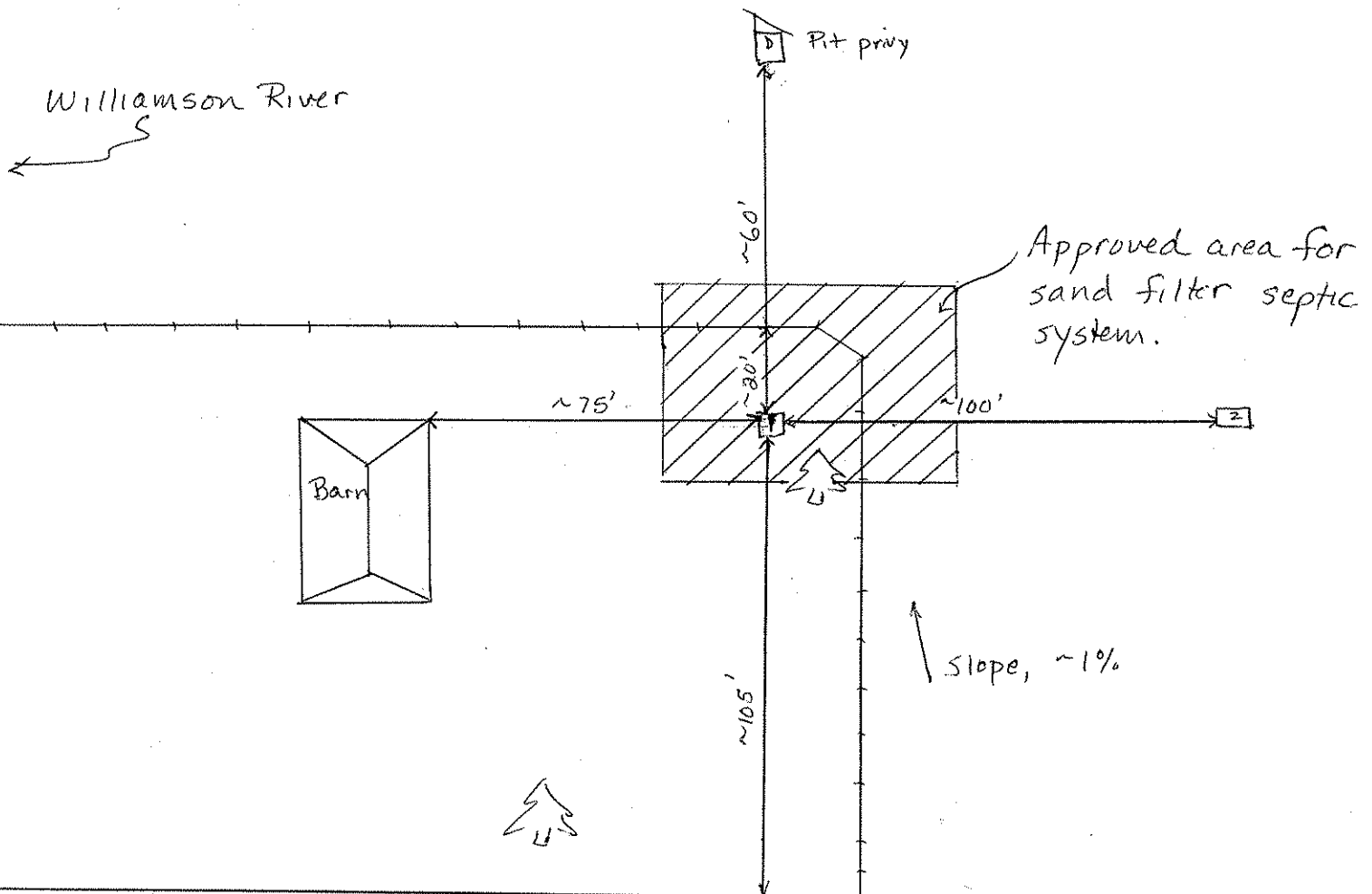

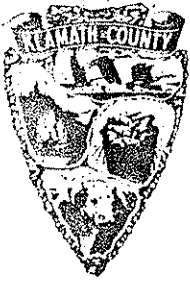

KLAMATH COUNTY

Department of Health Services

403 Pine Street
Klamath Falls, OR 97601

PUBLIC HEALTH
(503) 882-8846

WIC
(503) 883-4276

AIR QUALITY
(503) 883-5118

ENVIRONMENTAL HEALTH
(503) 883-1122

FAX #
(503) 883-4270

May 5, 1992

John Davis
1111 Bronco
Chiloquin, OR 97624

re: T34S, R7E, S1S; TL 800
Authorization Notice

This notice authorizes connection of an additional bedroom and bathroom to the existing on-site sewage disposal system located on the above referenced property.

On April 30, 1992 this office conducted an on-site inspection of the subsurface sewage disposal system on the property referenced above.

A 1000 gallon steel septic tank was present. The tank was holding fluids and retaining solids. The representative of the property stated in the questionnaire that the septic tank had been pumped in March 1992. It is recommended that the septic tank be checked and pumped if needed every (4) years of use.

The tank was approximately 30 inches below the ground surface, and the lid was pitted with a few holes. We recommend the lid be replaced before covering the tank.

The exact amount, condition, construction quality or location of the drainfield was not disclosed and could not be determined. There was no evidence of surfacing sewage on the property. We can find no documentation of this system in our files.

This Notice does not guarantee satisfactory or continuous operation of the on-site system identified. Please be advised that should the system ever fail, prior to any repair work, a permit from this department is required. A permit and inspection of the building sewer connected to the on-site system may be required by the Klamath County Building Department.

Sincerely,

Handwritten signature of Cindy Foster in cursive script.

Cindy Foster
Environmental Health Sanitarian

Handwritten signature of Robert Baggett in cursive script.

Robert Baggett, R.S.
Environmental Health Director

ef
enclosure