

FOR SALE

320 ACRES CROPLAND

LANE COUNTY, KS

LEGAL DESCRIPTION: N/2 of Section 24-19-29

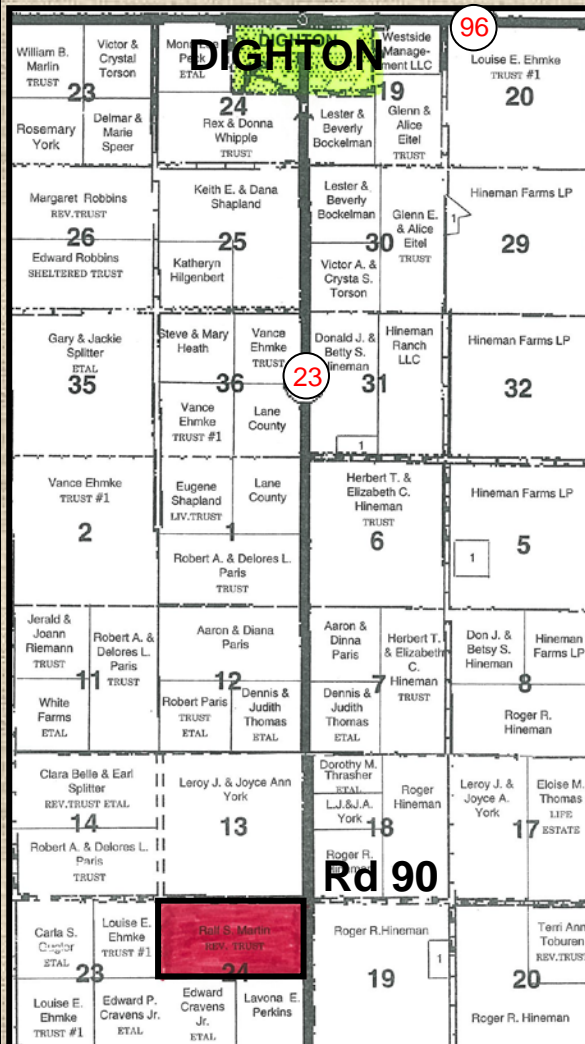

LOCATION: From the intersection of Hwys 96 and 23 in Dighton, Kansas, go 6 miles South on Hwy 23 to Rd 90, the NE corner of the property. **SIGNS WILL BE POSTED!!**

MINERAL RIGHTS: All of the Seller's interest will transfer to the Buyer at closing.

CROPS: Subject to the tenant's rights and Buyer will receive the landlord's share of the 2015 wheat crop, if any.

FSA INFORMATION: Cropland Acres - 315.7±

	Base Acres	DCP Yield
Wheat	160.6	35
Grain Sorghum	16.3	40

Any FSA farm program payments will be subject to the new farm bill provisions and to the tenant's rights.

POSSESSION: Date of closing, subject to the tenant's rights.

REAL ESTATE TAXES: Taxes for 2014 will be prorated to the date of closing. (2013 taxes = \$871.02)

PRICE: \$ 832,000

Statements, While Not Guaranteed, Are From Reliable Sources.



SOIL LEGEND:

2612 – Harney silt loam, 0 to 1% slopes
1770 – Richfield-Uly silt loams, 1 to 3% slopes
1761 – Richfield silt loam, 0 to 1% slopes



For Virtual Tour visit www.farmandranchrealty.com

FARM & RANCH REALTY, INC.



1420 W. 4th • Colby, KS 67701
Toll Free: 1- 800-247-7863

DONALD L. HAZLETT, BROKER

"When you list with Farm & Ranch, it's as good as SOLD!"

