

LAND FOR SALE

VALLEY COUNTY ACREAGE

LOCATION: 1 1/2 miles southwest of Ord, Nebraska on State Highway 70. (Property located on the corner of State Hwy 70 and 475th Road)

LEGAL

DESCRIPTION: Part of the SE 1/4 South of Hwy 70 Section 30-T19N-R14W 6th P.M., Valley County, Nebraska

PROPERTY DESCRIPTION: Valley County Assessor indicates a total of 14.0 acres. Farm consists of good quality dry cropland.

FARM SERVICE AGENCY INFORMATION: Total Cropland - 13.94 acres
Government Base Acres - Corn 9.6 acres at 59 bu/acre Soybeans 3.5 acres at 21 bu/acre
All cropland is considered non-highly erodible by the NRCS.

SOILS: Soils consist of Holdrege silt loam with slopes of 3-7%.

REAL ESTATE TAXES: 2013 Real Estate Tax - \$258.12

LIST PRICE: \$60,000

LEASE: Farm sells subject to a 2014 farm lease.

COMMENTS: This is a highly productive tract of land which has excellent location and offers rural residential and/or commercial development potential.

CONTACTS: Bart Woodward, Listing Broker	(308) 233-4605	bart@agriaffiliates.com
Bryan Danburg, Salesperson	(308) 380-3488	bryan@agriaffiliates.com
Kent Richter, Salesperson	(308) 627-6465	kent@agriaffiliates.com
David Frost, Assoc. Broker	(308) 380-8321	davef@agriaffiliates.com
John Keeney, Salesperson	(308) 293-1713	jkeeney@agriaffiliates.com

Offered Exclusively By:



AGRI AFFILIATES, INC.

... Providing Farm - Ranch Real Estate Services. ...

Management • Sales • Auctions • Appraisals

KEARNEY OFFICE
P.O. Box 1390
2418 East Hwy 30
Kearney NE 68848-1390
www.agriaffiliates.com
(308) 234-4969
Fax (308) 236-9776

Information contained herein was obtained from sources deemed reliable. We have no reason to doubt the accuracy, but we do not guarantee it. Prospective Buyers should verify all information, including items of income and expenses. All maps provided by Agri Affiliates, Inc. are approximations only, to be used as a general guideline, and not intended as survey accurate.



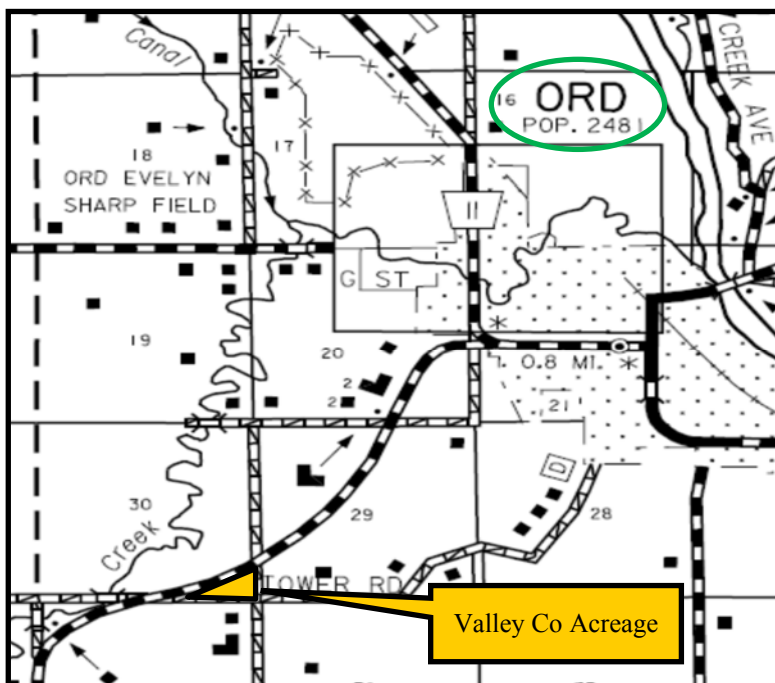
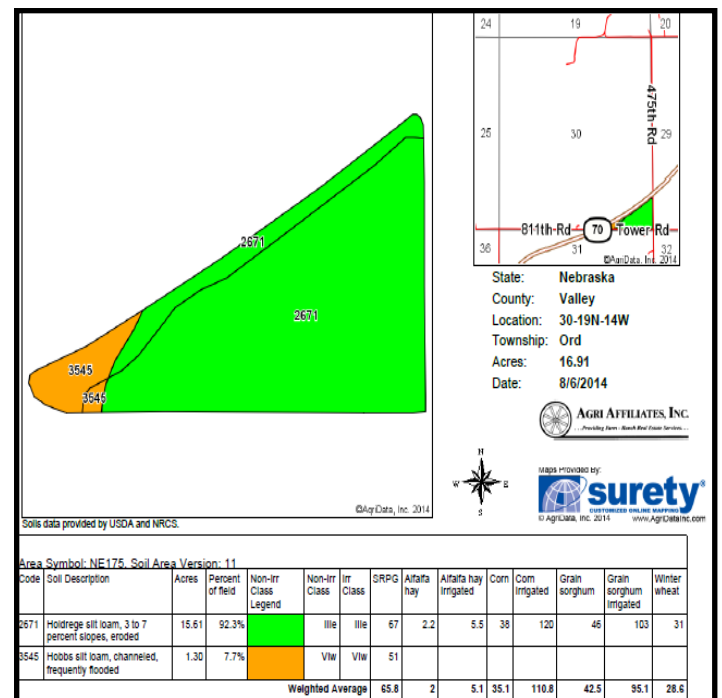

All maps provided by Agri Affiliates, Inc. are approximations only, to be used as a general guideline, and not intended as survey accurate.