

# Soils Map-CSR2

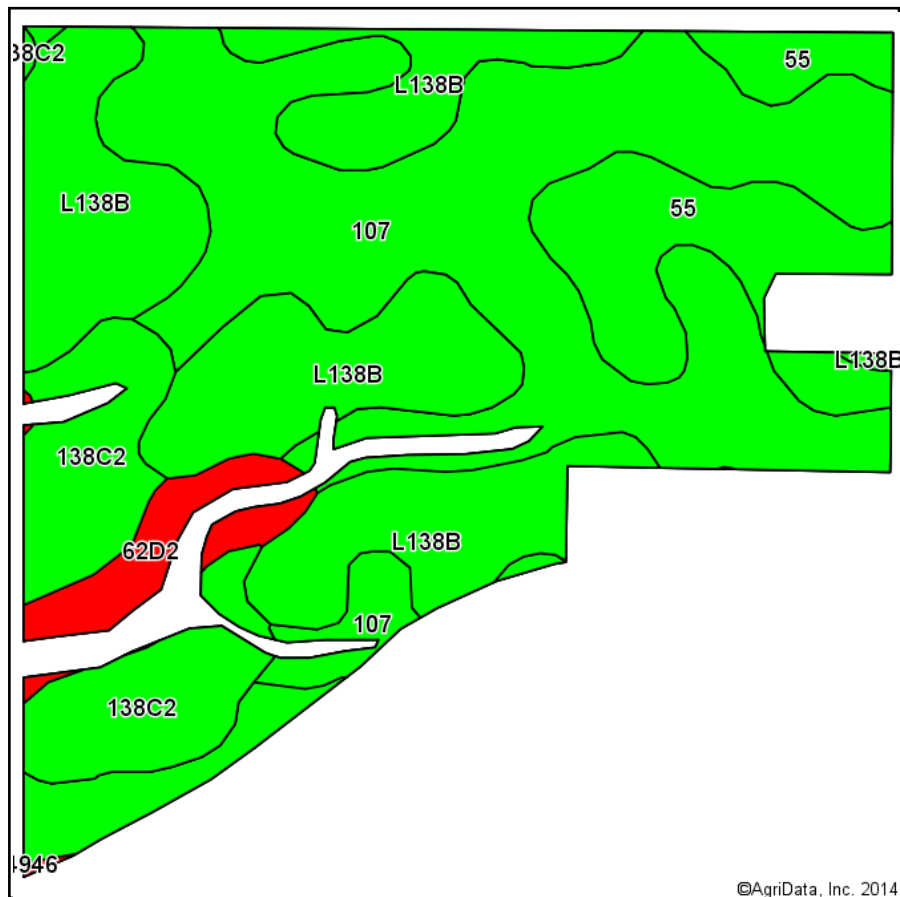

Soils data provided by USDA and NRCS.

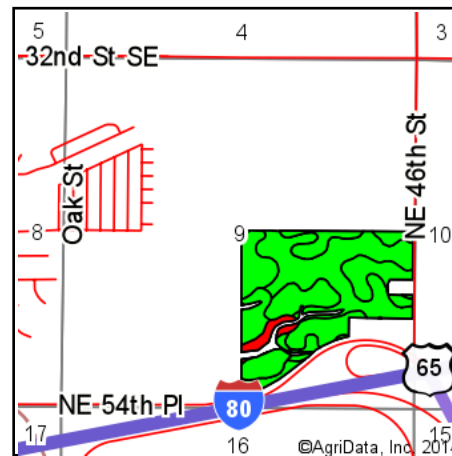

State: **Iowa**  
 County: **Polk**  
 Location: **9-79N-23W**  
 Township: **Delaware**  
 Acres: **99.94**  
 Date: **2/17/2014**

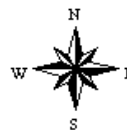

| Code             | Soil Description  | Acres | Percent of field | **CSR2 Legend | Non-Irr Class | CSR2** |
|------------------|---|-------|------------------|---------------|---------------|--------|
| 107              | Webster silty clay loam, 0 to 2 percent slopes          | 39.77 | 39.8%            |               | IIw           | 90     |
| L138B            | Clarion loam, Bemis moraine, 2 to 6 percent slopes      | 33.02 | 33.0%            |               | IIe           | 88     |
| 138C2            | Clarion loam, 5 to 9 percent slopes, moderately eroded  | 11.89 | 11.9%            |               | IIIe          | 82     |
| 55               | Nicollet loam, 1 to 3 percent slopes                    | 11.46 | 11.5%            |               | I             | 90     |
| 62D2             | Storden loam, 9 to 14 percent slopes, moderately eroded | 3.72  | 3.7%             |               | IIIe          | 36     |
| 4946             | Orthents-urban land complex, 0 to 5 percent slopes      | 0.08  | 0.1%             |               |               | 5      |
| Weighted Average |   |       |                  |               |               | 86.3   |

\*\*IA has updated the CSR values for each county to CSR2.

Area Symbol: IA153, Soil Area Version: 15, Established: 11/27/2013 03:51:22 PM

Field borders provided by Farm Service Agency as of 5/21/2008. Aerial photography provided by Aerial Photography Field Office.