

Soils Map-CSR2

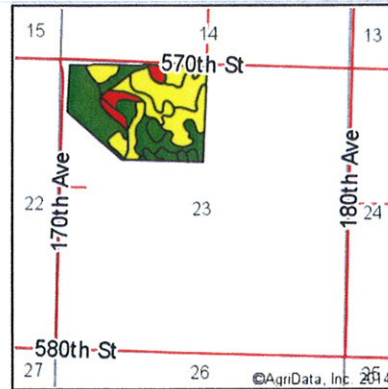
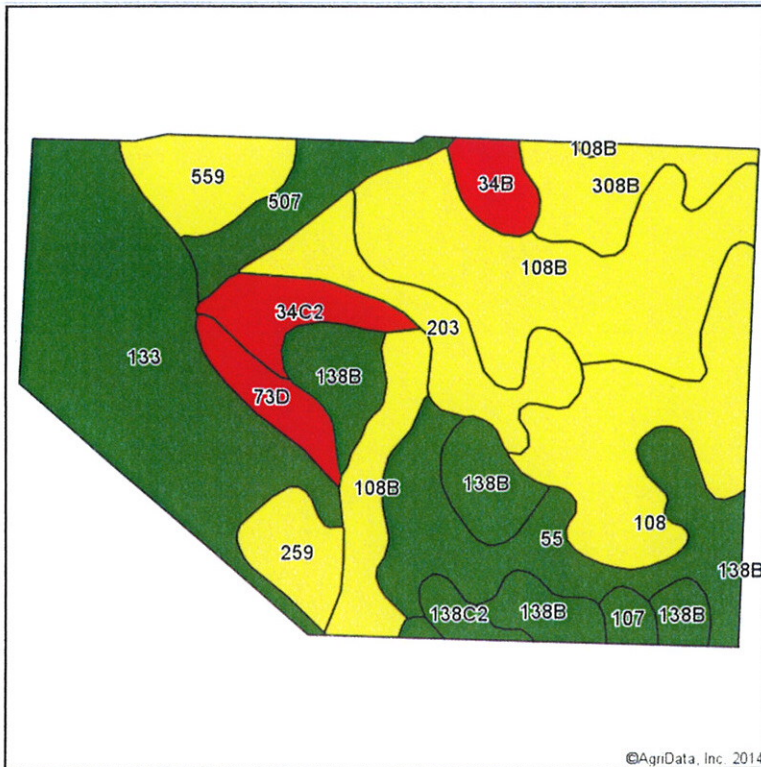

Soils Version
latest

State: Iowa
County: Buena Vista
Location: 23-91N-36W
Township: Grant
Acres: 90.76
Date: 4/8/2014

MIDWEST LAND
712-282-3110
MANAGEMENT



Maps Provided By:
surety
CUSTOMIZED ONLINE MAPPING
© AgriData, Inc. 2014 www.AgriDataInc.com

Soils data provided by USDA and NRCS.

Area Symbol: IA021, Soil Area Version: 18

Code	Soil Description	Acres	Percent of field	**CSR2 Legend	Non-Irr Class	CSR2**	CSR
133	Colo silty clay loam, 0 to 2 percent slopes	18.35	20.2%		IIw	74	76
108B	Wadena loam, moderately deep, 2 to 5 percent slopes	18.19	20.0%		Ile	51	48
108	Wadena loam, moderately deep, 0 to 2 percent slopes	9.63	10.6%		IIIs	58	56
55	Nicollet loam, 1 to 3 percent slopes	9.43	10.4%		I	89	84
138B	Clarion loam, 2 to 6 percent slopes	7.45	8.2%		Ile	90	76
203	Cylinder loam, deep, 0 to 2 percent slopes	5.48	6.0%		I	60	73
308B	Wadena loam, deep, 1 to 5 percent slopes	4.04	4.5%		Ile	55	61
559	Talcot clay loam, deep, 0 to 2 percent slopes	3.51	3.9%		IIw	54	67
507	Canisteo silty clay loam, 0 to 2 percent slopes	3.48	3.8%		IIw	88	74
34C2	Estherville sandy loam, 5 to 9 percent slopes, moderately erode	2.89	3.2%		IVs	11	5
259	Biscay clay loam, deep, 0 to 2 percent slopes	2.63	2.9%		IIw	54	76
73D	Salida gravelly sandy loam, 9 to 14 percent slopes	2.13	2.3%		IVs	7	5
34B	Estherville sandy loam, 2 to 5 percent slopes	1.84	2.0%		IIIs	18	14
138C2	Clarion loam, 5 to 9 percent slopes, moderately eroded	0.98	1.1%		IIle	75	60
107	Wehster silty clay loam, 0 to 2 percent slopes	0.73	0.8%		IIw	87	79
Weighted Average						63.5	62.5

**IA has updated the CSR values for each county to CSR2.

Field borders provided by Farm Service Agency as of 5/21/2008. Aerial photography provided by Aerial Photography Field Office.