

Soils Map-CSR(as of 1/21/12)

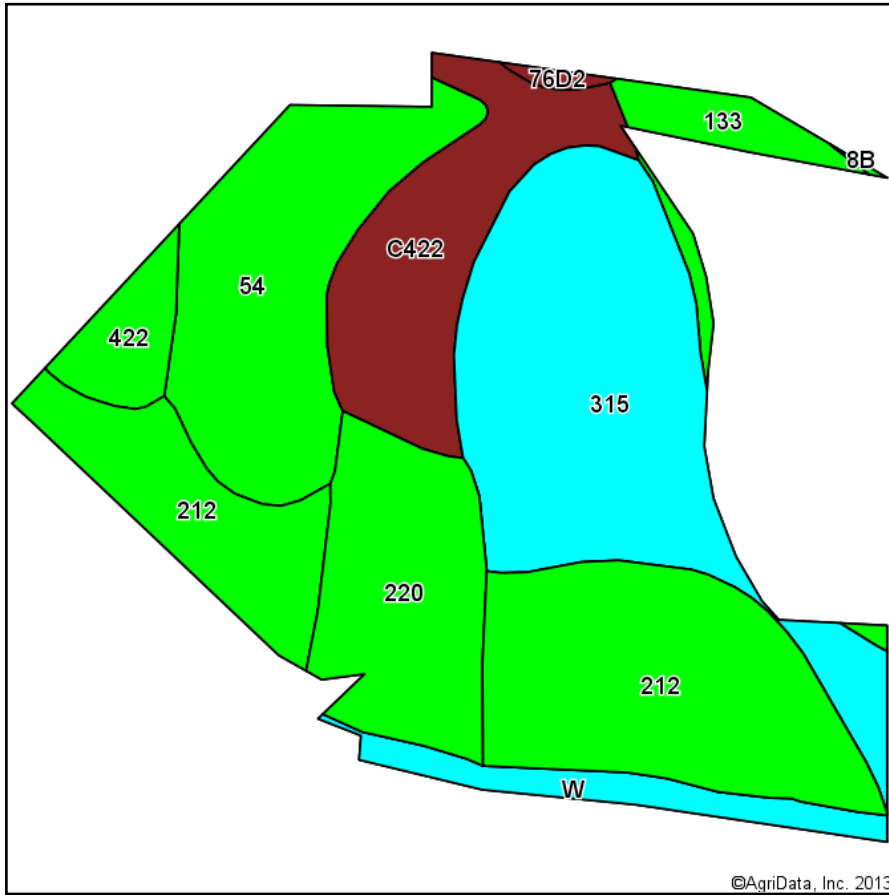

Soils data provided by USDA and NRCS.

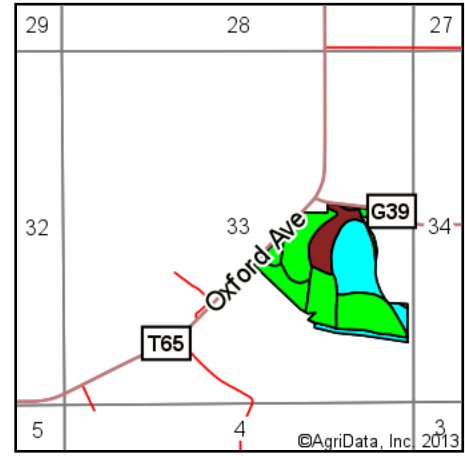

State: **Iowa**
 County: **Mahaska**
 Location: **33-76N-15W**
 Township: **Spring Creek**
 Acres: **65.64**
 Date: **12/27/2013**

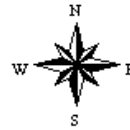

Maps Provided By:
surety
 CUSTOMIZED ONLINE MAPPING
 © AgriData, Inc. 2013 www.AgriDataInc.com

Code	Soil Description	Acres	Percent of field	CSR Legend	Non-Irr Class	CSR*
212	Kennebec silt loam, 0 to 2 percent slopes	16.95	25.8%		I	95
315	Nodaway-Alluvial land complex, 0 to 2 percent slopes	16.10	24.5%		IIw	20
54	Zook silty clay loam, 0 to 2 percent slopes	10.49	16.0%		IIw	70
C422	Amana complex, channeled, 0 to 2 percent slopes	7.72	11.8%		Vw	50
220	Nodaway silt loam, 0 to 2 percent slopes	7.54	11.5%		IIw	80
W	WATER	2.38	3.6%			0
133	Colo silty clay loam, 0 to 2 percent slopes	2.19	3.3%		IIw	80
422	Amana silty clay loam, 0 to 2 percent slopes	2.03	3.1%		IIw	85
76D2	Ladoga silt loam, 9 to 14 percent slopes, moderately eroded	0.24	0.4%		IIIe	58
Weighted Average						61.2

**IA is currently updating the CSR values for each county to CSR2.

Note: ALL soils information on this page is dated 1/21/2012

Field borders provided by Farm Service Agency as of 5/21/2008. Aerial photography provided by Aerial Photography Field Office.