

-177
Revised 1-71

85 Lee & Lane
INWOOD, WV 25428
WEST VIRGINIA
SEPTIC TANK INSPECTION FORM

Hampshire County Health Department Installation Permit No. SF14-97-336
Name of Owner Michael & Sheri Penwell
Address Rt. 2 Box 155A, Hedgesville, WV 25427
Property Address Capon Meadows Sect. II Lot #8

DESCRIPTION & NUMBER OF UNITS SERVED

Type Facility Served house No. Water Closets
Lot Size 4.3 ^{acres} sq. ft. Area suitable for sewage disposal installation sq. ft.
Source of Water Supply well No. Lavatories
No. Bedrooms 2 No. Showers or Tubs No. Baths
No. Garbage Grinders 0 No. Automatic Washers 1

SEPTIC TANK

Material concrete Length x Width x Depth = cubic feet
Liquid Depth ft. Liquid Capacity 1000 gal.
Distance to: Dwelling Water Supply 100' + Nearest Property Line 30' +

SOIL ABSORPTION SYSTEM

Type Drain Line Material gravelless Trench Width 18 Inches
Trench Depth 34-24 Inches Total Absorption area in Trench Bottom 876 sq. ft.
Diameter of Drain Line 10 Inches Type Filter Media
No. of Drain Lines 3 Depth Filter Media Under Drain Line Inches
Length of Each Line 90, 90, 90, 8 ft. Depth Filter Media Over Drain Line in.
Distance of Disposal Field to: (a) Dwelling 175'
(b) Water Supply 150' + (c) Nearest Property Line 14'

An inspection of the septic tank system described herein disclosed that said system (MEETS, DOES NOT MEET) the minimum standards established by the West Virginia State Department of Health.

5-15-97
Date

J. K. [Signature]
Sanitarian

SKETCH OF SYSTEM TO BE DRAWN ON BACK

Note: Copy of this inspection report must be given to owner and the original filed in the Health Department files. PERMANENT RECORD - DO NOT DESTROY.

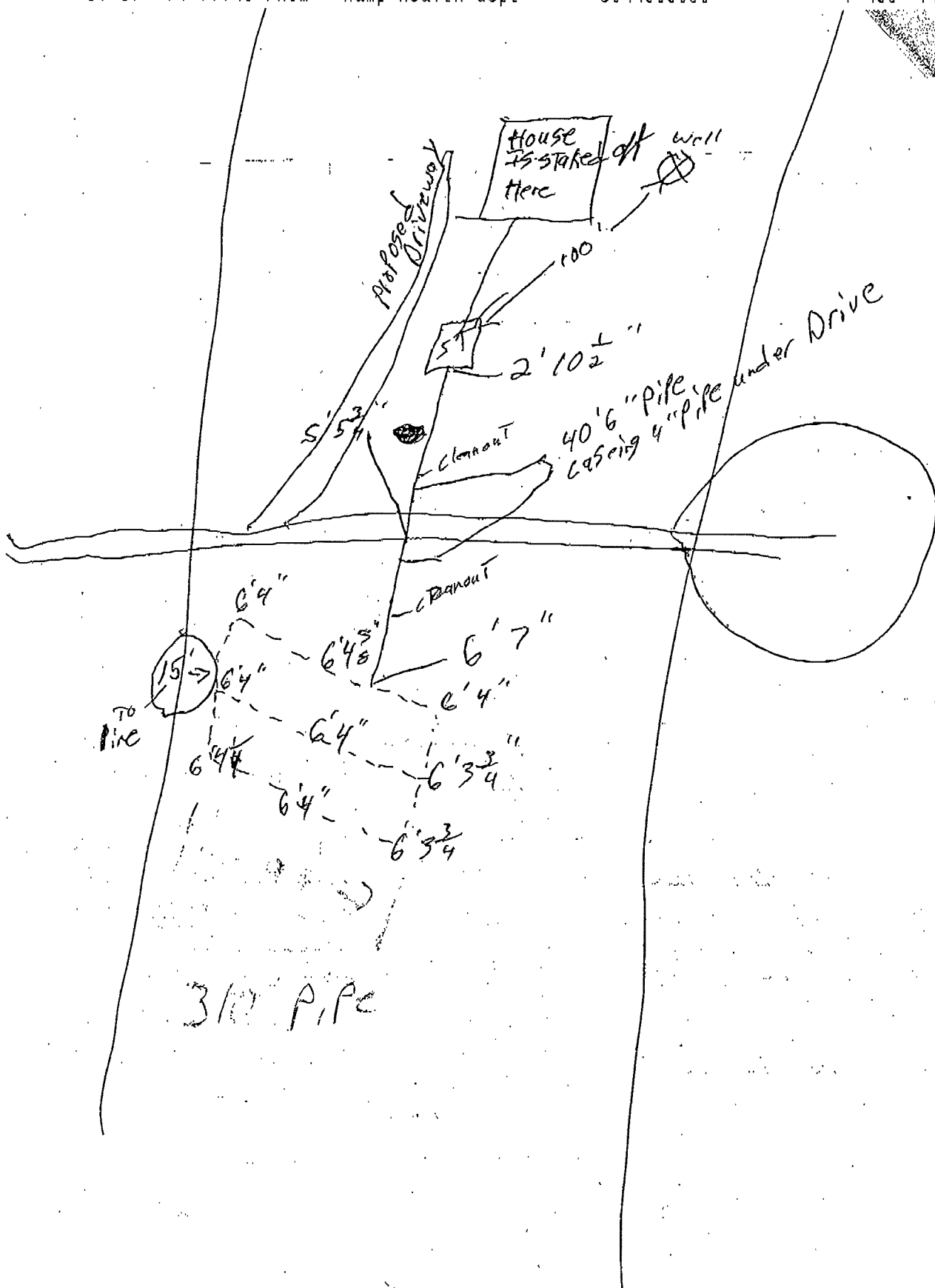

WEST VIRGINIA DEPARTMENT OF HEALTH

PERMIT

I hereby issued a permit to Michael S. Sauer, Jr. and DR. R. L. H. H.to construct sewer lines in the city of Hamlin in the county of Lincoln in the state of West Virginia

in accordance with Chapter 16, Article 1, Section 2 of the Code of West Virginia

Date Issued March 1, 1937 Expires March 1, 1938Permit No. 34-102-17-102

This permit is not transferable and any change of information submitted in application dated

will automatically render this permit invalid.

THIS PERMIT IS NOT APPLICABLE TO PUBLIC WATER SUPPLIES

Capacity 1000 gal.