

NOTICE OF LAND SALE

"New Road Tract" - Listing #4417

SE¼ of SW¼, Sec. 35, T8S, R24W; Fr. N½ of NW¼, and SW¼ of NW¼, Sec. 2, T9S, R24W
Pike County, Arkansas
containing 156.13 acres, more or less

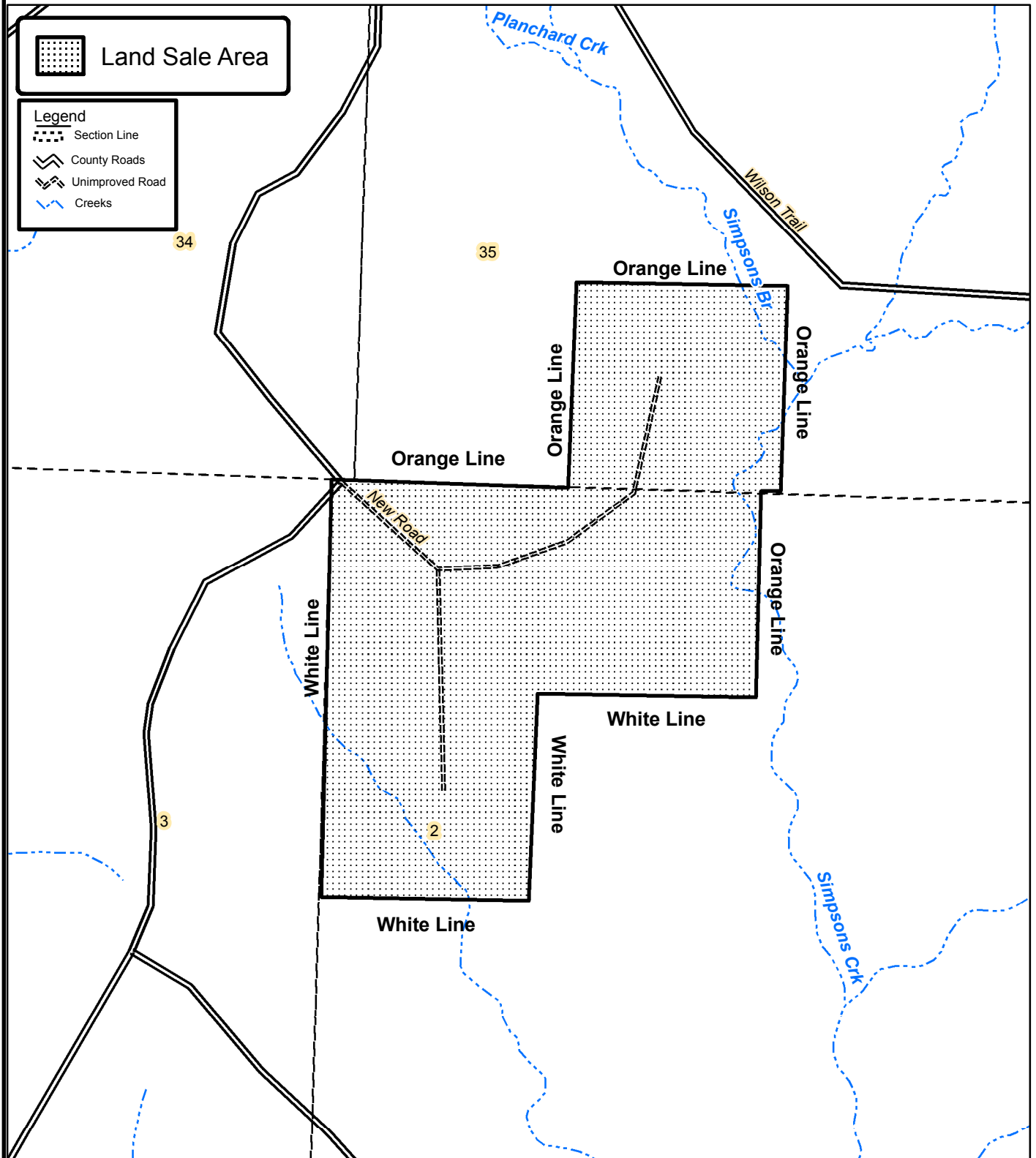

0 0.125 0.25
Miles



Created: October 1, 2013
By: BSE