

Curve	Delta Angle	Radius	Arc
1	8°13'25"	515.24	73.85
	Tangent	Chord	Chord Bearing
	37.04	73.89	N 49°19'23" W

Line	Bearing	Distance
1	N42°30'48"W	111.90'
2	N48°41'43"W	161.65'
3	N37°29'09"W	33.91'

**PLAT OF SURVEY
SHOWING
PART OF THE
STEPHEN WHITE SUR. A - 567
KAUFMAN COUNTY, TEXAS**

I, Greg Sjerven, Registered Professional Land Surveyor No. 5244, do hereby certify that the above plat and companion field notes were prepared from an actual survey made by me on the ground during the month of June, 2013.

This survey meets the requirements of the General Rules of Procedures and Practices as defined by the Texas Board of Professional Land Surveying.

This survey was performed for the benefit of Kenneth Cleaver. Use of this plat by any other person or for any other purpose is prohibited and the undersigned is not responsible for any loss resulting therefrom.

GIVEN UNDER MY HAND AND SEAL
this the 13th day of June, 2013.

NOTE: PLAT VOID IF NOT SIGNED IN BLUE

GREG SJERVEN, R.P.L.S. NO. 5244
Copyright 2013. All rights reserved.
Statewide Surveying Service



Interstate Highway No. 20

East Bound Lane

LAKE

Total

151.312 Ac.
(2.074 Ac. in Rd.)

Call: 14.19 Ac.
Betty B. Blomberg
-to-
Kenneth L. Cleaver, et ux
Sept. 13, 1996 Vol. 1227 pg. 558

Second Tract Call: 117.83 Ac.
Save & Except 20.3897 Ac.
Walter Earl Featherston, et ux
June 30, 1995 -to- Kenneth L. Cleaver, et ux
Vol. 1173 pg. 351

First Tract Call: 100 Ac.
Save & Except 2.500 Ac., 2.500 Ac. and 23 Ac.
Walter Earl Featherston, et ux
June 30, 1995 -to- Kenneth L. Cleaver, et ux
Vol. 1173 pg. 351

Tract 2 362.394 Ac.
AP Dupont Limited Partnership
Vol. 3592 pg. 559

Stephen White Sur. A - 567

F. Mc Mahan Sur. A - 313

L. Pierce Sur. A - 373

Wm. Simpson Sur. A - 423

Call: 23.000 Ac.
Walter Earl Featherston, et ux
-to-
Kenneth L. Cleaver, et ux
June 2, 1988 Vol. 931 pg. 564

Access Easement
Maher One Properties
Vol. 4151 pg. 467

6.20 Ac.
Merrin C. Duncan
Vol. 2429 pg. 377

15.001 Ac.
Michael O. Snyder
and Eric Dale Snyder
Vol. 4055 pg. 27

Tract 4 76 Ac.
Maher Properties One
Vol. 1594 pg. 167

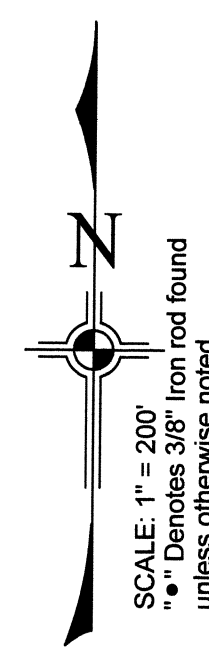

Statewide Surveying Service

208 N. Washington St.
Kaufman, Tx. 75142
972-962-6481