

# Soils Map-CSR(as of 1/21/12)

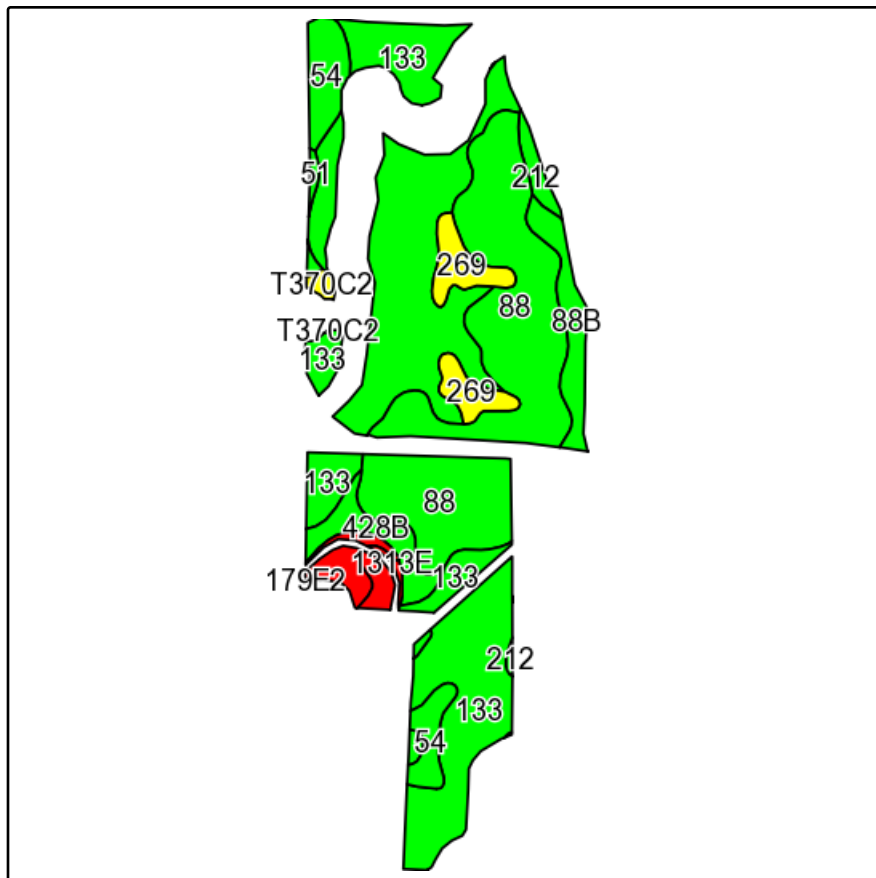

Field borders provided by Farm Service Agency as of 5/21/2008.  
Soils data provided by USDA and NRCS.

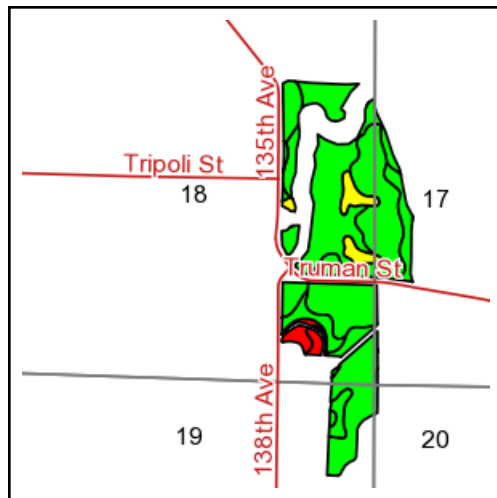

State: **Iowa**  
County: **Warren**  
Location: **18-74N-23W**  
Township: **Liberty**  
Acres: **109.44**  
Date: **8/29/2013**



Maps provided by:



©AgriData, Inc 2013  
www.AgriDataInc.com

Code	Soil Description	Acres	Percent of field	CSR Legend	Non-Irr Class	CSR*
133	Colo silty clay loam, 0 to 2 percent slopes	50.54	46.2%		IIw	80
88	Nevin silty clay loam, 0 to 2 percent slopes	33.69	30.8%		I	90
54	Zook silty clay loam, 0 to 2 percent slopes	6.00	5.5%		IIw	70
269	Humeston silt loam, 0 to 2 percent slopes	4.88	4.5%		IIIw	58
88B	Nevin silty clay loam, 2 to 5 percent slopes	4.32	3.9%		Ile	85
428B	Ely silty clay loam, 2 to 5 percent slopes	3.73	3.4%		Ile	88
993D2	Armstrong-Gara loams, 9 to 14 percent slopes, moderately eroded	2.36	2.2%		IVe	20
212	Kennebec silt loam, 0 to 2 percent slopes	1.46	1.3%		I	91
1313E	MUNTERVILLE silt loam, 14 to 18 percent slopes	1.42	1.3%		VIIe	10
51	Vesser silt loam, 0 to 2 percent slopes	0.54	0.5%		IIw	70
T370C2	Sharpsburg silty clay loam, benches, 5 to 9 percent slopes, moderately eroded	0.50	0.5%		IIIe	67
<b>Weighted Average</b>						<b>79.9</b>

\*\*IA is currently updating the CSR values for each county to CSR2. Note: ALL soils information on this page is dated 1/21/2012

\*CSR ratings will be available for a limited time to aid in the transition to CSR2.