

# Soils Map-CSR(as of 1/21/12)

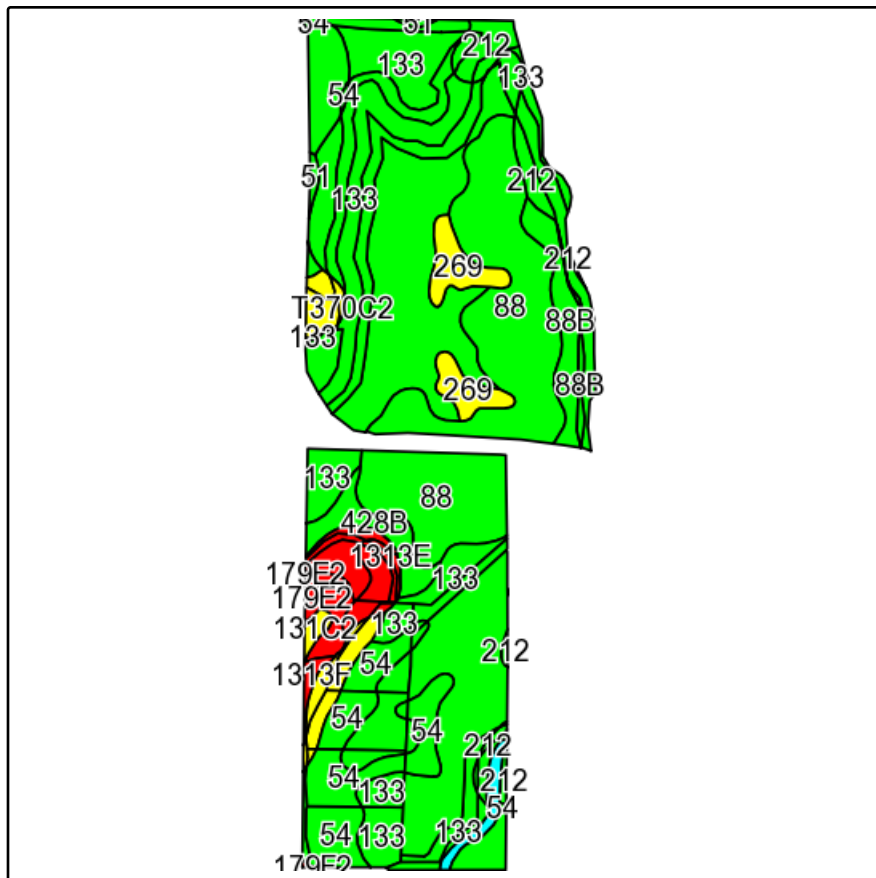

Field borders provided by Farm Service Agency as of 5/21/2008.  
Soils data provided by USDA and NRCS.

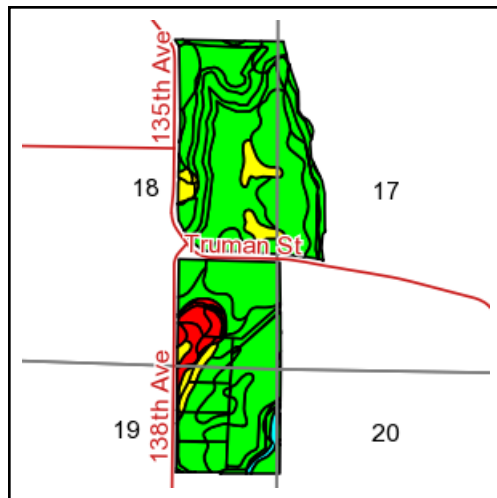

State: **Iowa**  
County: **Warren**  
Location: **18-74N-23W**  
Township: **Liberty**  
Acres: **171.3**  
Date: **5/24/2013**

**PEOPLES**  
COMPANY  
INNOVATIVE. REAL ESTATE. SOLUTIONS.

Maps provided by:



**surety**  
CUSTOMIZED ONLINE MAPPING  
©AgriData, Inc 2012  
www.AgriDataInc.com

Code	Soil Description	Acres	Percent of field	CSR Legend	Non-Irr Class	CSR*
133	Colo silty clay loam, 0 to 2 percent slopes	82.1	47.9%		IIw	80
88	Nevin silty clay loam, 0 to 2 percent slopes	33.7	19.7%		I	90
54	Zook silty clay loam, 0 to 2 percent slopes	16.7	9.7%		IIw	70
212	Kennebec silt loam, 0 to 2 percent slopes	9.4	5.5%		I	91
269	Humeston silt loam, 0 to 2 percent slopes	4.9	2.8%		IIIw	58
88B	Nevin silty clay loam, 2 to 5 percent slopes	4.9	2.9%		Ile	85
993D2	Armstrong-Gara loams, 9 to 14 percent slopes, moderately eroded	4.7	2.7%		IVe	20
428B	Ely silty clay loam, 2 to 5 percent slopes	3.7	2.2%		Ile	88
434D	Arbor loam, 9 to 14 percent slopes	3	1.7%		IIIe	55
1313E	MUNTERVILLE silt loam, 14 to 18 percent slopes	2.5	1.5%		VIIe	10
T370C2	Sharpsburg silty clay loam, benches, 5 to 9 percent slopes, moderately eroded	1.8	1.1%		IIIe	67
W	Water	1.5	0.9%			0
51	Vesser silt loam, 0 to 2 percent slopes	0.7	0.4%		IIw	70
131C2	Pershing silt loam, 5 to 9 percent slopes, moderately eroded	0.6	0.4%		IIIe	50
1313F	MUNTERVILLE silt loam, 18 to 35 percent slopes	0.6	0.4%		VIIe	5
179E2	Gara loam, 14 to 18 percent slopes, moderately eroded	0.5	0.3%		VIe	33
Weighted Average						76.8

Note: ALL soils information on this page is dated 1/21/2012

\*CSR ratings will be available for a limited time to aid in the transition to CSR2.