

CERTIFIED SURVEY MAP NO. 3439

VOLUME 16 PAGE 59

LOCATED IN THE SW 1/4 OF THE NE 1/4 OF SECTION 17, T.30N., R.12W.,
TOWN OF OTTER CREEK, DUNN COUNTY, WISCONSIN

BEARINGS REFERENCED TO THE NORTH/
SOUTH QUARTER LINE OF SECTION 17.
MEASURED AS N00°14'25"E. (DUNN
CO. COORD. SYSTEM - NAD83(91)).

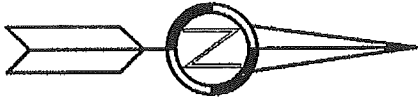
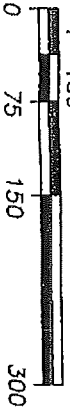

C.S.M. NO. 2333

LOT 4,

5283.03'

NORTH/SOUTH QUARTER LINE

N 00°14'25" E

3521.65'

N 00°14'25" E 438.59'

405.59'

1322.79'

SOUTH QUARTER CORNER
SECTION 17 - FOUND
ALUMINUM CAP MONUMENT

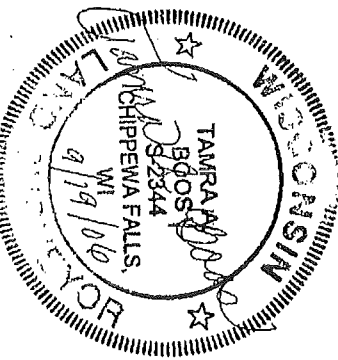

APPROX. 18' EAST OF
DOWN N/S F/L

APPROX. 4' EAST OF
REMANANT N/S F/L

HOUSE

BARN

BARN

ROUND SHED

APPROX. 30' SOUTH OF
DOWN E/W F/L

APPROX. 30' SOUTH OF
DOWN E/W F/L

APPROX. 30' SOUTH OF
DOWN E/W F/L

APPROX. 30' SOUTH OF
DOWN E/W F/L

APPROX. 30' SOUTH OF
DOWN E/W F/L

APPROX. 30' SOUTH OF
DOWN E/W F/L

APPROX. 30' SOUTH OF
DOWN E/W F/L

APPROX. 30' SOUTH OF
DOWN E/W F/L

APPROX. 30' SOUTH OF
DOWN E/W F/L

APPROX. 30' SOUTH OF
DOWN E/W F/L

APPROX. 30' SOUTH OF
DOWN E/W F/L

NORTH QUARTER CORNER
SECTION 17 - FOUND
ALUMINUM CAP MONUMENT

UNPLATTED LANDS

PREPARED FOR:
DAN MILLER

NOTE: SECTION PROTRACTION IS BASED ON
DATA PROVIDED BY THE DUNN COUNTY
SURVEYOR'S OFFICE.

LOT 1

9.90 ACRES
431,047 SQ. FT.
9.15 ACRES EXC. EASE.
398,577 SQ. FT.

N 89°28'00" W 984.61'

UNPLATTED LANDS

LEGEND

- = SET 1" O.D. X 18" IRON PIPE WEIGHING
1.13 LBS. PER LINEAR FOOT
- = FOUND 1" IRON PIPE
- ⊕ = GOVERNMENT CORNER AS NOTED
- △ = SEPTIC VENT PIPE
- = WELL

OUTLOT 1, C.S.M. NO. 3244

CERTIFIED SURVEY MAP NO. 3439
VOLUME 16 **PAGE** 59

LOCATED IN THE SW 1/4 OF THE NE 1/4 OF SECTION 17, T.30N., R.12W.,
TOWN OF OTTER CREEK, DUNN COUNTY, WISCONSIN

SURVEYOR'S CERTIFICATE

I, Tamra A. Boos, Registered Wisconsin Land Surveyor, do hereby certify that I have surveyed, divided and mapped a parcel of land located in the Southwest 1/4 of the Northeast 1/4 of Section 17, Township 30 North, Range 12 West of the 4th Principal Meridian, located in and forming a part of the Town of Otter Creek, Dunn County, Wisconsin, more particularly described as follows:

Commencing at the South Quarter Corner of said Section 17;

thence, along the north/south quarter line, North 00°14'25" East, 3521.65 feet to the POINT OF BEGINNING;

thence, along said north/south quarter line, North 00°14'25" East, 438.59 feet to the northwest corner of said Southwest 1/4 of the Northeast 1/4;

thence, along the north line of said Southwest 1/4 of the Northeast 1/4, South 89°23'29" East, 983.95 feet to the northwest corner of Certified Survey Map Number 3244;

thence, along the west line of said Certified Survey Map, South 00°09'03" West, 437.30 feet;

thence, North 89°28'00" West, 984.61 feet to the point of beginning;

Containing 431,047 square feet or 9.90 acres. Subject to easement as recorded on Document Number 514526 of Dunn County Records. Also subject to any and all other easements, reservations, restrictions and conveyances of record.

That I have made such survey, land division and map by the direction of Dan Miller.

That such map is a correct representation of the exterior boundaries of the land surveyed and the division of that land.

That I have fully complied with the provisions of Chapter 236.34 of the Wisconsin Statutes and the provisions of the Dunn County Subdivision Ordinance.

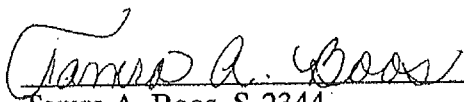

Tamra A. Boos, S-2344

September 19, 2006

NELSEN LAND SURVEYING, INC.

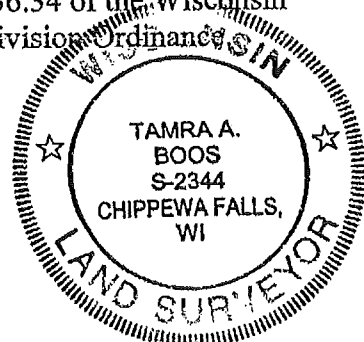

Approved by the Dunn County Zoning Office this 21st day of Sept. 2006.

