

fnd. 5/8" iron rod

5/8" IR  
brs N 2.66'

LOT  
10

N 89°59'59" E  
511.81'

LOT  
11

RED OAK RANCH SECTION ONE  
BLOCK 2  
CABINET I, SHEET 200 M.C.M.R.  
wire fence

conc. mon. NEC J.N. Thomas Survey  
N 89°59'59"E 517.20' (call 523.83')

40.59' fnd. 5/8" iron rod

(plastic fence along lot 10)

16' utility easement

Rec: N 89°59'59" E 510.80'

fnd. 5/8" iron rod

POINT OF BEGINNING

LAND TITLE SURVEY  
FOR: SAMUEL B. HERNANDEZ  
& GLORIA C. HERNANDEZ  
15206 SUNSET TRAIL  
CONROE, TEXAS 77384

SCALE: 1"=80'



BIG TREE ESTATES  
SECTION THREE  
(UNRECORDED SUBD.)

5.066  
ACRES

Reference: 5.00 AC  
Clerk's File 9623354

one story  
frame residence

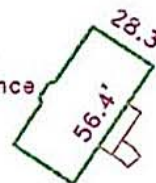

fnd. 5/8" iron rod

300'00" W  
S 00°05'29" W

17

Kim Townsend  
5.85 AC  
CF 2001-081357

Record data shown hereon was relied upon partly  
from a Commitment for Title Insurance issued by  
the following qualified provider:  
Stewart Title Company  
G.F. No. 04409695  
Effective date: November 29, 2004

Covenants of Record:  
County Clerk's File Nos. 8221428 & 9416893  
Real Property Records  
Flood Zone: X FEMA Map No. 48339C 0510F

Marshall & Alberta Recht  
5.111 AC  
CF 9360223

11

JOHN N. THOMAS SURVEY  
ABSTRACT NO. 549

LOT  
16

well

gravel drive

R=50.0'  
L=123.01'  
S 19°31'30" W  
94.25'  
S 00°00'01" E  
47.47'

8' utility easement

490.35'  
S 89°48'52" W  
15

fnd. RR spike

Samuel A. Attia  
1005/748 MCDR

1 AC  
1050/438 MCDR

fnd. 1/2" IR (Recht SEC)  
5/8 IR set by Helmuth  
brs. N 73°51'E 7.74'

PROJECT NO.: 68004



I hereby certify that this survey was made  
on the ground under my supervision and that this  
drawing correctly represents the facts found  
at the time of survey.

Date of Survey: 15 December 2004

Michael C. Warren  
Registered Professional Land Surveyor No. 4935