

Market Realty, Inc.

(979)289-2159

Fax (979)289-2159

420 N Main

Burton, Texas 77835

www.marketrealty.com

e-mail address

burton@marketrealty.com



12510 W Texas St/Burton, TX

\$51,300

Own a piece of history in Burton, Texas! Great opportunity for commercial use as antique store, art gallery, store front or workshop.

Here's your chance to own the property that was formerly Hohlt's Meat Market and Cafe. Property has a great location on the square in downtown Burton, Texas, a historic Commercial district on the national register! You are within walking distance of shops, restaurants, bank and post office as well as close to Brenham, Round Top and Carmine. For more information call Susan Kiel at 979-289-2159/979-251-4078 or Roger Chambers at 979-830-7708

From Brenham head west on Hwy 290 towards Austin. Exit Spur 125 to the right into Burton. Turn left on to Texas Street and property is on the right.

"THE MARKET TEAM"

Susan S. Kiel, Broker Associate

Roger D. Chambers, Broker

The information contained herein, while obtained from sources deemed reliable, is not warranted by MARKET REALTY, INC.
Property is subject to prior sale, change, or withdrawal from market without notice.

SKETCH ADDENDUM

Borrower or Owner			
Property Address 12510 W Washington			
City	Burton	County	
State	TX	Zip Code	77835
Client			

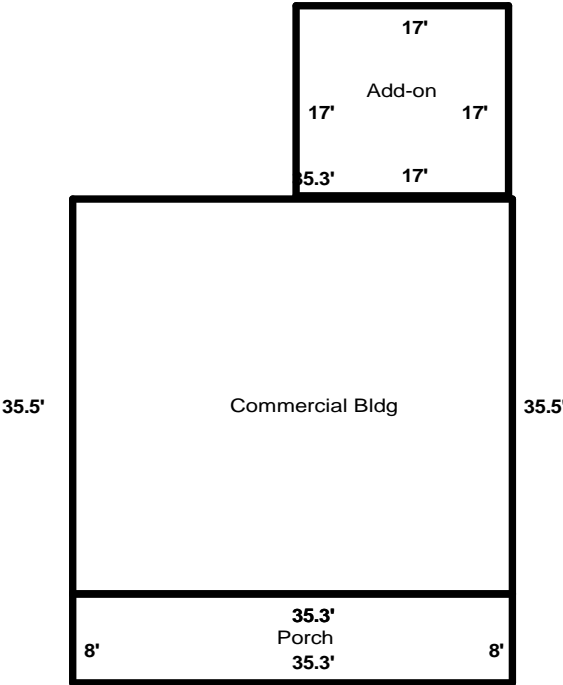

SUMMARY	SQ FT AREA	PERIMETER	AREA CALCULATION DETAILS			
Porch			Add on			
Cov Porch	282	87	17.0 X 17.0 =	289.0		
Building Area			Commercial			
Add on	289	68	35.3 X 35.5 =	1253.1		
Commercial	1253	142				



R42358

R27278

R27284

R0

R27275

R27274

N RAILROAD ST

W TEXAS ST

SUBJECT

