

Land For Sale
Midway South Tract (#7133)

+/-80 Acres

SE1/4 of NE1/4, NE1/4 of SE1/4, Sec. 29, T10S, R25W
Hempstead County, Arkansas

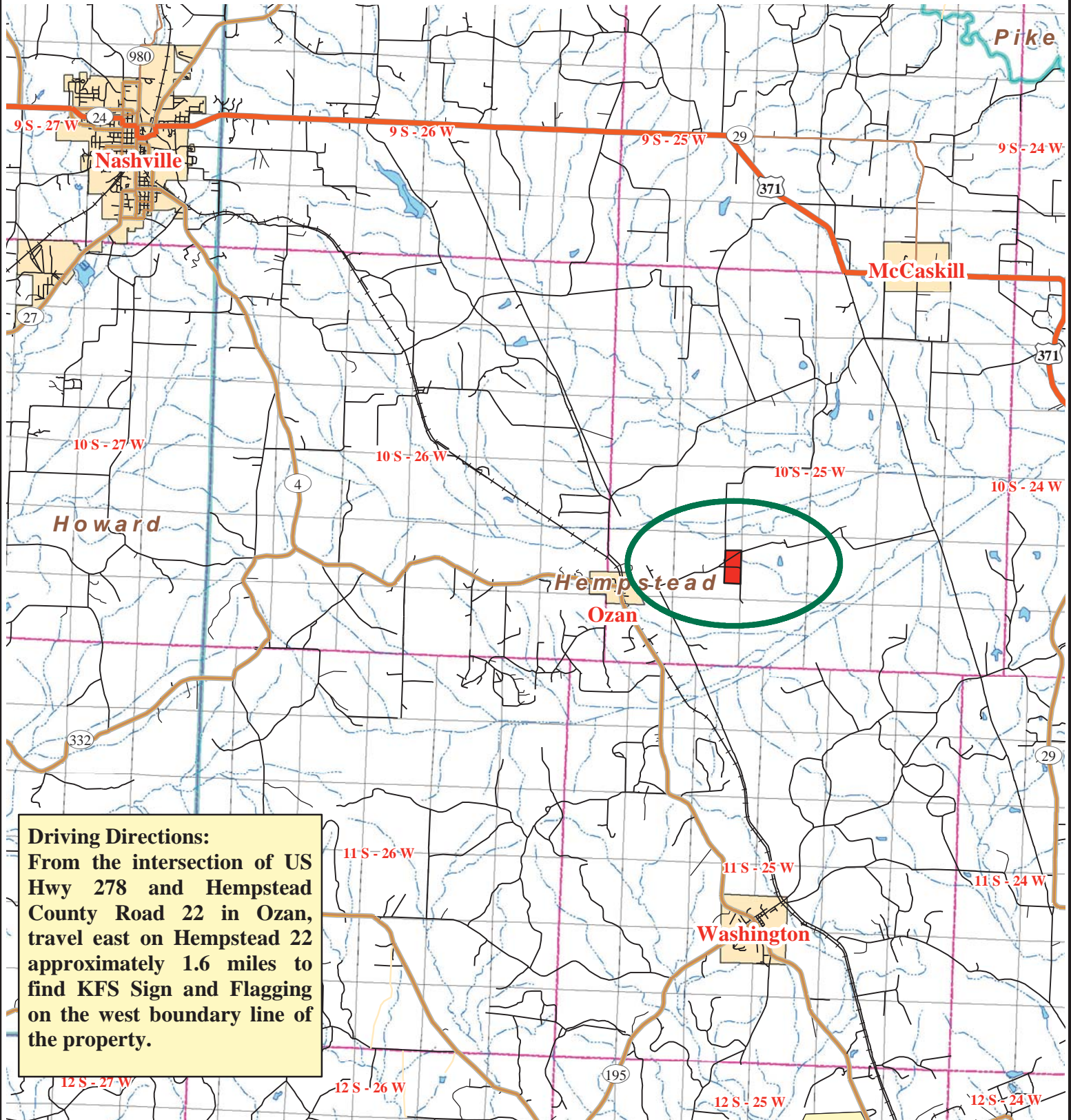

Driving Directions:

From the intersection of US Hwy 278 and Hempstead County Road 22 in Ozan, travel east on Hempstead 22 approximately 1.6 miles to find KFS Sign and Flagging on the west boundary line of the property.

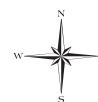
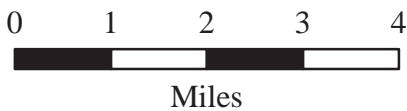

StreetMap USA
Created: April 2013
Printed By: RDH