

# Soils Map-CSR(as of 1/21/12)

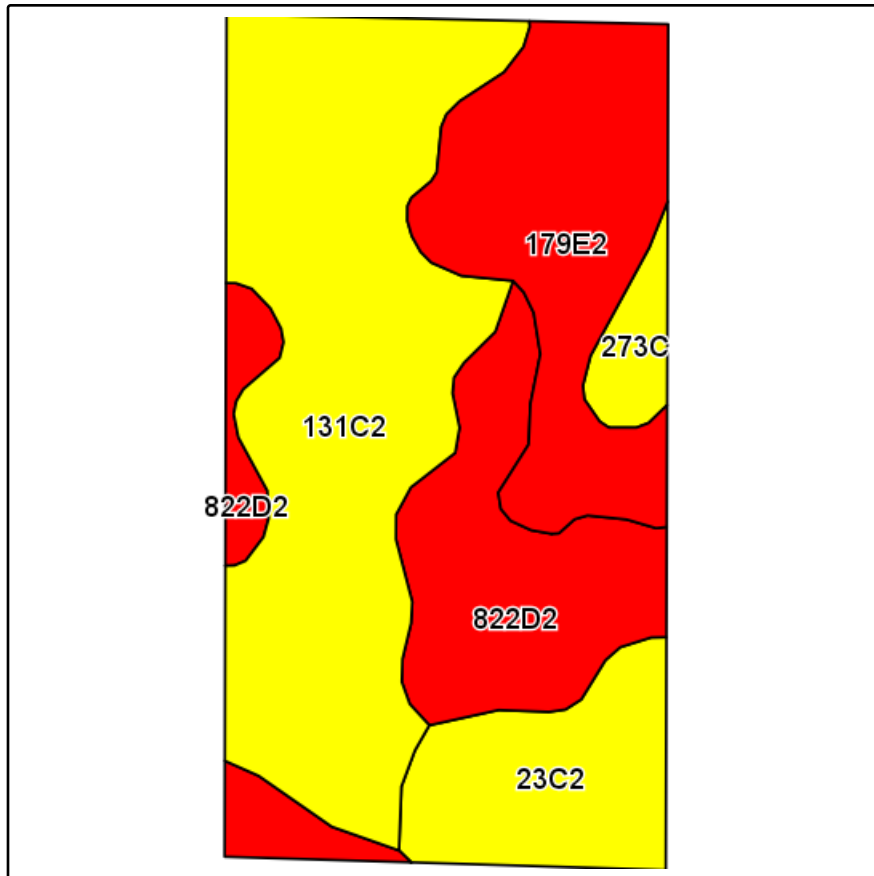

Field borders provided by Farm Service Agency as of 5/21/2008.  
Soils data provided by USDA and NRCS.

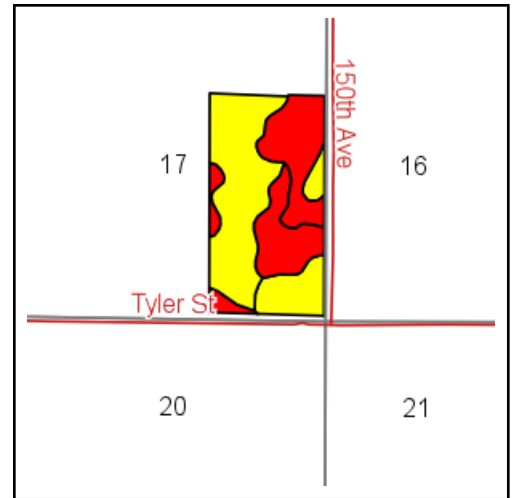

State: **Iowa**  
County: **Warren**  
Location: **17-74N-23W**  
Township: **Liberty**  
Acres: **19.4**  
Date: **12/5/2012**



Maps provided by:

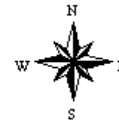

©AgriData, Inc 2012  
www.AgriDataInc.com

Code	Soil Description	Acres	Percent of field	CSR Legend	Non-Irr Class	CSR*
131C2	Pershing silt loam, 5 to 9 percent slopes, moderately eroded	8.3	42.8%		IIIe	50
179E2	Gara loam, 14 to 18 percent slopes, moderately eroded	4.1	21.2%		VIe	33
822D2	Lamoni silty clay loam, 9 to 14 percent slopes, moderately eroded	4.1	21.1%		IVe	15
23C2	Arispe silty clay loam, 5 to 9 percent slopes, moderately eroded	2.3	11.9%		IIIe	62
273C	Olmitz loam, 5 to 9 percent slopes	0.6	2.9%		IIIe	57
<b>Weighted Average</b>						<b>40.6</b>

Note: ALL soils information on this page is dated 1/21/2012

\*CSR ratings will be available for a limited time to aid in the transition to CSR2.